

Sec. 12 NE Cor.

Twp. Waterloo

3-14-38

Sec. 12 Twp. 89 Range 13

N.E. Corner

Sec 1

Sec 6

Found I. rod 1X24"
on road N intersection
established by Co. Engr.
set C.M. 12" deep

Fe. cor. post

Fe. cor. post

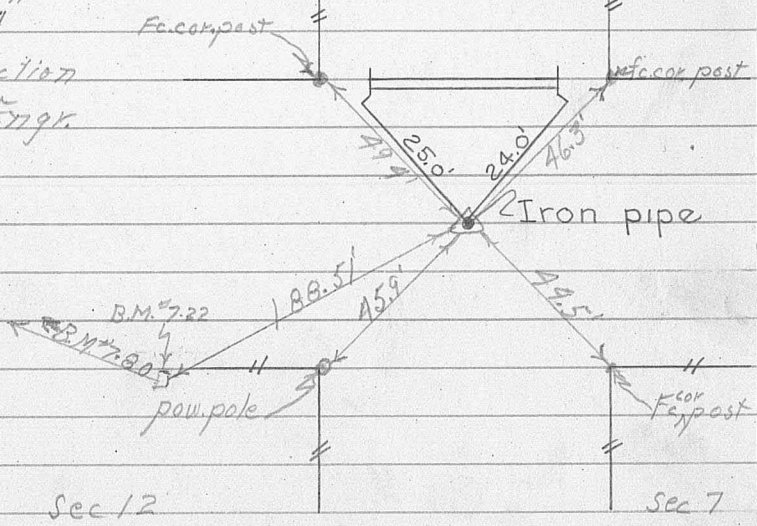
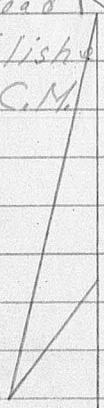

Sec 12

Sec 7