

ESTABLISHMENT RECORD

Road ~~North~~ West of Section
Road No. 103
Recorded Road Calendar
Book 1 Page 217
Established width 66 feet
Pages 163-165-167-173-205-213-217-263

Road East
Road No.
Recorded
Book Page
Established width

Road through section
Road No. 111
Recorded Road Calendar
Book 1 Page 302 - 284
Established width 66 feet

CONSTRUCTION RECORD

| ITEM | YEAR | QUANTITIES |
|-----------|------|------------|
| Grading | | |
| Surfacing | | |
| | | |
| | | |
| | | |
| | | |
| | | |
| | | |
| | | |
| | | |

| ITEM | YEAR | QUANTITIES |
|-----------|------|------------|
| Grading | | |
| Surfacing | | |
| | | |
| | | |
| | | |
| | | |
| | | |
| | | |
| | | |
| | | |

| ITEM | YEAR | QUANTITIES |
|--------------|------|------------|
| Grading 1966 | | |
| Surfacing | | |
| | | |
| | | |
| | | |
| | | |
| | | |
| | | |
| | | |
| | | |

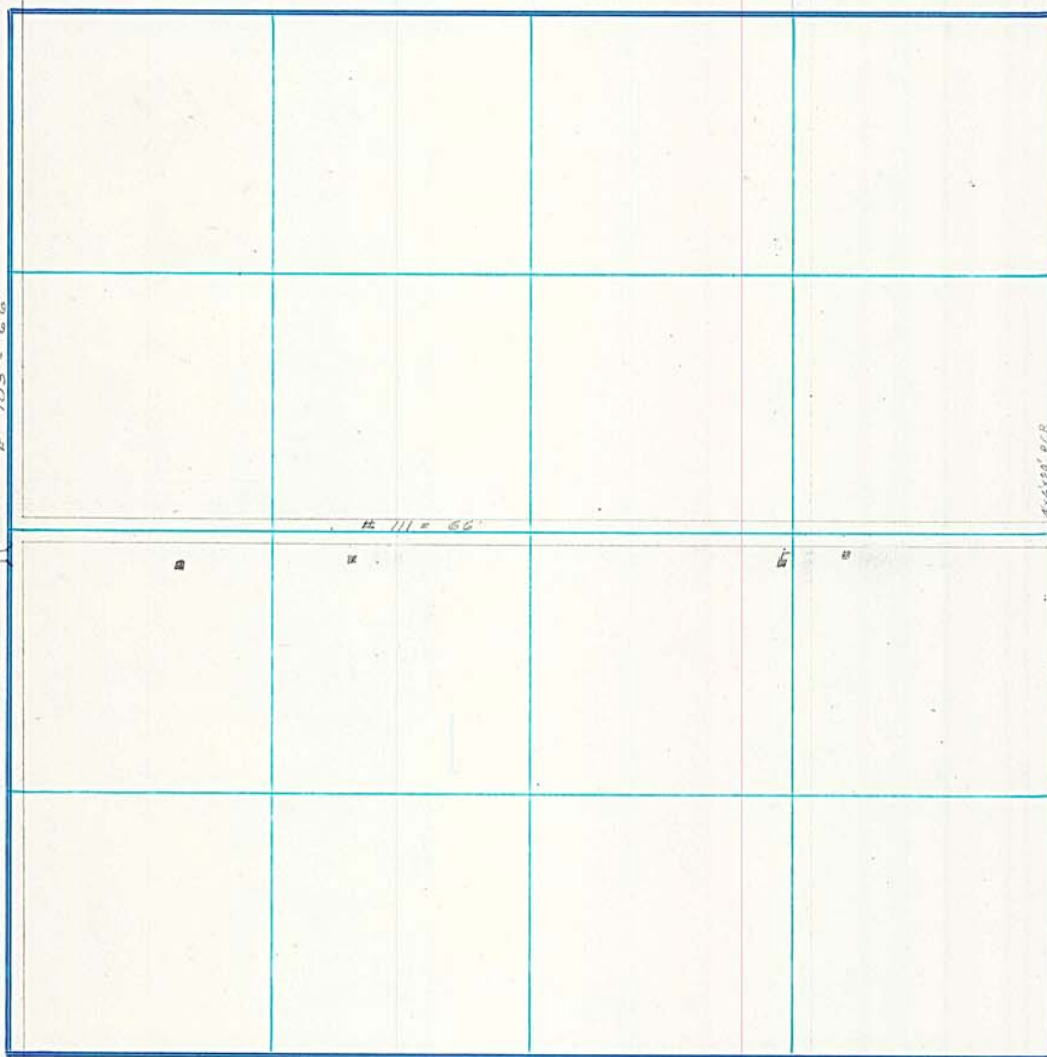

BRIDGE RECORD

Bridge 11360-0.52 M. S NW COR
Size 14' x 16'
Spans 1
Floor wood
Stringers 1A
Abut. ENTRANCE
Piers
Year built
Drainage area
Highwater

Bridge
Size
Spans
Floor
Stringers
Abut.
Piers
Year built
Drainage area
Highwater

Bridge
Size
Spans
Floor
Stringers
Abut.
Piers
Year built
Drainage area
Highwater