

455

Change in Sackett  
Road in Union Twp.

STATE OF IOWA, } SS:  
BLACKHAWK COUNTY, }

To *A. C. Webster*

You are hereby notified that you have been appointed a Commissioner to view, and if expedient to *Orange* county road as petitioned by *R. D. Chubbuck* and others, and to be called the *Heckst*

Road, described as follows:

~~Commencing at the~~ *Changing steel beam from the line where it meets Grand-dweller's section No 712 & 1012 (S 18) and S 18 (S 18) in Township of No. 10, Range (20) North of Orange No. 10 Township (24) West of the 3rd Meridian do as to corner within North or South line around the large stump on said section line*

You will, therefore, appear before some officer authorized to administer oaths in and for said county, and qualify according to law; and on the *23<sup>rd</sup>* day of *March* 1879, you will proceed to commence the examination of the route above described, and if, in your judgment, the above road is needed, or one in the vicinity answering the same purpose, you will call to your assistance the necessary aid, and proceed to lay out and mark the same according to law and the following instructions, and report to the Board on or before the *24<sup>th</sup>* day of *April* 1879.

1. In your survey of this road you will particularly describe the point of commencement, with reference to some monument or point, which will be generally found to consist of corners in the public and private surveys; the exact course and distance from some one of which you must set up in your field notes.
2. The point at which you terminate your survey must be ascertained and returned by reference to the same evidence as in your field notes.
3. All letters and figures inscribed upon wood, must be cut with a "marking iron," similar to that used in the Government survey of lands. Where bearing trees are taken, (and it is strongly enjoined that if within ten chains of an angle they should without fail be taken,) a smooth face fronting the angle of the road, should be made as near the ground as practicable, and in this face should be cut the initial letters of the points of beginning and ending of the road. For example—a road from Delhi to Colony—D. & C. R. When bearing trees cannot be had at angles, it is recommended the bearing and distance to a building, office, or corner of an enclosure be taken, and where this is impracticable, a large mound of earth should be raised at the point of the angle.
3. Marks in timber will consist of a smooth "blaze," with a notch in the centre, except the trees with the line cuts, each of which must have three notches, both upon the side which the line strikes, and that upon which it leaves such trees. All posts must be set up at every mile, and the distance marked thereon.—Stakes must be set at the crossing of fences and streams, and at intervals not exceeding one-fourth of a mile each.
6. After completing your survey of this road, you must carefully protect the same upon paper, with a view to the detection of all errors, either in your chaining or course.
7. These instructions in no way relieve you from each and every duty prescribed by the laws of Iowa Revision of 1860, pages 134 and 135.
8. All your assistants are required to be sworn by some person authorized to administer oaths.

Given under my hand and official seal this *17<sup>th</sup>* day of *March* 1879.

*David M. Foster*  
County Auditor.

THE STATE OF IOWA, } SS:  
BLACKHAWK COUNTY, }

I do solemnly swear that I will, to the best of my ability, perform the duties of Commissioner on the within road, according to law and the foregoing instructions.

Subscribed and sworn to before me, this *20<sup>th</sup>* day of *March* 1879.

*Levi M. Smith*  
Justice of the Peace



West 5th P. M.

14 Rng.

90 Twp.

8 Sec.

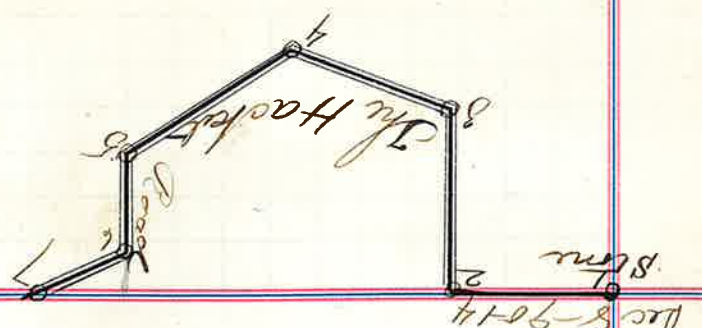

at 2. Water & 9 N 18° 37' 1/2  
Dr Oak 18 N 44 1/2 W 105  
1. 2. 3. 4. 5. 6. 7. 8. 9. 10. 11. 12. 13. 14. 15. 16. 17. 18. 19. 20. 21. 22. 23. 24. 25. 26. 27. 28. 29. 30. 31. 32. 33. 34. 35. 36. 37. 38. 39. 40. 41. 42. 43. 44. 45. 46. 47. 48. 49. 50. 51. 52. 53. 54. 55. 56. 57. 58. 59. 60. 61. 62. 63. 64. 65. 66. 67. 68. 69. 70. 71. 72. 73. 74. 75. 76. 77. 78. 79. 80. 81. 82. 83. 84. 85. 86. 87. 88. 89. 90. 91. 92. 93. 94. 95. 96. 97. 98. 99. 100.

Witness trees  
at 2 Water Elm 9 N 18° E 7 1/2  
Br Oak 18 N 44 1/2° W 105  
" 7 ash 4 N 56° W 99  
" 6 N 20 1/2° W 112 1/2

The Hacket Road commences at the N.W. cor. of sec. 8-20-14  
1. thence East 6,50 ch. 2 South 7,93 ch 3 S 70° E 7,24 ch. 4 N 59° 35' E 8,67 ch.  
5 North on East line of West 80 of N W 4 sec 8-20-14 4,39 ch. 6 N 68° E 4,42 ch.  
to the North line of sec. 8-20-19 Variation 9° East

I hereby certify, that the above plat is correct and in accordance with survey made by me, this 27<sup>th</sup> day of  
March A. D. 1879 Edwin Rodenberger County Surveyor.

Know all Men by these Presents, That \_\_\_\_\_ Fee \$8.00  
of Blackhawk County, State of Iowa, being the owners of \_\_\_\_\_ real estate described in above plat, do  
hereby acknowledge that the survey and plat as above described was made in accordance with \_\_\_\_\_ de-  
sire, and by \_\_\_\_\_ request and \_\_\_\_\_ do hereby approve the same.

SIGNED this \_\_\_\_\_ day of \_\_\_\_\_ A. D. 1872.  
In Presence of \_\_\_\_\_

State of Iowa, Blackhawk County, ss:

On this \_\_\_\_\_ day of \_\_\_\_\_ A. D. 187 before me  
and for said County, personally came \_\_\_\_\_  
to me personally known to be the identical person whose name \_\_\_\_\_  
affixed to the above instrument and acknowledged the same to be their voluntary act and deed.  
Witness my hand and \_\_\_\_\_ the date last above written.



STATE OF IOWA, }  
BLACKHAWK COUNTY, } SS:

To the Honorable Board of Supervisors of said County:

The undersigned, having been appointed a Commissioner to view, and, if thought necessary, to change a certain Road in said County at petitioned for by

J. B. Sturtevant and others, and known as the Hawthorn

Road, would report as follows:

That, having been duly sworn, he found, upon examination, that it was

Spaded & mended

for the accommodation of the public, that the road should be changed  
as petitioned for. & advised by the plat of said change hereto  
attached & made a part of this report  
Therefore with the assistance of Edmundson as surveyor

as chairman,

~~as~~ as ~~committee, who were all duly sworn,~~ your Commissioner proceeded on the day set therefor, to-wit: the 25<sup>th</sup> day of March

A. D. 1879, to lay out and locate said Road, and to distinguish the same by the proper marks, mounds and stakes, in the manner prescribed by law, and in accordance with the Field Notes and Plat of Survey of the Road, which are herunto annexed, and which are made part of this report.

Your Commissioner is of the opinion, that the ~~road~~ <sup>change</sup> will be of benefit  
& utility

to the public, and would hereby

recommend its

change  
All of which is respectfully submitted.

Commissioner.

The following Fees should be paid by the Petitioner for the Road:

|                    |               |                  |                |
|--------------------|---------------|------------------|----------------|
| Fees Commissioner, | <u>2</u> days | Mileage <u>8</u> | \$ <u>4.80</u> |
| " Surveyor,        | "             | "                | \$             |
| " Chainmen,        | "             | "                | \$             |
| "                  | "             | "                | \$             |



To the Board of Supervisors of Black-  
hawk County - State of Iowa -

The undersigned respectfully represents  
that the changing of the County road  
on highway in Union Township in  
said Blackhawk County known  
as the Hookett Road when the same  
crosses the West Half of the West  
West Quarter of Section Eighth (8) in  
Township thirty (30) North Range  
fourteen (14) East of the 5<sup>th</sup> of W.  
as proposed and for which a petition  
has been filed will damage him  
in the sum of <sup>as owner of said land</sup> One thousand  
Dollars - (said proposed change  
being as follows to wit. Commencing  
at the West West Corner of said Sec. 8  
thence S. 63° E. 8.723 chs. S. 70° E. 7.24 chs  
N 59° 35' E. 8.21 chs to E line of W 1/2 of NW 1/4 of  
said Sec. 8. N 43° E. 468° E 14.42 chs to

W line of said Sec. 8.)

Wherefore he prays that three suitable  
& distinct <sup>said</sup> sections of the County may be  
appointed to assess the damages  
that he will sustain thereby. Dated

May 9<sup>th</sup> 1879.

John H. Sharp

claimant

Witness  
No. 10, 10th May