

Harmon Road



To the Hon Board of Supervisors  
of Black Hawk County Iowa

The undersigned  
Citizens of Spring Lake Township  
in said County & State respectfully  
remonstrate against the location of  
a highway along the following proposed  
route to wit commencing at the South  
East corner of Section 20 Township 89  
Range 11 West of 5<sup>th</sup> R<sup>th</sup> Merice South  
89 degree N 1 chain North 40 degree  
N 8<sup>1</sup>/<sub>2</sub> chains N 45 degree N 26<sup>3</sup>/<sub>4</sub>  
chains N 22<sup>1</sup>/<sub>2</sub> degree N 5<sup>5</sup>/<sub>8</sub> chains  
N 45 degree N 2<sup>3</sup>/<sub>4</sub> chains N 61<sup>1</sup>/<sub>2</sub>  
degree N 8<sup>3</sup>/<sub>4</sub> chains N 1 degree S  
28<sup>1</sup>/<sub>4</sub> chains N 88<sup>3</sup>/<sub>4</sub> degree N 19<sup>2</sup>/<sub>3</sub>  
chains N 72<sup>1</sup>/<sub>2</sub> degree N 3<sup>6</sup>/<sub>8</sub> chains  
S 80<sup>1</sup>/<sub>2</sub> degree N 17<sup>4</sup>/<sub>8</sub> chains S 46<sup>1</sup>/<sub>4</sub>  
degree N 55<sup>3</sup>/<sub>8</sub> chains N 78 degree  
N 2<sup>3</sup>/<sub>4</sub> chains to Cedar River Bridge

The said proposed highway not  
being on a Section line or on any  
line bounding any of the legal subdivisions  
of a Section, that said route is impracticable  
& will be an expensive burden  
to the taxpayers of said Spring  
Lake Township, that there are other  
& more practicable & less expensive  
routes from the starting point of  
said proposed road to said bridge  
thence



Names

B. A. Chaffin  
George Rogers  
Richard Hunter  
E. Williams  
Mr. Bartlett  
Andrew and Patten  
Miss Mudgett  
J. and Bailey  
J. W. Murphy  
O. Bailey  
A. P. Bailey  
W. W. Sprague  
W. D. Bingham  
John Arnold  
W. R. Burdick  
H. L. Skinner  
B. Chas. Smith  
L. Burdick  
H. A. Burdick  
R. T. Taylor  
Shelby Taylor  
Leah & Correll  
C. J. McPherson  
I. Brown  
D. L. May  
Jacob Mayes  
W. W. Kenner  
D. St. Barnes  
J. C. Henshaw  
John Rice  
Simon Wells  
E. Green  
S. L. Fiske

Names

James H. Burdick  
John Henshaw  
John Richardson  
James Henshaw  
37 names



STATE OF IOWA, } SS:  
BLACKHAWK COUNTY, }

TO

John Weaver

You are hereby notified that you have been appointed a Commissioner to view, and if expedient to locate county road petitioned by David

Hammon and others, and to be called the Hammon

Road, described as follows:

Commencing at the South East corner of Section 36 Twenty  
in Township 36 Eightyseven Range 36 Eleven,  
thence North Westward — on the most suitable ground — to the  
Center of said Section 36 Twenty, thence North Eighty  
two, thence West on the most suitable ground to  
the West line of said Section 36 Twenty, thence  
in a straight line to the Cedar River Bridge, at  
the Spring Creek Township,

You will, therefore, appear before some officer authorized to administer oaths in and for said county, and qualify according to law; and on the 28<sup>th</sup> day of Oct<sup>r</sup>, 1878, you will proceed to commence the examination of the route above described, and if, in your judgment, the above road is needed, or one in the vicinity answering the same purpose, you will call to your assistance the necessary aid, and proceed to lay out and mark the same according to law and the following instructions, and report to the Board on or before the 27<sup>th</sup> day of November 1878.

1. In your survey of this road you will particularly describe the point of commencement, with reference to some monument record, which will be generally found to consist of corners in the public and private surveys; the exact course and distance from some one of which you must give in your field notes.
2. The point at which you terminate your survey must be ascertained and returned by reference to the same evidence as is herein required for the commencing point.
3. All letters and figures inscribed upon wood, must be cut with a "marking iron," similar to that used in the Government survey of lands. Where bearing trees are taken, (and it is strongly enjoined that it within ten chains of an angle, they should without fail be taken,) a smooth face fronting the angle of the road, should be made as near the ground as practicable, and in this face should be cut the initial letters of the points of beginning and ending of the road. For example:—a road from Delhi to Colony—D. & C. R. When bearing trees cannot be had at angles, it is recommended the bearing and distance to a boulder, edifice, or corner of an enclosure be taken, and where this is impracticable, a large mound of earth should be raised at the point of the angle.
5. Marks in timber will consist of a smooth "blaze," with a notch in the centre, except the trees with the line cuts, each of which must have three notches, both upon the side which the line strikes, and that upon which it leaves such trees. All posts must be set up at every mile, and the distance marked thereon.—Stakes must be set at the crossing of fences and streams, and at intervals in the prairie not exceeding one-fourth of a mile each.
6. After completing your survey of this road, you must carefully protect the same upon paper, with a view to the detection of all errors, either in your chaining or course.
7. These instructions in no way relieve you from each and every duty prescribed by the laws of Iowa Revision of 1860, pages 134 and 135.
8. All your assistants are required to be sworn by some person authorized to administer oaths.

Given under my hand and official seal this 23<sup>rd</sup> day of Oct<sup>r</sup> 1878.

Frank M. Foster

County Auditor.

THE STATE OF IOWA, } SS:  
BLACKHAWK COUNTY, }

I do solemnly swear that I will, to the best of my ability, perform the duties of Commissioner on the within road, according to law and the foregoing instructions.

Subscribed and sworn to before me, this

28<sup>th</sup> day of Oct<sup>r</sup> 1878.

John Weaver

Clerk of the Court  
Notary Public  
Sealed



STATE OF IOWA, }  
BLACKHAWK COUNTY, } SS:

To the Honorable Board of Supervisors of said County:

The undersigned, having been appointed a Commissioner to view, and, if thought necessary, to lay out a certain Road in said County petitioned for by Herman Ahmann and others, and known as the Ahmann Road, would report as follows:

That, having been duly sworn, he found, upon examination, that it was for the accommodation of the public, that the road should be laid out as petitioned for.

Therefore with the assistance of Ed. J. Johnston as surveyor and Geo. Melzger Smith as chainmen, axmen, who were all duly sworn, your Commissioner proceeded on the day settherefor, to-wit: the 28<sup>th</sup> day of Oct A. D. 1878, to lay out and locate said Road, and to distinguish the same by the proper marks, mounds and stakes, in the manner prescribed by law, and in accordance with the Field Notes and Plat of Survey of the Road, which are herunto annexed, and which are made part of this report.

Your Commissioner is of the opinion, that the road will be of great advantage to the public, and would hereby recommend its establishment to the public, and would hereby recommend its establishment All of which is respectfully submitted.

John Treavor  
Commissioner.

The following Fees should be paid by the Petitioner for the Road:

Fees Commissioner,	<u>3 1/2</u>	days	Mileage	\$ <u>7.00</u>
" Surveyor,	<u>4</u>	"	"	\$ <u>16.00</u>
" Chainmen,	<u>3</u>	"	"	\$ <u>4.50</u>
"	<u>3</u>	"	"	\$ <u>4.50</u>



*Sketch of Survey of the Chamorro  
Road in Section 19 & 20. Sp. 8 for R 11 W. Spring Creek  
Township, Black Hawk County Iowa.*

October 28 - 31<sup>st</sup> inclusive 1878, duration of transit  $47^{\circ} 47' E$ .

Commencing at the S.E. cor of Sec 20. (shown)

Sta 1 Thence  $S 89^{\circ} W$ , 1 chain to angle & stake from which.

White Oak 20 in dia base  $DR 82^{\circ} W$ , 90 lbs dist.

Cherry 8 " "  $DR 33 W$ ,  $5\frac{1}{2}$  " "

Oak 6 " "  $S. 64 E$ , 19 " "

Thence  $DR 40^{\circ} W$ ,  $8^{\circ} 10'$  ch, ( $9^{\circ} 10'$  from pt of base) to angle from which

Basswood 10 in dia base  $S 86^{\circ} W$ , 73 lbs dist.

" 8 " "  $DR 45 E$ , 80 " "

" 12 " "  $S. 70 E$ , 83 " "

This angle is made at  $DR W$ . side of marked Basswood  
tree 8 in dia, which is closely surrounded by other trees.

Thence  $DR 45^{\circ} W$ , 26  $\pm 30$  ch, ( $35^{\pm 40}$  from pt of base) to angle from which

then being no bearing tree a mound is made about angle & stake.

$DR 19^{\pm 25}$  from Pt 3 (Sta 3) or  $28^{\pm 45}$  ch from pt of base

Sta 4 -  $DR W$  on side of  $S 8^{\circ} 14'$  of Dec 20, is found in the line.

$DR 20$  from Sta 3. Stake now driven in line & marked,

Thence  $DR 22\frac{1}{2}^{\circ} W$ ,  $5^{\circ} 35'$  ch ( $41^{\pm 25}$  ch from pt of base) to angle & stake from which

Oak 4 in dia base  $S 80\frac{1}{2}^{\circ} E$ ,  $37\frac{1}{2}$  lbs dist.

Basswood 4 " "  $S. 28^{\circ} E$ , 63 " "

Cherry 5 " "  $S 82\frac{1}{2} W$ , 75 " "

Oak 3 " "  $S 61\frac{1}{2} E$ , 8 " "

Sta 7 Thence  $DR 45^{\circ} W$ ,  $7^{\circ} 30'$  ch ( $48^{\pm 25}$  ch from pt of base) to angle & stake from which

Oak 6 in dia base  $S 26\frac{1}{2} E$ , 52 lbs dist.

" 10 " "  $DR 62 E$ , 30 " "

Basswood 7 " "  $DR 2 W$ ,  $31\frac{1}{2}$  " "

$DR 120$  ch ( $50^{\pm 25}$  ch from pt of base) Correl small branch.

Thence  $DR 61\frac{1}{2} W$ ,  $8^{\circ} 20'$  ch ( $57^{\pm 25}$  ch from pt of base) to angle & stake  
from which (This pt is supposed to be the angle of Dec 20)



Cake 6 in dia base OR 34 1/2 E. 77 1/2 N. S. dit.

" 14 " " OR 85 W. 87 " "

" 10 " " OR 31 1/2 W. 93 1/2 " "

" 16 " " S 38 1/2 W. 101 1/2 " "

Sta 9

Thence OR 1° E. 20. 2° Ch (77 3/4 Ch from pt of Conn.) to angle & State  
from which — (this pt. is S W cor. of E. W. 1/4 of Sec. 20)

Red Lake 6 in dia base OR 87 W. 43 1/2 N. S. dit.

" 8 " " OR 31 1/2 W. 43 " "

" 5 " " S 12 E. 28 1/2 " "

Iron Lake 6 " S 84 1/2 E. 24 1/2 " "

(This line follows the middle of a little head moraine.

running from East side of section 20. to the State and platte.)

Sta 10

Thence OR 88 1/4 W. 19 2° Ch (96 60 Ch from pt. of Conn.) to State & angle  
from which — (from a little tract to arid low ground)

Red Lake 14 in dia base OR 18 1/2 W. 92 1/2 N. S. dit.

Sta 11

Thence OR 72 1/2 W. 3 60 Ch. (150. 2° Ch from pt of Conn.) to angle & State  
from which — (made this angle toward pt. of Conn.)

Round Tree 4 in dia base OR 79 W. 54 1/2 N. S. dit.

Cake State 2 1/2 " S 15 W. 25 " " (draw for marking

Sta 12

Thence S 80 1/2 W. 17 2° Ch (117 2° Ch from pt of Conn.) to State & angle  
from which — (This State is on north <sup>line</sup> side of Sec. 20, 1 2° Ch

South of 14 1/4 cor. or 84 N. 24 1/2 S. South of E. W. cor. Sec 20)

Mellons 9 in dia base OR 78 1/2 W. 20 1/2 N. S. dit.

" 9 " " S 23 W. 24 1/2 " "

Sta 13

Thence S 46 1/4 W. 35 2° Ch (173 3/4 Ch from pt of Conn.) to angle & State  
from which —

Cottamores 18 in dia base S 28 W. 108 N. S. dit.

Cake 7 " S 68 E. 56 1/2 " "

Sta 14

Thence OR 78 W. 2 2° Ch (175 2° Ch from pt of Conn.) on line of  
center line of Cedar River Bridge in Sec 19. Spring Creek 79.

to the center of Bridge at East ends of lower chert and away  
between said ends of lower chert.

This being the 1st of completion of above survey.



Cedar River

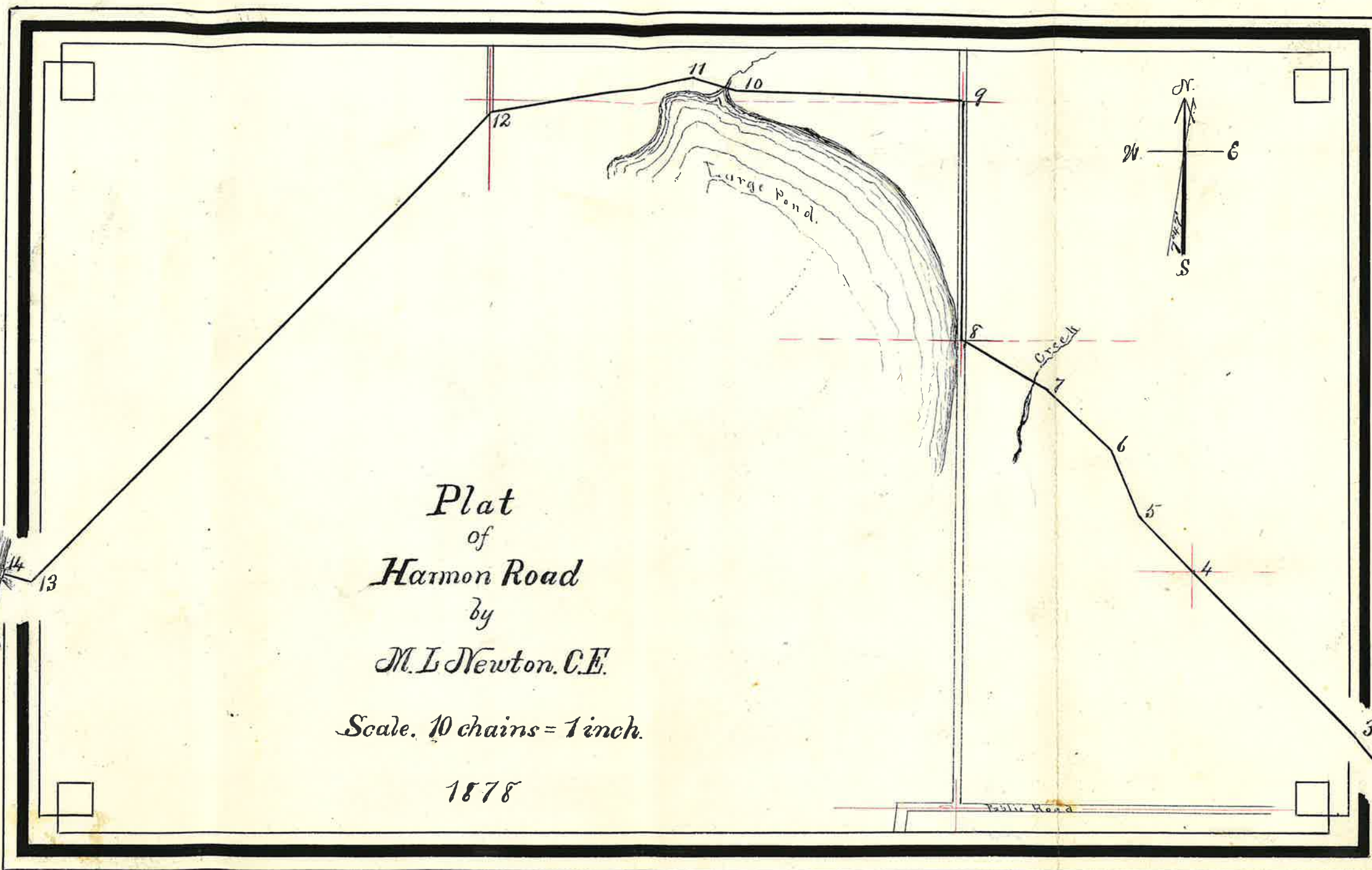



I hereby certify that the above filed  
notes are true and correct as relating to the  
Survey of the above named Hannu Head  
and I also verily believe

M. L. Newton A.E.

Salt Lake City, Iowa

December 9<sup>th</sup> 1878



To the Hon Board of Superintendents of  
Beckwith's Locality near

The undersigned

M. R. Van Dusen, respectfully refers  
-reets that he is the owner of the  
West Ten acres of the East twenty five  
125 acres of Lot 2 in Section thirteen  
Township Eighty Sixteen Range 11  
North of the 5<sup>th</sup> 4<sup>th</sup> 11<sup>th</sup> in Beckwith's North  
Locality near.

That a road has  
been petitioned for by one  
Herman Stal seemingly and  
said premises and of the width  
of 60 feet. That said road is  
surveyed & run diagonally  
across said premises, that  
abandoned said road be established  
kindred & located as surveyed  
it need clearness said prem-  
ises in the name of twenty  
five acres.

Therefore when petition  
asked that should be  
than only establish said road,  
that it should be upon sec-  
tion that when petition  
be settled beance in  
the said name of twenty five



declares that said seal be  
established. if at all, upon  
the condition of the permanent  
abolition of said seal

Salutary 24<sup>th</sup>  
Wm. Paul Smith  
R. M. W. Weston  
his atty

Received of  
Messrs Paul Smith  
R. M. W. Weston  
the sum of \$100.00  
for the seal of the  
County of  
New York  
this 24<sup>th</sup> day of  
February 1879  
J. M. Smith  
J. M. Weston



To the Hon Board of Supervisors  
of Noble County, Kentucky, I have

The undersigned,

Reuben + Chapman, respectfully  
request that they are the  
owners of the South East quarter  
of the South East quarter of Sec-  
tion 14<sup>th</sup> Twenty (20) in Township  
14<sup>th</sup> North Seven (87) East of Range  
10<sup>th</sup> Eleven (11) West of the 5<sup>th</sup> P.M.

That a Road has been petitioned  
for & surveyed across said sec-  
-tion and of the width of 60 feet  
That said road is surveyed  
to run diagonally across said  
premises, That I should said  
road be located & established  
as surveyed, it will cause  
said premises in the sum  
of <sup>Two hundred fifty</sup> Dollars  
Therefore petitioners ask  
that should their honorable  
body establish said road  
that it should be upon  
condition that their  
petitioners be entitled to  
damages in the said sum  
of <sup>Two hundred fifty</sup> Dollars  
That said road be es-



tablinked upon the cancellation  
of the payment & petition  
of said man

Native Decmbr 28<sup>th</sup> 1878

Williston

Atty for Petition

State of Texas }  
Black Hawk County }

J B. Chapin

being duly sworn as on oath  
say that I am one of the Peti-  
tioners named above; that  
I have read and the foregoing  
petition that the statement  
therein made are true as I  
truly believe  
I am to depose and J B. Chapin  
by J B. Chapin the true  
subscribed in my  
presence this 27<sup>th</sup> day  
of January A.D. 1879 }

J. C. Miller

Notary Public



To the Hon Board of Supervisors  
of Black Hawk County Iowa  
He undersigned Thomas Williams  
respectfully represents that he is the  
owner of the West half of the 4th Ward  
of Section 20 Township 5<sup>th</sup> Range 11  
West 8<sup>th</sup> Q.M. That a Road has been  
petitioned for & surveyed across said  
premises, and of the width of 60 feet  
that all of the same is on the premises  
described, that should said road be  
located as surveyed, it will damage  
said premises in the sum of four  
hundred dollars

Wherefore petitioner asks that should  
your Honorable body declare said  
road to be established that you will  
appear to said declaration the  
further sum "that petitioner Thomas  
Williams be adjudged to be damaged  
in said sum of four hundred dollars  
by reason of the location of said  
road as surveyed."

Dated December 1<sup>st</sup> 1878

Witness my hand  
Attest for Petitioner

State of Iowa  
Black Hawk County I do Thomas Williams  
being duly sworn depose that he is the petitioner  
named above that he has heard the foregoing  
petition and that the statements therein  
are true as he verily believes of William  
Drew to before me this 1<sup>st</sup> day of December 1878.  
C. A. Dyer, Clerk, Quire, Quire.



To the Honorable Board of Education  
of Black Hawk County Iowa

The undersigned citizens of  
precinct of Spring Creek township  
Black Hawk County. Hereto respectfully  
by memorial against the passage  
and of the proposed road petition  
for the Shurtzoff farm and other  
petitions were filed with  
those of the court - recd. the  
25<sup>th</sup> day of May 1898 which petition  
asks that road may be established -  
located on or as near as possible  
to the following described route:  
Start commencing at the ~~corner~~  
~~west~~ corner of the north west of  
the north Edg Section 20. down  
87 Range 11. thence running  
west one half mile to the south  
east corner of the S. E. of N. E.  
of Sec. 19 down 87 Range 11.

J. A. Spruce

J. A. Spruce

Wm. W. W.

W. H. W.

Wm. W. W.

Wm. W. W.



L. D. Morris

John Knicker

Barrett Campbell

Robert Campbell

Leahurst & Co

John McElhannan

John Hamilton

John Hamilton

John Hamilton

John Hamilton

John Hamilton

John Hamilton

John Hamilton

John Hamilton

John Hamilton

John Hamilton

John Hamilton

John Hamilton

John Hamilton

John Hamilton

John Hamilton

John Hamilton

John Hamilton

John Hamilton

John Hamilton

John Hamilton

John Hamilton

John Hamilton

John Hamilton

John Hamilton

John Hamilton

John Hamilton

John Hamilton

John Hamilton

John Hamilton

John Hamilton

John Hamilton

John Hamilton

John Hamilton

John Hamilton

John Hamilton

John Hamilton

John Hamilton

John Hamilton

John Hamilton

John Hamilton

John Hamilton



David L. 27  
W. Jackson

Samuel Miller

Henry Badell

W. B. Fogg

John Chapman

W. S. Loessing

Edmund Burke

W. H. C. C. C.

Philadelph. W. H. C.



STATE OF IOWA,  
BLACK HAWK COUNTY.

OFFICE OF COUNTY AUDITOR.

**KNOW ALL MEN BY THESE PRESENTS,**

That we David Harmon as Principal, and J. B. Yeeter & N. N. Harmon as Sureties, are held and firmly bound unto said County of Black Hawk in the penal sum of One Hundred Dollars, for the payment of which sum, well and truly to be made, we bind ourselves, our heirs, executors, administrators and legal representatives, firmly by these presents.

Now, the condition of the above obligation is such that,-- Whereas, David Harmon and others, have made application by petition to the Board of Supervisors of said County to Establish a highway to be known as the Harmon Road;

Now, if the said petitioners shall pay all the expenses growing out of said application, in case the said highway is not established, then this Bond to be void, otherwise to be and remain in full force and virtue.

Witness our hands this 12<sup>th</sup> day of June 1878

David Harmon

J. B. Yeeter & N. N. Harmon Sureties

The above Bond and security approved this 13<sup>th</sup> day of June 1878

D. M. Foster

County Auditor.



To the Hon Board of Supervisors  
of Black Hawk County, Iowa

The undersigned,

Peter Friday, respectfully represents  
that he is the owner of the north  
half (16) acres of the West half (141) of  
North West quarter (141) of the South  
East quarter (141) of Section 18<sup>20</sup>  
Twenty (20) in Township Eighty  
Seven (87) North of Range 14<sup>20</sup> East  
111) West of the 5<sup>th</sup> P.M. in said  
County of Black Hawk.

That a  
road has been authorized for  
by the Honorable State Surveyor  
and said premises and of the  
width of 60 feet. That said  
road is necessary to run along  
nearly a mile premises,  
that should said road be  
located and established as  
surveyed, it will damage said  
premises in the sum of twenty  
five dollars.

Wherefore I pray  
petitioner asks that should  
the Honorable Board establish  
said road, that it shall be  
upon condition that there



Petitioner be entitled to damages  
in the said sum of twenty  
five dollars that said award  
be established, if at all, upon  
the cancellation of the payment  
to Petitioner of said sum  
dated December 31<sup>st</sup> 1878.

Miller Weston

Atty for Petitioner

State of New York  
County of Hamilton

and Peter Friday  
being duly sworn do on oath  
say that I am ~~one~~ of the Petition-  
named above; that I have  
heard read the foregoing Peti-  
tion that the statements therein  
made are true as orally  
declared  
James Shepley one  
of Peter Friday's  
legitimate representatives  
in my presence this  
2<sup>nd</sup> day of January  
1879

Attest W<sup>m</sup> Shepley

J. C. Miller  
1879

Notary Public



<sup>M. A.</sup> Pungers	<sup>S. M.</sup> Chapin H	J. McConn H
✓ David Harmon		W. E. Williams
Al Kennedy H		✓ J. M. Bailey
✓ Peter W. Brisby		D. B. Fox H
<del>E. L. Wood</del>		✓ A. Sutherland
<del>M. Williams</del>		
✓ A. F. Ashley		
✓ M. Sawyer	or Dunlap	
✓ A. Williams		
<del>J. M. Brown</del>	not found	
✓ G. Taylor	Shelby Taylor & c	
Edison	E. A. Phillips	Frank Brown



M. Sawyer  
40 acres

23 @ Ashley

~~M. Williams~~  
20a

~~P. H. Fidy~~  
6a

A. C. Kennedy  
EAT  
12a

D. Hanson

~~Banyar + Chapin~~  
~~40 acres~~

500 20

80 acres  
A. McQuinn

Redon

1/2 cup corn  
12 1/2 c

E. A. Phelps  
3rd  
John M. Con

John McCann

Barber  
N. H. Barber

J. R. Bailey

Wickham

20132

5-20

W. B. Love

Lawrence Dec 1920



As the Governor has said of  
Cherokee is of the Cherokee County  
pleas - the undersigned petitions  
petitioners of Cherokee County  
**and others** interested in the road  
in said county and state aforesaid  
humbly sheweth -

Dear Mr. Brewster:

that general direction the for number  
good reason is as follows. The first  
of our ~~best~~ <sup>best</sup> road at St. Albans  
to lead <sup>generally</sup> from the South-East corner  
of Sutton (usually known as North corner)  
direction (on the British South Sea  
ground plan) to the center of  
Sail Bentin (County) where we shall  
finally reach - where we shall be the

and sent to the General to be put  
in one of said Section (Twenty) where  
direct to the American Bridge - all  
will show that England & our Range  
became head of the Pacific & the

David Hume

Shirley

Dr. J. M. Appleton

Mr. H. Matthews

Wm. Wadsworth  
Hamer

Thurs & Fridays  
to 1 pm after lunch

Mr Good

Peter. Thrush

John Good

W. A. Knicker

Wm. D. Harmon

Johann Hahn

Edw. Brown

Frank A Ballou

20 Jan 18

Richard Twiss

*S. J. Trenchard & Co*

Margaret Joseph

George Pratt

Wm Russell

394 Germania

Samuel Denney

20  
Hansant

St. Bartholomew

16 Dec

6. *Phyllis*

to the same

of death

25 pectus

1891

Leind Glossary

George A. A.

Andrew Clark

St Anne.

William Clark

Thassner



Margaret Sawyer

David Sawyer

W. B. Southland

W. B. Southland

John Sawyer

Andrew Clark

William Clark

George Clark

David Clark

John Clark

William Clark

George Clark

David Clark

John Clark

William Clark

George Clark

David Clark

John Clark

William Clark

George Clark

David Clark

John Clark

William Clark

George Clark

David Clark

John Clark

William Clark

George Clark

David Clark

John Clark

William Clark

George Clark

David Clark

John Clark

George Pratt

W. B. Southland

John Sawyer

Andrew Clark

William Clark

George Clark

David Clark

John Clark

William Clark

George Clark

David Clark

John Clark

William Clark

George Clark

David Clark

John Clark

William Clark

George Clark

David Clark

John Clark

William Clark

George Clark

David Clark

John Clark

William Clark

George Clark

David Clark

John Clark

William Clark

George Clark

David Clark

John Clark

William Clark

George Clark

David Clark

John Clark

William Clark



THE STATE OF IOWA, } ss.  
BLACKHAWK COUNTY.

OFFICE OF COUNTY AUDITOR.

To All Whom it May Concern:

The Commissioner appointed to Locate a highway in Spring Creek  
Township in said County, commencing at the South East Cr. of Section No 20 Twp 87  
Range No 11 1/2 miles of the S. M., thence S. 89° W 1 ch. N. 40° W 8 1/100 ch. N. 45° W 26 3/100 ch. N. 22 1/2°  
W 5 85/100 ch. N. 45° W 7 1/100 ch. N. 61 1/2° W 8 5/100 ch. N. 1° E 20 1/100 ch. N. 88 1/4° W 19 25/100 ch. N. 72 1/2°  
W 3 65/100 ch. S. 80 1/2° W 7 7/100 ch. S. 46 1/2° W 55 35/100 ch. N. 78° W 2 2/100 ch. to Cedar River  
Bridge

has reported in favor of such location, and all objections thereto or claims  
for damages must be filed in the office of the Auditor of said county, on or before noon  
of the 20<sup>th</sup> day of Novr A. D. 1878, or such highway will be located  
without reference thereto.

Dated at Waterloo, this 11<sup>th</sup> day of Novr A. D. 1878

David W. Foote  
COUNTY AUDITOR.



STATE OF IOWA, } SS:  
BLACKHAWK COUNTY, }

TO

*R. J. McLaughlin*

You are hereby notified that you have been appointed a Commissioner to view and if expedient to locate county road as petitioned by *David Harmon*

and others, and to be called the

*Harmon*

Road, described as follows:

Commencing at the South East corner of Section No. Twenty (20), thence in a North Westerly direction - on the most suitable ground for a road - to the center of Section No. Twenty (20), thence North Eighty (80) rods, thence West on the most suitable ground to the West line of said Section No. Twenty (20), thence straight to the Cedar River Bridge, all in Township No. Eighty-two (82) North of Range No. Seven (7) West of the 5th P. M.

You will, therefore, appear before some officer authorized to administer oaths in and for said county, and qualify according to law; and on the 17<sup>th</sup> day of September 1878, you will proceed to commence the examination of the route above described, and if, in your judgment, the above road is needed, or one in the vicinity answering the same purpose, you will call to your assistance the necessary aid, and proceed to lay out and mark the same according to law and the following instructions, and report to the Board on or before the 7<sup>th</sup> day of October 1878.

1. In your survey of this road you will particularly describe the point of commencement, with reference to some monument record, which will be generally found to consist of corners in the public and private surveys; the exact course and distance from some one of which you must give in your field notes.
2. The point at which you terminate your survey must be ascertained and returned by reference to the same evidence as is heretofore required for the commencing point.
3. All letters and figures inscribed upon wood, must be cut with a "marking iron," similar to that used in the government survey of lands.
4. Where bearing trees are taken, (and it is strongly enjoined that it within ten chains of an angle they should without fail be taken,) a smooth tree fronting the angle of the road, should be made as near the ground as practicable, and in this case should be cut the initial letters of the points of beginning and ending of the road. For example—a road from Delhi to Colony—D. N. C. R. When bearing trees cannot be had at angles, it is recommended the bearing and distance to a boundary, ellipse, or corner of an enclosure be taken, and where this is impracticable, a large mound of earth should be raised at the point of the angle.
5. Marks in timber will consist of a smooth "blaze," with a notch in the center, except the trees with the line cuts, each of which must have three notches, both upon the side which the line strikes, and that upon which it leaves such trees. All posts must be set up at every mile, and the distance marked thereon.—stakes must be set at the crossing of fences and streams, and at intervals not exceeding one-fourth of a mile each.
6. After completing your survey of this road, you must carefully protect the same upon paper, with a view to the detection of all errors, either in your chaining or course.
7. These instructions in no way relieve you from each and every duty prescribed by the laws of Iowa Revision of 1880, pages 134 and 135.
8. All your assistants are required to be sworn by some person authorized to administer oaths.

Given under my hand and official seal this

9<sup>th</sup> day of September 1878.

County Auditor.

THE STATE OF IOWA, } SS:  
BLACKHAWK COUNTY, }

I do solemnly swear that I will, to the best of my ability, perform the duties of Commissioner on the within road, according to law and the foregoing instructions.

Subscribed and sworn to before me, this

day of

187



STATE OF IOWA, }  
BLACKHAW COUNTY. } SS:

To the Honorable Board of Supervisors of said County:

The undersigned, having been appointed a Commissioner to view, and, if thought necessary, a certain Road in said County petitioned for by and others, and known as the Road, would report as follows:

That, having been duly sworn, he found, upon examination, that it was for the accommodation of the public, that the road should be as petitioned for.

Therefore with the assistance of as surveyor as chainmen, axmen, who were all duly sworn, your Commissioner proceeded on the day set therefor, to-wit: the day of A. D. 187, to lay out and locate said Road, and to distinguish the same by the proper marks, mounds and stakes, in the manner prescribed by law, and in accordance with the Field Notes and Plat of Survey of the Road, which are hereunto annexed, and which are made part of this report.

Your Commissioner is of the opinion, that the road will be of to the public, and would hereby recommend its All of which is respectfully submitted.

Commissioner.

The following Fees should be paid by the Petitioner for the Road:

Fees Commissioner,	da	Mileage	\$
" Surveyor,	"	"	\$
" Chainmen,	"	"	\$
"	"	"	\$



N. Swift  
 La Porte City, Iowa, Jan 6 1875  
 Co. Auditor

C. Audeter

To **JESSE WASSON** Dr.

BOOK AND JOB PRINTER,

AND PUBLISHER OF THE

1875  **PROGRESS.** 

Printed & Executed Notice R Vaughan	200
for 20 " Road Notice	519



AFFIDAVIT OF PUBLICATION.

STATE OF IOWA, } ss.  
BLACKHAWK COUNTY, }

*Marson* Being first duly sworn, deposes and says he  
is *Proprietor* of the LA PORTE CITY PROGRESS, a weekly  
newspaper, published at La Porte City, in said County and State,  
that the *Notice* a copy of which is hereto attached  
was published in said newspaper for *two* consecutive weeks,  
begining on the *13* day of *Nov.* A. D. 187 *8* and ending on the  
*20* day of *Nov.* A. D. 187 *8* and further deponent saith not.

Subscribed and Sworn to before me and in my presence by the said  
*Marson* this *6* day of *Jan.* A. D. 187 *9*

*Arthurly P. Riss*  
*Notary Public*

#5-19

STATE OF IOWA, } ss. Office of  
BLACKHAWK COUNTY, } County Auditor.  
To all whom it may concern:  
The Commissioner appointed to view a high-  
way in Spring Creek township, in said county,  
commencing at the south-east corner of Section  
No. 20, Township No. 87, Range No. 11, west of  
the 5th P. M., thence S. 89 degrees W. 1 ch., N.  
40 degrees W. 8 10-100 ch., N. 45 degrees W. 23  
30-100 ch., N. 22 1/2 degrees W. 5 85-100 ch., N. 45  
degrees W. 7 56-100 ch., N. 61 1/2 degrees W. 8 50-  
100 ch., N. 1 degree E. 20 10-100 ch., N. 88 1/2 de-  
grees W. 19 25-100 ch., N. 72 1/2 degrees W. 3 65-  
100 ch., S. 80 1/2 degrees W. 17 44-100 ch., S. 48 1/2  
degrees W. 55 35-100 ch., N. 78 degrees W. 2  
20-100 ch. to Cedar river bridge, has reported in  
favor of such location, and all objections thereto  
or claims for damages must be filed in the office  
of the Auditor of said county, on or before noon  
on the 20th day of January, A. D. 1879, or such  
highway will be located without reference there-  
to. Witness my hand and seal this 11th day of Nov., A.  
D. 1878 at Waterloo, this 11th day of Nov., A.  
D. 1878. DANIEL W. FOOTE,  
County Auditor.



SEATS OF IOWA,  
BLACKHAWK COUNTY, } SS:

To

*General Day*

You are hereby notified that you have been appointed a Commissioner to view, and if expedient to locate county road as petitioned by *David Harmon* and others, and to be called the *Harmon*

Road, described as follows:

Commencing at the south east corner of section  
the Twenty (20), thence in a short westerly  
direction on the most suitably ground for  
a road to the center of section the  
Twenty (20), thence North Eighty Rods, thence  
West on the most suitably ground to the West  
line of said section the Twenty (20), thence  
straight to the Cedar River bridge, at  
an elevation the Eighty Rods, at  
of Range the Eastern (11 West, of the 3rd R.R.

You will, therefore, appear before some officer authorized to administer oaths in and for said county, and qualify according to law; and on the 1<sup>st</sup> day of

*July*

1878, you will proceed to commence the examination of the route

above described, and if, in your judgment, the above road is needed, or one in the vicinity answering the same purpose, you will call to your assistance the necessary aid, and proceed to lay out and mark the same according to law and the following instructions, and report to the Board on or before the 31<sup>st</sup> day of *July* 1878.

1. In your survey of this road you will particularly describe the point of commencement, with reference to some monument record, which will be generally found to consist of corners in the public and private surveys; the exact course and distance from some one of which you must give in your field notes.
2. The point at which you terminate your survey must be ascertained and returned by reference to the same evidence as is herein required for the commencing point.
3. All letters and figures inscribed upon wood, must be cut with a "marking iron," similar to that used in the Government survey of lands.
4. Where bearing trees are taken, (and it is strongly enjoined that if within ten chains of an angle they should without fail be taken,) a smooth face pointing the angle of the road, should be made as near the ground as practicable, and in this face should be cut the initial letters of the points of beginning and ending of the road. For example:—a road from Delhi to Colony—D. & C. R. When bearing trees cannot be had at angles, it is recommended the bearing and distance to a corner, either, or corner of an enclosure be taken, and where this is impracticable, a large mound of earth should be raised at the point of the angle.
5. All the corners with corners of a smith, black, with a point in the center, except the trees with the line cuts, each of which must have three notches, both upon the top, sides, and corners, and upon which such trees, after the posts must be set up in every mile, and the distance marked thereon.—stakes must be set at the crossing of roads, and sections, and at every mile, and the distance marked thereon.
6. After completing your survey of this road, you must carefully protect the same upon paper, with a view to the detection of all errors, either in your chaining or course.
7. These instructions in no way relieve you from each and every duty prescribed by the laws of Iowa Revision of 1860, pages 124 and 125.
8. All your assistants are required to be sworn by some person authorized by the laws of Iowa Revision of 1860, pages 124 and 125.

Given under my hand and official seal this

13 day of

*June*

1878.

*Alvan H. Felt*

County Auditor.

THE STATE OF IOWA, } SS:  
BLACKHAWK COUNTY,

I do solemnly swear that I will, to the best of my ability, perform the duties of Commissioner on the within road, according to law and the foregoing instructions.

Subscribed and sworn to before me, this

day of

187.



State of Iowa  
Black Hawk Co }

I hereby Certify that the within  
notice came to hand on the 27<sup>th</sup> day of November  
1878 that on the same day in Spring Creek  
Twp Black Hawk Co Iowa I served J. M.  
Bailey, A. Southerland, <sup>James Thompson</sup> Mrs. M. Dunslop &  
Shelly Taylor by reading said notice to them  
in their presence & hearing and by giving each  
a copy thereof. I further Certify that I served  
H. Shelly by leaving a copy of this notice for  
him at his dwelling & usual place of  
residence in Spring Creek Twp Co & State of Iowa  
said with H. M. Shelly the being a member  
of his family & over 14 years of age. I further  
Certify that I served Peter Shelly by leaving  
a copy for him with Catharine Shelly at  
house & near at place of residence in Spring  
Creek Twp Co & State of Iowa said the said Catharine  
Shelly being a member of this family & over 14 years  
of age. I further Certify that I served A.  
William in East Waterloo Twp Black Hawk  
Co Iowa by reading said notice to him in  
his presence & hearing & by giving him a copy  
of same. The said Shelly Taylor being one  
of the administrators of the estate of George  
Taylor Deed all of the above served on  
the 28<sup>th</sup> day of Nov 1878 Attest  
W. H. Gaylett Sheriff  
W. H. Gaylett Deput



THE STATE OF IOWA, } ss.  
BLACKHAWK COUNTY.

OFFICE OF COUNTY AUDITOR.

To All Whom it May Concern:

The Commissioner appointed to *view* a highway in *Spring Creek* Township in said County, commencing *at the South East cor. of section* No 20 *sup. Sec 17 Range No 11 N. of the 5th P.M. thence S 89° W 1 c.*, *N 40° W 8 c.*, *N 45° W 26 c.*, *N 22 c. W 5 c.*, *N 45° W 50 c.*, *N 61 c. W 8 c.*, *N 10° 20 c. W 88 c.*, *N 19 c. W 22 c.*, *N 22 c. W 36 c.*, *S 80 c. W 17 c.*, *S 26 c. W 55 c.*, *N 78° W 2 c.* to *beetle* *Barin Bridge*,

has reported in favor of such *location* and all objections thereto or claims for damages must be filed in the office of the Auditor of said county, on or before noon of the *20<sup>th</sup>* day of *May* A. D. 187*9*, or such highway will be *located* without reference thereto.

Dated at Waterloo, this *11<sup>th</sup>* day of *Nov* A. D. 187*8*

*Paul M. Fort*

COUNTY AUDITOR.



STATE OF IOWA, } ss.  
BLACKHAWK COUNTY.

I, *W. W. Edgington*, being duly sworn, do upon oath say that on the *27* day of *Nov* A. D. 1878, in *Spring Creek* Township in said county, I personally served the within notice on *the persons named in*

*the Return hereto attached* by reading the said notice to *and in* hearing, and by delivering to *a true copy of* said notice: *as per said Return*

Subscribed and sworn to before me by the said *W. W. Edgington* this *9* day of *Dec* 1878



*Harmon* Road.

SERVICE OF NOTICE.

Filed *Dec 9* 1878

*David M. Lewis*  
County Auditor.

*Sherriffs fees*

*Service* 2.25-

*Copy* 1.60

*2.50*

*\$6.35-*

*3.92*

*10.27*



AFFIDAVIT OF PUBLICATION.

STATE OF IOWA, } ss.  
BLACKHAWK COUNTY, }

*Masson* Being first duly sworn, deposes and says he is *Ed. and Prop.* of the LA PORTE CITY PROGRESS, a weekly newspaper, published at La Porte City, in said County and State, that the *Notice* a copy of which is hereto attached was published in said newspaper for *Four* consecutive weeks, beginning on the *29* day of *Jan.* A. D. 187*9* and ending on the *12* day of *Feb.* A. D. 187*9* and further deponent saith not.

Subscribed and Sworn to before me and in my presence by the said *Masson* this *17* day of *Feb.* A. D. 187*9*

*Christ Bishop*  
Notary Public  
Iowa

THE STATE OF IOWA, } ss.  
BLACKHAWK COUNTY, }

OFFICE OF COUNTY AUDITOR.

To all whom it may concern: The commission-  
er appointed to view a highway in Spring Creek  
Township in said County, commencing at the  
south-east corner of section No. 20, township No.  
87, range 11, west of the 5th P. M. thence south  
89° w 1 ch, n 40° w 8-10 ch, n 45° w 23-30 ch, n 22½°  
w 5-85 ch, n 45° w 7-50 ch, n 61½° w 8-50 ch, n 10°  
e 20-10 ch, n 88½° w 19-25 ch, n 72½° w 3-65 ch, s  
80½° w 17-14 ch, s 48½° w 55-33 ch, n 78° w 2-20 ch  
to Cedar river bridge, has reported in favor of  
such location and all objections thereto or claims  
for damages must be filed in the office of the Aud-  
itor of said county, on or before noon of the 25th  
day of February, A. D. 1879, or such highway  
will be located without reference thereto.  
Dated at Waterloo, this 20th day of January,  
A. D. 1879.  
DAN L. W. FOOTE,  
County Auditor.



THE STATE OF IOWA, } ss.  
BLACKHAWK COUNTY.

OFFICE OF COUNTY AUDITOR.

To All Whom it May Concern:

The Commissioner appointed to view a highway in Spring Creek Township in said County, commencing at the South East cor. of Section No 20 Twp 87 Range No 11 West of the 5<sup>th</sup> P.M., thence S 89° W 1 ch, N 40° W 8<sup>10</sup> ch, N 45° W 26<sup>30</sup> ch, N 22<sup>1</sup>/<sub>2</sub>° W 5<sup>45</sup> ch, N 45° W 7<sup>50</sup> ch, N 61<sup>1</sup>/<sub>2</sub>° W 8<sup>50</sup> ch, N 1° E 20<sup>10</sup> ch, N 88<sup>1</sup>/<sub>4</sub>° W 19<sup>25</sup> ch, N 72<sup>1</sup>/<sub>2</sub>° W 3<sup>65</sup> ch, S 80<sup>1</sup>/<sub>2</sub>° W 17<sup>74</sup> ch, S 46<sup>1</sup>/<sub>4</sub>° W 55<sup>35</sup> ch, N 78° W 2<sup>20</sup> ch to Cedar River Bridge.

has reported in favor of such location, and all objections thereto or claims for damages must be filed in the office of the Auditor of said county, on or before noon of the 20<sup>th</sup> day of Jan'y, A. D. 1879, or such highway will be located without reference thereto.

Dated at Waterloo, this 11<sup>th</sup> day of Nov, A. D. 1878

David W. Foster  
COUNTY AUDITOR.



STATE OF IOWA, }  
BLACKHAWK COUNTY. } SS.

I, *Wm Hayslett*, being duly sworn, do upon oath say that on the *27* day of *Nov* A. D. 1878, in *Big Creek* Township in said county, I personally served the within notice on *Banger & Chapin By leave*, *Copy of said Notice with Esso Banger for Mary A Banger & on B. A. Chapin*, *D. B. Fox & A. C. Kennedy Estate* by reading the said notice to ~~and in~~ *hearing, and* by delivering to *Each* a true copy of said notice. *Each was reading of said Notice to the A. C. Kennedy Estate* *Served 4 true copy to Sally Clark Administrator of the same*  
Subscribed and sworn to before me by the said *Wm Hayslett* this *9* day of *Dec* 1878  
*Saml W. Foster*  
*C. Auditor*



*Hammer Road.*

SERVICE OF NOTICE.

Filed *Dec 9* 1878  
*Saml W. Foster*  
County Auditor.

Serving *100*  
copies *2.80*  
Mileage *2.10*  
*\$3.90*

THE STATE OF IOWA



THE STATE OF IOWA, }<sup>33.</sup>

Black Hawk County.

To

Ed Campbell. Olin Waterfield  
and W. A. Ruttal

GENTLEMEN:--- You are hereby notified that you have been appointed by

the Auditor of said County Appraisers to assess the damages sustained by Peter  
M. Shick, Wm. Van Brocklin, Bangen Chapman  
and Adam Williamsin consequence of the location of a County Road petitioned for by  
David Hammond and others, in Spring Creek  
Township, as located by John Weaver Commissioner.

Said Road runs on the following lines to wit:

Commencing at the Sec. of Sec. 20, Twp 87, Range 11, thence N 1/4 to  
Center of Section 20, thence S to the S 1/4 of N 1/4 of Section  
20, thence N 1/4 to the N 1/4 of Sec. 20, thence S 1/4 to  
the Bridge across Cedar River.The said Peter M. Shick claims \$75<sup>00</sup> damages  
for the location of said Road on the N 1/4 of Sec. 20, Twp 87, R. 11The said W. Van Brocklin claims \$25<sup>00</sup> damages  
for the location of said Road on the N 1/4 of Sec. 20, Twp 87, R. 11The said Bangen Chapman claims \$250<sup>00</sup> damages  
for the location of said Road on the S 1/4 of Sec. 20, Twp 87, R. 11,The said Adam Williams claims \$400<sup>00</sup> damages  
for the location of said Road on the N 1/4 of Sec. 20, Twp 87, R. 11,

You will therefore meet at the office of

J. N. Markle

at 10 o'clock A. M., on the 12<sup>th</sup> day of

April 1879

March, 1879, and qualify according to law, and proceed immediately to the  
discharge of your duty, and make your report herein on or before the 27<sup>th</sup> day of

March, 1879.

Witness my hand and the seal of the Board of Supervisors

this 25<sup>th</sup> day of March, A. D., 1879.

David M. Root

County Auditor.



# DATE OF APPRAISERS.

Gazette Steam Job Office, Cedar Falls, Iowa.

## THE STATE OF IOWA, } ss.

Black Hawk County,

We G. B. Campbell, Wm. Waterfield, W. H. Butler

do each of us solemnly swear that, having been appointed appraisers to assess the damages sustained by

Peter M. Trinky, Wm. Van Brocklin, Bangs & Chapin, and Abner Williams

in consequence of the location of a road petitioned for by

David Hammond and others, we will faithfully and impartially

discharge the duties of appraisers according to the best of our knowledge and ability.

Appraisers:

G. B. Campbell  
Wm. Waterfield  
W. H. Butler

Subscribed and sworn to before me, this 12<sup>th</sup> day of March 1879.

John A. Marshall J. A.

## REPORT OF APPRAISERS.

STATE OF IOWA, } ss.  
Black Hawk County,

TO THE AUDITOR OF SAID COUNTY:

We, the appraisers appointed to assess the damages sustained by the above named persons, in consequence of the location of the aforesaid road, do find that

Peter M. Trinky, Wm. Van Brocklin, Bangs & Chapin, will sustain ~~the~~ damages, ~~the~~ dollars

Chapin will sustain ~~the~~ damages, ~~the~~ dollars

Abner Williams will sustain ~~the~~ damages, ~~the~~ dollars

Wm. Van Brocklin will sustain ~~the~~ damages, ~~the~~ dollars

Appraisers:

G. B. Campbell  
Wm. Waterfield  
W. H. Butler

Appraisers:

G. B. Campbell

Wm. Waterfield

W. H. Butler

Wm. Van Brocklin

J. P. FEES.

John A. Marshall \$ 00.75 paid by appraisers