

File 2017-00007758

UNITED STATES PUBLIC LAND SURVEY CORNER CERTIFICATE

☐ There is no certificate on file for this corner.
☒ There are no longer three valid ties of record.
☐ There are changes to reference ties of record.
☒ There is change of monumentation of record.
☐ To clarify description of record monument (ties).

North 1/4 Corner: The Previous Section Corner Certificate indicates "Found 3/8" steel pin/nail flush with A.C.C. Surfacing". Found Hinge Nail, loose in asphalt. Nail was removed and area was searched, Found Lead Plug in Concrete paving that matches ties of record within reason. Reset survey mark nail with stainless steel washer PLS 22468 at the coordinates obtained prior to highway reconstruction in conjunction with IDOT, Project No. NHSX-218-7(207)-3H-07.

(Show a minimum of three reference ties to durable physical objects, relevant monuments and physical conditions that will enable recovery of the corner.)

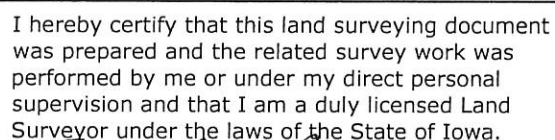

License number 22468
My license renewal date is December 31, 2017.
Sheets covered by this seal: Individual sheet only

List Corners to be Indexed			
Corners	Section	Twp.	Range
N 1/4	13	90	14

Project Number: 2015-011

FB: 2015-011 218/CWR, Pgs. 1