

PREPARED BY PATRICK SHEPARD: CIVIL ENGINEERING CONSULTANTS, INC. - 2400 86th ST. #12 -DES MOINES, IOWA 50322

UNITED STATES PUBLIC LAND SURVEY CORNER CERTIFICATE OF

LAND SURVEY MONUMENTS SITUATED IN SECTION 20, TOWNSHIP 90 NORTH, RANGE 13 WEST, OF THE FIFTH PRINCIPAL MERIDIAN, BLACK HAWK COUNTY, IOWA. PREVIOUS RECORD FOUND AT THE BLACK HAWK COUNTY RECORDER'S OFFICE IN BOOK 327 MISC. PAGE 606.

MONUMENT DESCRIPTION AND REMARKS: NE CORNER, 20-90-13 FOUND 1/2" IRON ROD THAT MATCHES PREVIOUS RECORD AT THE INTERSECTION OF ROAD CENTERLINES. NO PREVIOUS TIES FOUND. THIS CERTIFICATE IS BEING PREPARED DOCUMENT MONUMENTATION FOUND AND ACCEPTED AS THE NE CORNER AND TO REPLACE LOST TIES.

PLAN -VIEW

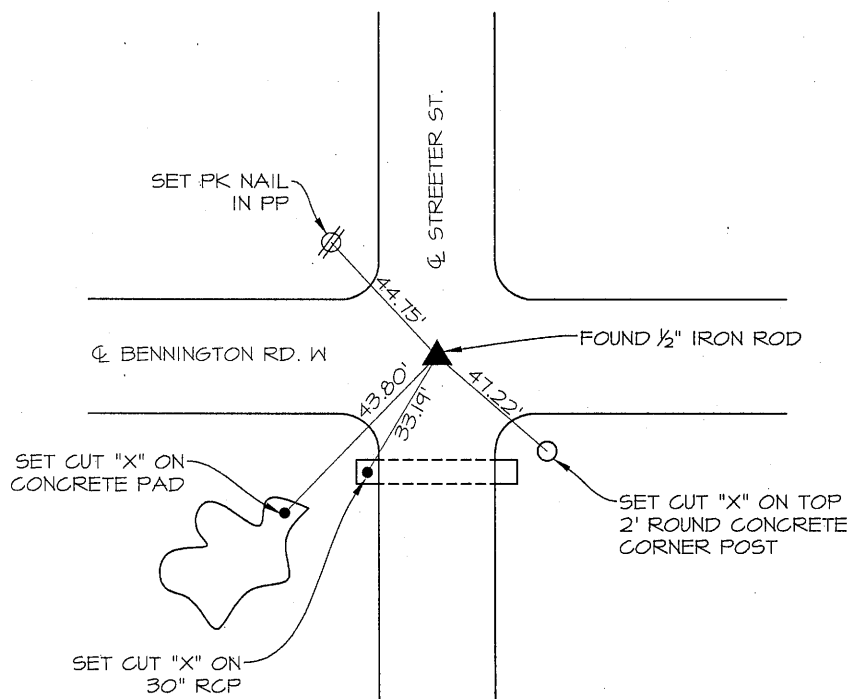

LIST CORNERS TO BE INDEXED

CORNERS	SECTION	TWP.	RANGE
NE CORNER	20	90	13
NW CORNER	21	90	13
SE CORNER	17	90	13
SW CORNER	16	90	13

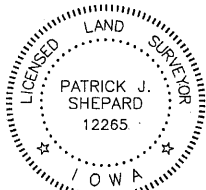
	<p>I HEREBY CERTIFY THAT THIS LAND SURVEYING DOCUMENT WAS PREPARED AND THE RELATED SURVEY WORK WAS PERFORMED BY ME OR UNDER MY DIRECT PERSONAL SUPERVISION AND THAT I AM A DULY LICENSED LAND SURVEYOR UNDER THE LAWS OF THE STATE OF IOWA.</p> <p><i>Patrick J. Shepard</i> 1-24-13 PATRICK J. SHEPARD, IOWA LICENSE NO. 12265 DATE MY LICENSE RENEWAL DATE IS DECEMBER 31, 2013 PAGES OR SHEETS COVERED BY THIS SEAL: THIS SHEET ONLY</p>
---	---