

7295

BLACK HAWK COUNTY, IOWA:SS

Filed for record Nov 14 1990

at 11:05 AM, and recorded in

Misc Book 293

Page 351

Samoa Williams

Recorder

Deputy

Fee \$5.00/

Cedar Valley Engineering Co.

P. O. Box 827

Waverly, IA 50677

LAND SURVEY MONUMENT RECORD
BLACK HAWK COUNTY, IA

Description of monument and evidence found at corner location.

LEAD PLUG - COUNTY RECORD

LEAD PLUG - FOUND

Sec. 18 , T 90 N , R 13 W

N W Corner

Location:

☒ Section Corner ☐ Quarter Corner

☐ Corner of _____ Quarter/Quarter

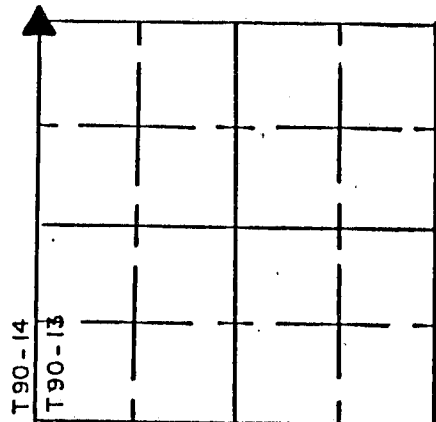

Accessory information found at time of corner location.

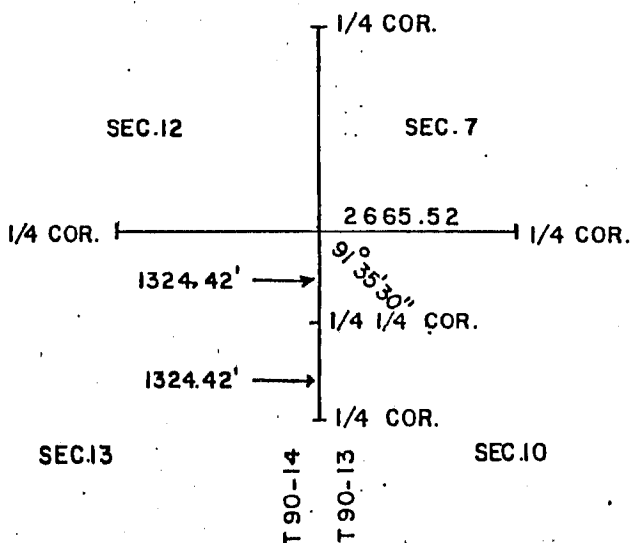

Sketch showing relative location of monument and reference points (minimum of three (3) references)

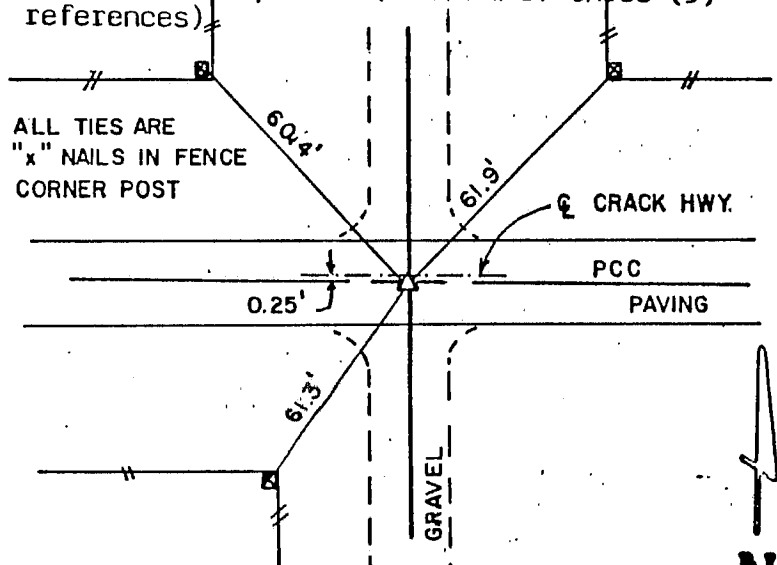

I hereby certify that this plat, map, survey, or report was made by me or under my direct personal supervision and that I am a duly Licensed and Registered Land Surveyor under the laws of the State of Iowa.

Sig. Terry D. Van Laningham Date Sept. 25 1993
Terry D. Van Laningham, L.S. Iowa Reg. No. 10793

11/11/11 Date of Fieldwork:

SEPT. 21, 1990

A. AKSOY

T. VAN LANINGHAM

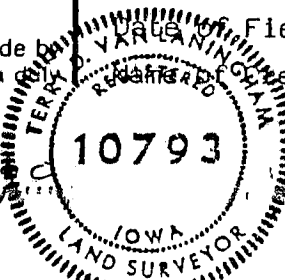

CEDAR VALLEY ENGINEERING
WAVERLY

CO.
IOWA

DRAWN 00

DATE 9/25/90

APPROVED TDK

SCALE NONE

BWG.
NO.

293 PAGE 351

BOK