

UNITED STATES PUBLIC LAND SURVEY  
CORNER CERTIFICATE OF

LAND SURVEY SITUATED IN:	Section 14, Township 90 North, Range 13 West, of the Fifth Principal Meridian, Black Hawk County, Iowa.
PREVIOUSLY RECORDED IN BOOK:	Book 326 Misc, Page 484
INSTRUMENT #:	
FIELD WORK COMPLETED:	9/26/2019
SURVEY PREPARED BY: RESPOND TO:	CLAPSADDLE-GARBER ASSOCIATES, INC, 16 EAST MAIN STREET, P.O. BOX 754, MARSHALLTOWN, IOWA 50158 PHONE 641-752-6701 TSTEWART@CGACONSULTANTS.COM

Doc ID: 009804650001 Type: GEN  
Recorded: 04/17/2020 at 02:15:04 PM  
Fee Amt: \$0.00 Page 1 of 1  
Black Hawk County Iowa  
SANDIE L. SMITH RECORDER  
File **2020-00017990**

THIS CERTIFICATE WAS PREPARED TO PERPETUATE MONUMENTATION AFTER BLACK HAWK COUNTY HMA PAVEMENT WIDENING WITH  
HMA RESURFACING PROJECT STBG-SWAP-C007(136)--FG-07. CORNERS WERE SET USING METHODS DESCRIBED BELOW.

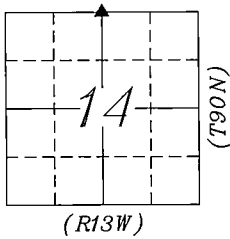

PLAN-VIEW  
NO SCALE

LEGEND:

- ▲ GOVERNMENT CORNER MONUMENT FOUND
- △ GOVERNMENT CORNER MONUMENT SET
- 1/2" x 30" REBAR w/ORANGE PLASTIC ID CAP #17162
- PARCEL OR LOT CORNER MONUMENT FOUND
- //— EXISTING FENCE
- NAIL w/SM NAIL WITH SURVEY MARKER

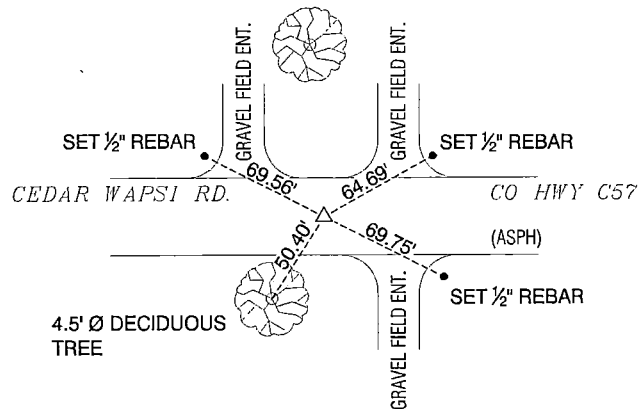

N 1/4 COR  
SECTION 14-90-13

SET MAG SPIKE AFTER PAVING  
PROJECT WAS COMPLETE

CORNER IS ON CL JOINT



Clapsaddle-Garber Associates, Inc  
5106 Nordic Drive  
Cedar Falls, Iowa 50613  
Ph 319-266-0258  
www.cgaconsultants.com

DRAWN SJC	SHEET NO. 1
DATE 10-01-2019	PROJECT NO. 78321.05

List Corners to be Indexed

Corners	Section	Township	Range
N 1/4 COR	14	90N	13W
S 1/4 COR	11	90N	13W

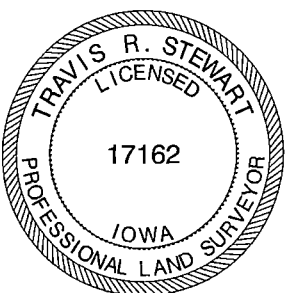

I hereby certify that this land surveying document was prepared and the related survey work was performed by me or under my direct personal supervision and that I am a duly Licensed Professional Land Surveyor under the laws of the State of Iowa.

*Travis R. Stewart* 10-10-2019  
Travis R. Stewart, PLS date  
Iowa License Number 17162  
My License Renewal Date is December 31, 2019  
Pages or sheets covered by this seal: THIS SHEET