

SC ✓  
MISC ✓  
INDEX (B) ✓  
MARGIN  
PROOF (M) ✓  
COMPARE ✓

BLACK HAWK COUNTY IOWA:SS 27285  
FILED FOR RECORD MAY 21, 1999 AT  
2:00 P. M. AND RECORDED IN BOOK 334  
OF MISC. PAGE 530.  
*Patricia J. S.* RECORDER  
FEE 1-5.00/  
S & S LAND SURVEYING  
118 W BREMER AVE  
WAVERLY, IA 50677

PREPARED BY - S & S LAND SURVEYING, INC., 118 W BREMER AVE., PO BOX 148, WAVERLY, IOWA 50677 - PHONE 319-352-9444

UNITED STATES PUBLIC LAND SURVEY CORNER CERTIFICATE  
OF

Land Survey Monuments situated in Section 10, Township 90 N, Range 13 W, of the Fifth Principal Meridian, BLACK HAWK County, Iowa.  
Previously recorded in Book 326 MISC, Page 483.

CORNER LOCATED USING COUNTY TIES FOR SURVEY IN E 3/4 OF SE 1/4  
FND 5/8 REBAR AT APPROX. INTERSECTION OF BURTON AVE. AND  
HWY C 57

PLAN-VIEW  
NO SCALE

RECEIVED - BLACK HAWK COUNTY RECORDER

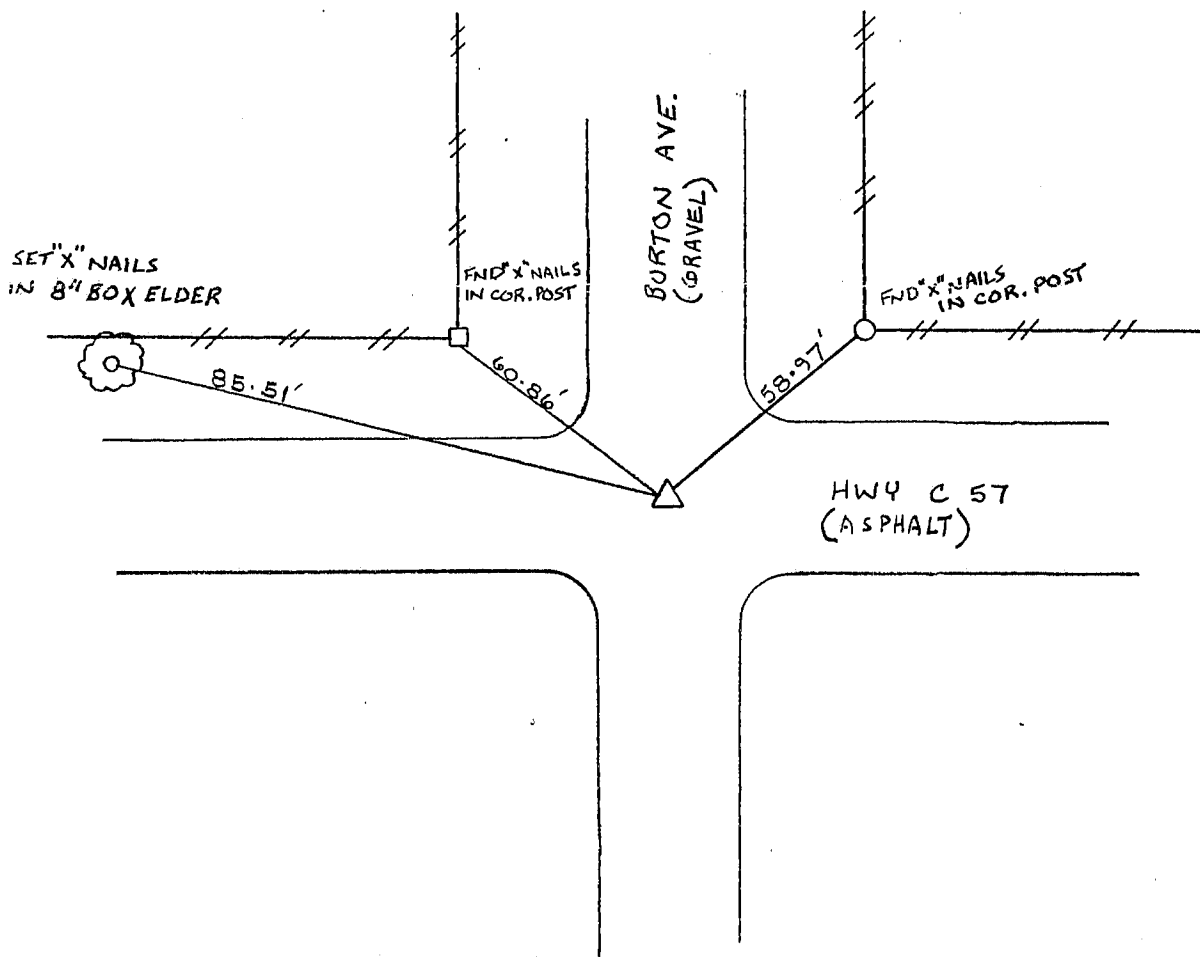
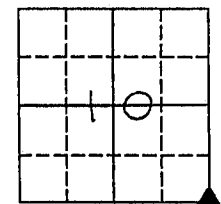

I hereby certify that this land surveying document was prepared and the related survey work was performed by me or under my direct personal supervision and that I am a duly Licensed Professional Land Surveyor under the laws of the State of Iowa.

*Scott A. Steinfadt*  
Scott A. Steinfadt, P.L.S.  
Iowa License No. 14677  
My License Renewal Date is Dec. 31, 2000.

5/20/99  
date

List Corners to be Indexed

Corners	Section	Twp	Range
S. E. COR.	10	90 N	13 W

S & S  
LAND SURVEYING, INC.

118 W. BREMER AVE. PO BOX 148  
WAVERLY, IOWA 50677  
(319) 352-9444