

PROOF FILED FOR RECORD SEP 20, 2004, AT 2:00 P. M. FEE 1-5.00/ - 1.00/

COMPARED

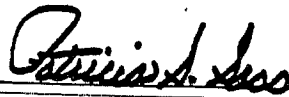

BLACK HAWK COUNTY RECORDER

TERRY D VANLANINGHAM 120 2ND ST SW WAVERLY IA 50677

PREPARED BY TERRY D. VAN LANINGHAM, PLS, INC. \* 120 2ND STREET, SW, \* WAVERLY, IOWA \* (319) 352-0801 \* e-mail = van@forbin.net

UNITED STATES PUBLIC LAND SURVEY CORNER CERTIFICATE  
OFLand Survey Monuments situated in Section 09, Township T 90 N, Range R 13 W,  
of the Fifth Principal Meridian, BLACK HAWK County, Iowa. Previously recorded  
in \_\_\_\_\_ in County Recorder's Office.

(book, page, document number, etc.)

(Show reason for preparing this certificate, the evidence and detailed procedures used in establishing the corner positions and  
monumentation found or placed.)

Monument Description and Remarks:

A - FD REBAR IN CENTER OF GRAVEL ROADS

B - SET NAI WITH BRASS WASHER IN POWER POLE

## PLAN VIEW

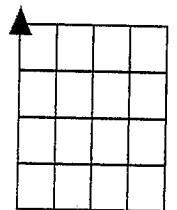
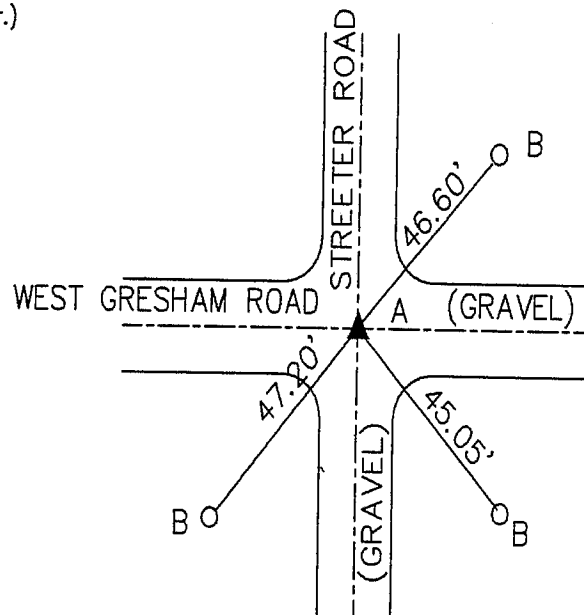
(Show a minimum of three reference ties to durable physical objects, relevant monuments and physical conditions that will  
enable recovery of the corner.)

SECTION 09

NW CORNER

I hereby certify that this land surveying document was prepared  
and the related survey work was performed by me or under my  
direct personal supervision and that I am a duly licensed Land  
Surveyor under the laws of the State of Iowa.

Terry D. Van Laningham, PLS

License Number 10793

My registration renewal date is December 31, 2005

Pages or sheets covered by this seal:

THIS SHEET ONLY



## List Corners to be Indexed

Corners	Section	Township	Range
NW CORNER	09	T 90 N	R 13 W

TERRY D. VAN LANINGHAM. PLS. INC.

120 2ND STREET SW

WAVERLY, IOWA

(319) 352-0801