

RYKEN ENGINEERING  
711 PARK AVE  
ACKLEY IA 50601

Document Number: 2007020783  
Date: Apr 04, 2007 4:30:00 pm  
Aud Fee: 0.00 Rec Fee: 10.00  
Trans Tax: 0.00 Rec Management Fee: 1.00  
E-Com Fee: 1.00 Non-Standard Page Fee: 0.00  
Filed for record in Black Hawk County, Iowa  
Judith A. McCarthy, County Recorder

Lee O. Gallentine LS, Ryken Engineering, 711 Park Avenue, Ackley, Iowa 50601 - Ph. 641-847-3273 - Fax 641-847-2303

UNITED STATES PUBLIC LAND SURVEY CORNER CERTIFICATE  
OF

Land Survey Monuments situated in Section 25 , Township 90 North,  
Range 12 West, of the Fifth Principal Meridian, Black Hawk County, Iowa,  
Previously recorded in Not Applicable in County Recorder's Office

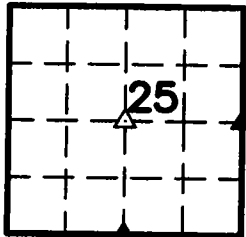

This certificate is being prepared because there are no certificates on file for these corners and these corners were used for a survey in this section for Wonder Acres, Inc.

Legend

- BC = Nail with Bottle Cap  
BP = Brace Post  
CP = Corner Post  
CMP = Corrugated Metal Pipe  
CM = 4" Sq Concrete Monument with  
1/2" iron rod in center (tie to rod)  
CX = Cut 'X'  
GP = Gate Post
- ID = Inside Diameter  
OD = Outside Diameter  
PP = Power Pole  
PW = Nail with Plastic Washer  
RCP = Reinforced Concrete Pipe  
RH = Red Head (Nail in wire)  
ROW = Right of Way  
RW = Nail with Reflective Round Washer
- R/W = Iron ROW Rail  
SFP = Steel 'T' Post  
SW = Nail with Square Metal Washer  
TP = Telephone Pedestal  
TW = Nail with Round Metal Washer  
WFP = Wood Fence Post  
X = X Nails



E 1/4 Cor.

CO ENGR'S RECORD TIES

NE Cor - Fnd 5" x 5" concrete monument with broken top 1.1' deep - Doc. #2006-27273)

Witness Corner - Set 3/4" x 2.0" Orange Capped Iron Rod (#15745) flush at 1.5'± north of fence

CRP

260.00'

2.639.75'

Fnd 2 1/2" x 2 1/2" angle iron CP (leaning northwest - tie to near edge at 1.0' above ground)

Farm

Field

Field No. 25-790N-R12W  
RT location indicated by random time dug hole 5ft square x 12" deep.  
Found: two midget head stones one was 13" x 14" x 15" of size the other was 5" x 8" x 9 1/2"  
Lowered all evidence in place and set Cement Monument with cap marked  
25-30  
Set top of Cement Monument 12" deep  
4.8' SW of x-spikes in fence post  
15.2' SW of x-spikes in fence post  
1.6' NW of steel corner post

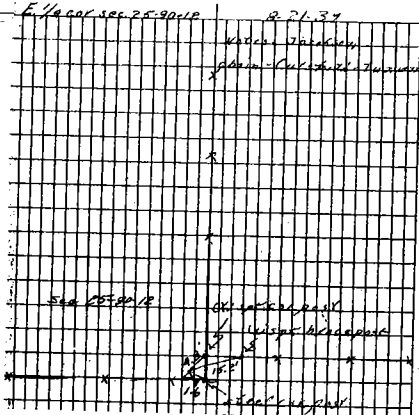

Monument Description, Remarks, and Plan View:

E 1/4 Cor. - History of Corner = 1872, Feb 5 - Co Aud's Survey Rec Bk 1 Pg 19 indicates usage of corner by 'John Ball', but does not indicate type of monumentation at corner  
Current Co Engr's records indicate that corner is monumented with 'Found: two . . . stones one was 13" x 14" x 15" of size and other one 5" x 8" x 9 1/2". Lowered all evidence in place and set Cement monument with cap marked . . . 12" deep' with ties as shown above  
Corner Recovery = Excavated 2.0' x 1.0' deep hole on northwest side of angle iron corner post and found remains of rock pile over 4" x 4" concrete monument with brass cap (stamped '25', and '30') 0.8' deep at 1.2'± West of remnants of fenceline North and 0.8'± South of remnants of fenceline remnants West. Monument found matches that of record. Therefore, placed pink plastic-cased magnet on North side of concrete monument below top of concrete monument for locating purposes only and used center of brass cap as the correct corner. All ties are plumb distance unless indicated otherwise.

P/BOB/BLACKHAWKCO/S259012/BRIGGS4186/DWG/4186concert.dwg

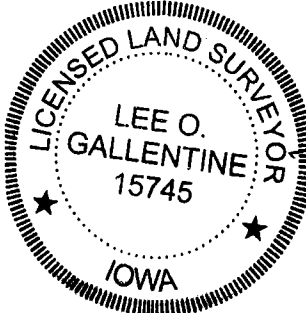

I hereby certify that this land surveying document was prepared and the related survey work was performed by me or under my direct personal supervision and that I am a duly licensed Land Surveyor under the laws of the State of Iowa.  
LEE O. GALLENTINE, LS  
Date: March 5, 2007 License number: 15745  
My license renewal date is December 31, 2008  
Pages or sheets covered by this seal: 1 & 2

List Corners to be Indexed

Corners	Section	Twp	Range
E 1/4 Cor.	25	T90N	R12W
S 1/4 Cor.	25	T90N	R12W
Center.	25	T90N	R12W

## CO ENGR'S RECORD TIES

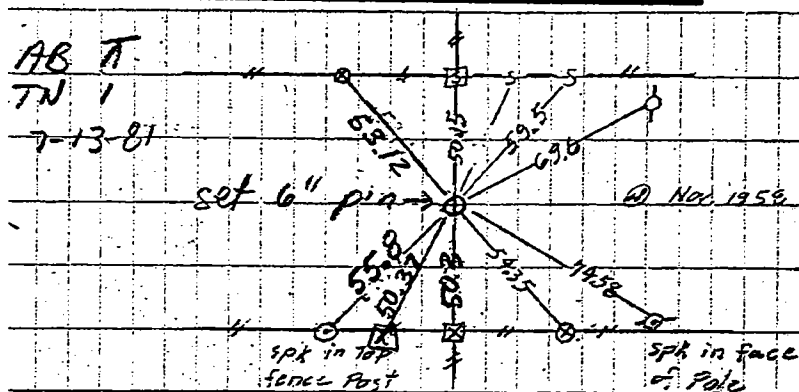

Corner Recovery = Searched area with metal detector and found 5/8" Iron Rerod flush in centerline of ACC road E-W, 0.5'± East of fence line South, and in-line with fence line North. Monument found matches that of record and record ties are within reason. Therefore, used rerod as the correct corner. All ties are plumb distance unless indicated otherwise.

**Corner Recovery** = Calculated location of corner at the intersection of straight lines between opposite  $\frac{1}{4}$  corners. Using this location, searched area for 'Boulder' tie from 1872 and 1911 surveys and did not find boulder or any evidence thereof. Since no evidence of previous tie could be located, set  $\frac{3}{4}$ "  $\phi$  x 4.0' Alum Capped Iron Rerod (#15745) stamped 'CENTER' at point calculated above in accordance with accepted PLSS methods and used it as the correct corner (see plat filed with this corner cert for measurements). Rerod is flush in-line with remnants of fenceline South. All ties are plumb distance unless indicated otherwise.

R/W = Iron ROW Rail  
SFP = Steel 'T' Post  
SW = Nail with Square Metal Washer  
TP = Telephone Pedestal  
TW = Nail with Round Metal Washer  
WFP = Wood Fence Post  
X = X Nails