

SC  
MISC  
INDEX  
MARGIN  
PROOF  
COMPARISON

BLACK HAWK COUNTY IOWA:SS

Filed for record JUN 30, 1999 at  
1:00 P.M. and recorded in Book 334  
of MISC Page 930

Recorder

Fee 1-5.00/

STUMBO &amp; ASSOCIATES

PO BOX 1664

AMES IA 50010

RECEIVED - BLACK HAWK CO. ASSESSOR

STUMBO AND ASSOCIATES LAND SURVEYING, INC. P.O. BOX 1664 AMES, IOWA 50010 Ph#515-233-3689

## UNITED STATES PUBLIC LAND SURVEY CORNER CERTIFICATE OF

Land Survey Monuments situated in Section 13 Township 90 North, Range 12 West  
of the Fifth Principal Meridian, BLACK HAWK County, Iowa.  
Previously recorded NA

(BOOK, PAGE / INST. NO. / CABINET, SLIDE)

(Show reason for preparing this certificate, the evidence and detailed procedures used in establishing the corner positions and  
monumentation found or placed.)

Monument Description and Remarks: THIS CERTIFICATE HAS BEEN PREPARED BECAUSE  
THERE ARE NONE OF RECORD FOR THESE CORNERS.

## PLAN - VIEW

(Show a minimum of three reference ties to durable physical objects, relevant monuments and physical conditions that will  
enable recovery of the corner.)

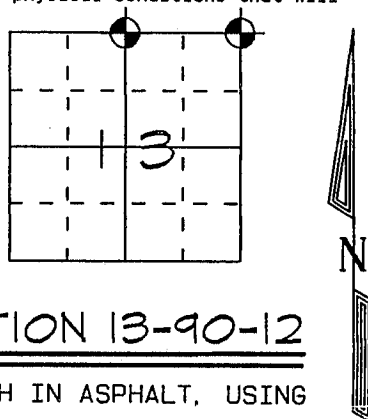

CROPS

SET 1/2" REBAR  
AS REFERENCE TIE

CUT 'X' IN  
14" RCP

## NE CORNER SECTION 13-90-12

FOUND 1/2" IRON BAR, FLUSH IN ASPHALT, USING  
COUNTY ENGINEER TIES

SET 1/2" REBAR, 0.25' DEEP IN SIDE SLOPE  
AS REFERENCE TIE

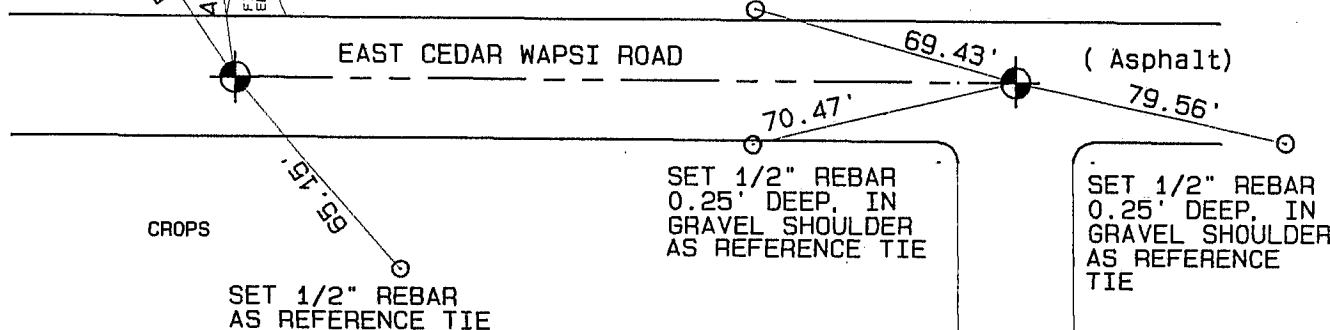

CROPS

SET 1/2" REBAR  
AS REFERENCE TIE

SET 1/2" REBAR  
0.25' DEEP, IN  
GRAVEL SHOULDER  
AS REFERENCE TIE

SET 1/2" REBAR  
0.25' DEEP, IN  
GRAVEL SHOULDER  
AS REFERENCE  
TIE

## N 1/4 CORNER SECTION 13-90-12

FOUND 1/2" IRON BAR, FLUSH IN ASPHALT, USING  
COUNTY ENGINEER TIES

Certification: I hereby certify that this land surveying  
document was prepared and the related survey work was  
performed by me or under my direct personal supervision and  
that I am a duly licensed Land Surveyor under the laws  
of the State of Iowa

Robert L. Stumbo, Jr. License #6586  
My license renewal date is December 31, 2000

SEAL

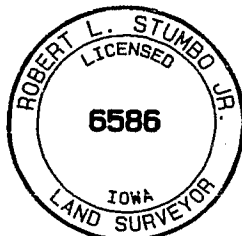

## List Corners to be Indexed

Corners	Section	Twp	Range
N 1/4 COR.	13	90 N	12 W
NE COR.	13	90 N	12 W

JOB NO. 14364

BOOK 334 PAGE 930