

PREPARED BY PATRICK SHEPARD: CIVIL ENGINEERING CONSULTANTS, INC. - 2400 86th ST. #12 -DES MOINES, IOWA 50322

UNITED STATES PUBLIC LAND SURVEY CORNER CERTIFICATE OF

LAND SURVEY MONUMENTS SITUATED IN SECTION 29, TOWNSHIP 90 NORTH, RANGE 11 WEST, OF THE FIFTH PRINCIPAL MERIDIAN, BLACK HAWK COUNTY, IOWA. PREVIOUS RECORD FOUND AT THE BLACK HAWK COUNTY RECORDER'S OFFICE IN BOOK 333 MISC. PAGE 276.

MONUMENT DESCRIPTION AND REMARKS:

E 1/4 CORNER, 29-90-11. PREVIOUS RECORD INDICATES A 2" BRASS CAP WITH "X". FOUND CUT "X" IN CENTERLINE OF ROAD. THIS CERTIFICATE IS BEING PREPARED TO DOCUMENT MONUMENTATION FOUND AND ACCEPTED AS THE E 1/4 CORNER AND TO PROVIDE TIES.

PLAN -VIEW

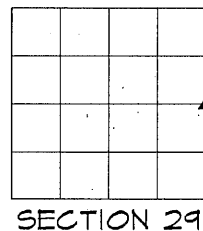
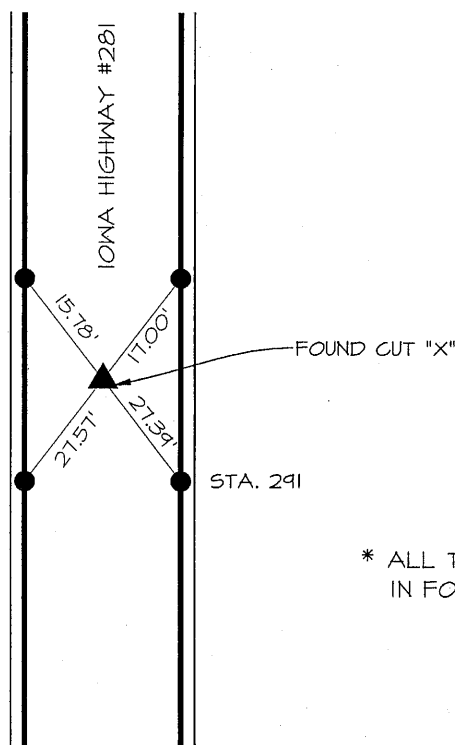

* ALL TIES ARE CUT "X"
IN FOG LINE

LIST CORNERS TO BE INDEXED

| CORNERS | SECTION | TWP. | RANGE |
|--------------|---------|------|-------|
| E 1/4 CORNER | 29 | 90 | 11 |
| W 1/4 CORNER | 28 | 90 | 11 |

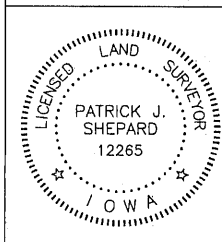

I HEREBY CERTIFY THAT THIS LAND SURVEYING DOCUMENT WAS PREPARED AND THE RELATED SURVEY WORK WAS PERFORMED BY ME OR UNDER MY DIRECT PERSONAL SUPERVISION AND THAT I AM A DULY LICENSED LAND SURVEYOR UNDER THE LAWS OF THE STATE OF IOWA.

P. J. Shepard 1-25-13
PATRICK J. SHEPARD, IOWA LICENSE NO. 12265 DATE
MY LICENSE RENEWAL DATE IS DECEMBER 31, 2013

PAGES OR SHEETS COVERED BY THIS SEAL:

THIS SHEET ONLY