

PREPARED BY PATRICK SHEPARD: CIVIL ENGINEERING CONSULTANTS, INC. - 2400 86th ST. #12 -DES MOINES, IOWA 50322

UNITED STATES PUBLIC LAND SURVEY CORNER CERTIFICATE
OF

LAND SURVEY MONUMENTS SITUATED IN SECTION 27, TOWNSHIP 90 NORTH, RANGE 11 WEST, OF THE FIFTH PRINCIPAL MERIDIAN, BLACK HAWK COUNTY, IOWA. PREVIOUS RECORD FOUND IN THE SURVEY BOOKS AT THE BLACK HAWK COUNTY ENGINEER'S OFFICE.

MONUMENT DESCRIPTION AND REMARKS:
E 1/4 CORNER, 27-90-11. PREVIOUS RECORD INDICATES CONCRETE MONUMENT WITH CAP. FOUND 1" PINCH PIPE 2' DEEP THAT MATCHES CORNER USED AS E 1/4 CORNER IN PLAT OF SURVEY IN BOOK 329 MISC. PAGE 959. THIS CERTIFICATE IS BEING PREPARED TO DOCUMENT MONUMENTATION FOUND AND ACCEPTED AS THE E 1/4 CORNER AND TO PROVIDE TIES.

PLAN -VIEW

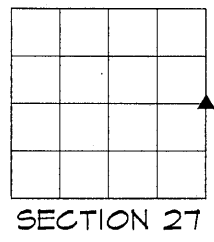
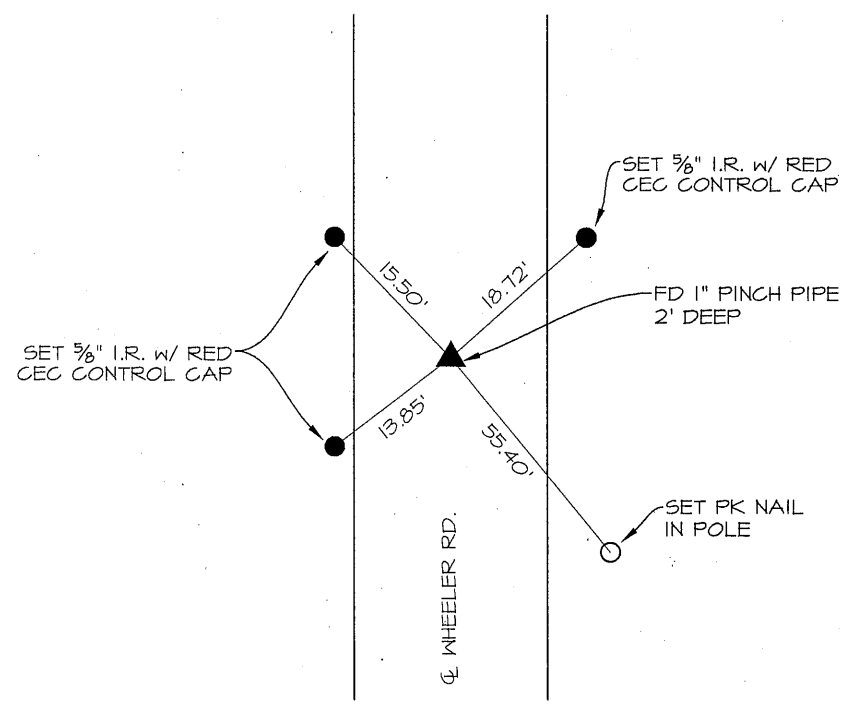

LIST CORNERS TO BE INDEXED

CORNERS	SECTION	TWP.	RANGE
E 1/4 CORNER	27	90	11
W 1/4 CORNER	26	90	11

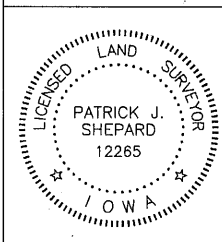

I HEREBY CERTIFY THAT THIS LAND SURVEYING DOCUMENT WAS PREPARED AND THE RELATED SURVEY WORK WAS PERFORMED BY ME OR UNDER MY DIRECT PERSONAL SUPERVISION AND THAT I AM A DULY LICENSED LAND SURVEYOR UNDER THE LAWS OF THE STATE OF IOWA.
P. Shepard 1-24-13
PATRICK J. SHEPARD, IOWA LICENSE NO. 12265 DATE
MY LICENSE RENEWAL DATE IS DECEMBER 31, 2013
PAGES OR SHEETS COVERED BY THIS SEAL:
THIS SHEET ONLY

(7.055)