

SLS19-90

# UNITED STATES PUBLIC LAND SURVEY CORNER CERTIFICATE OF

Land Survey Monuments situated in Section 6, Township 90 N, Range 11 W  
of the Fifth Principal Meridian, BLACK HAWK County, Iowa. Previously recorded  
in \_\_\_\_\_ in County Recorder's Office.

(Book, page, document number, etc.)

(Show reason for preparing this certificate, the evidence and detailed procedures used in establishing the corner positions and monumentation found or placed.)

Monument Description and Remarks: A --- CENTER STREET SIGN POST  
B --- CENTER FIBER OPTICS WARNING SIGN  
C --- CROSS NAILS IN FENCE CORNER  
D --- FOUND CONCRETE MONUMENT

## PLAN -- VIEW

(Show a minimum of three reference ties to durable physical objects, relevant monuments and physical conditions that will enable recovery of the corner.)

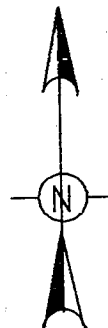
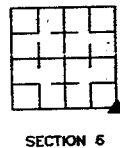
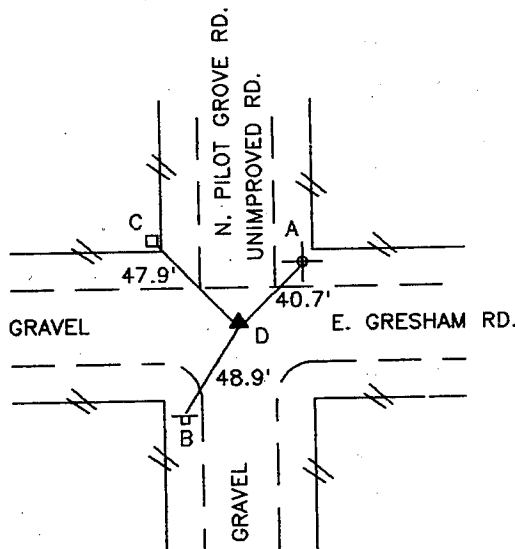

SE COR. 6 - 90 - 11

I hereby certify that this land surveying document was prepared  
by me or under my direct personal supervision and that I am a duly  
Registered Land Surveyor under the laws of the state of Iowa.

Signature: Terry D. Van Lanning  
Terry D. Van Lanning, P.L.S.

Date: Aug. 15, 1995 Reg. No. 10793  
My registration renewal date is December 31, 1995

SEAL



### List Corners to be Indexed

Corners	Section	Township	Range
SE COR.	6	90	11

SHEET 1 OF 2

**TERRY VAN LANNING P.L.S., INC.**  
WAVERLY, IOWA