

UNITED STATES PUBLIC LAND SURVEY CORNER CERTIFICATE

OF

Land Survey Monuments situated in Section 36, Township 89 North, Range 14 West, of the Fifth Principal Meridian, Black Hawk County, Iowa.
Previously recorded in Book _____, Page _____.

(Show reason for preparing this certificate, the evidence and detailed procedures used in establishing the corner positions and monumentation found or placed.)

Monument Description and Remarks: No previous ties to corner. Found monument set by Paul Helland, not original subdivision's monument. Corner is also the southeast corner of Cedar Falls Industrial Park. Found the northeast corner of the NW $\frac{1}{4}$ NW $\frac{1}{4}$, the southeast corner of Lot 4, all three points are in a line. Distance between the southeast corner and the northeast corner measures - 1324.68' (1324.82' Record).

Corner Referenced - 9/4/90

PLAN - VIEW

(Show a minimum of three reference ties to durable physical objects, relevant monuments and physical conditions that will enable recovery of the corner.)

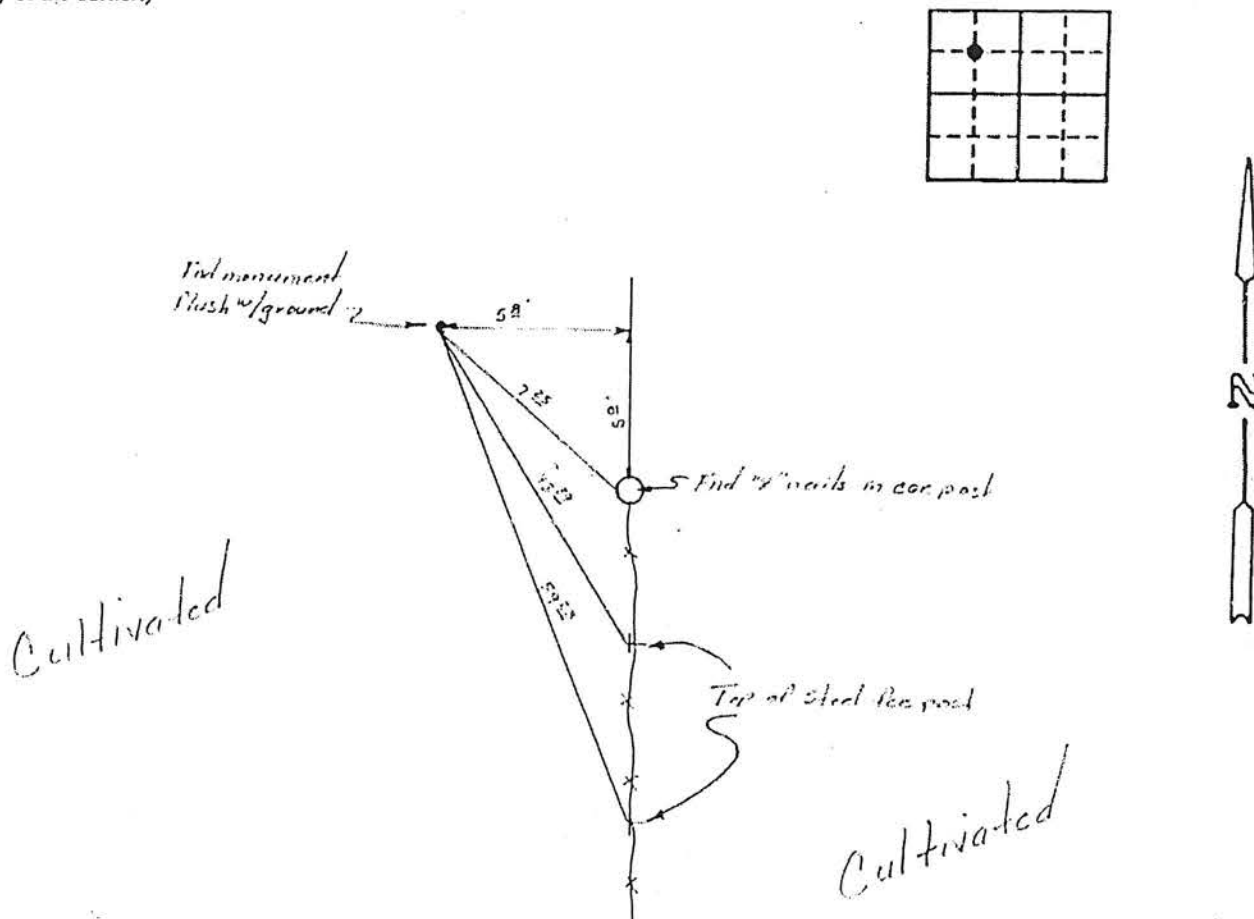

I hereby certify that the survey work was completed and this certificate was prepared by me or under my direct personal supervision and that I am a duly registered land surveyor under the laws of the state of Iowa.

Keith E. Vlademar 9/27/90

REGISTERED LAND SURVEYOR NO. 9781

SEAL



List Corners to be Indexed

Corners	Section	Twp	Range
NW Cor	36	89	14W
SE $\frac{1}{4}$ NW $\frac{1}{4}$			