

BLACK HAWK COUNTY IOWA:SS
Filed for record NOV 12, 1999 at 4:00 PM. and recorded in Book 336 of MISC Page 412.
Catherine A. Jones Recorder
FEE 1-5.00/
PRANGE SURVEYING

UNITED STATES PUBLIC LAND SURVEY CORNER CERTIFICATE OF
Land Survey Monuments situated in Section 3, Township B9N,
Range 14 W, of the Fifth Principal Meridian, Black Hawk County, Iowa.
Previously recorded in Book , Page , in County Recorder's Office.

(Show reason for preparing this certificate, the evidence and detailed procedures used in establishing the corner positions and monumentation found or placed.)

Monument Description and Remarks: Found Pinched Pipe 4" Deep

(Show a minimum of three reference ties to durable physical objects, relevant monuments and physical conditions that will enable recovery of the corner.)

NOT TO SCALE

CENTER SEC. 3-89-14

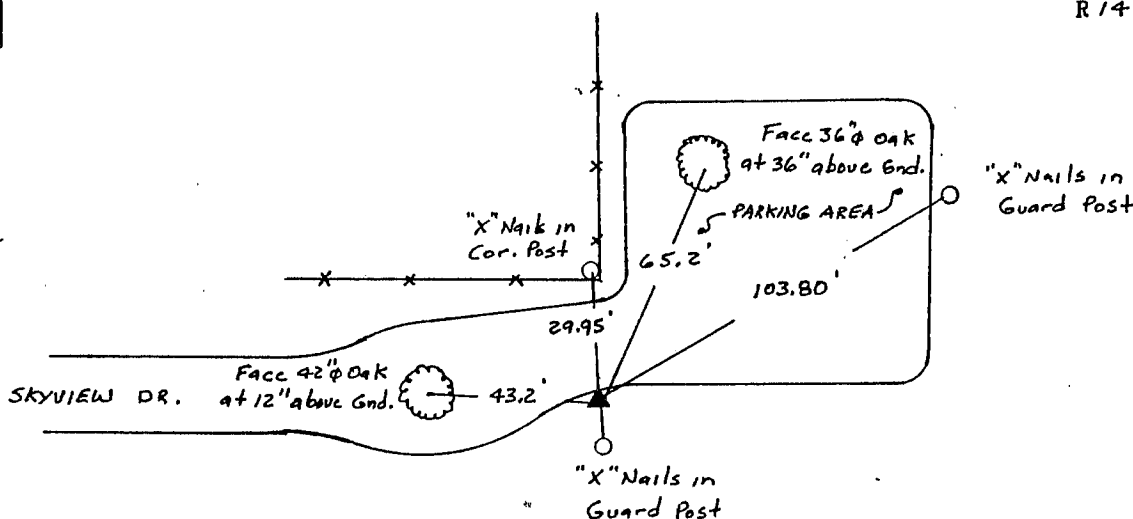
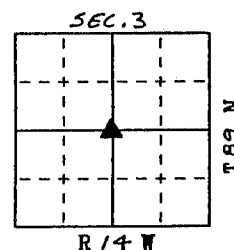

RECEIVED
BLACK HAWK COUNTY
ASSESSOR

FIELD SURVEY: Nov. 1999
PREPARED BY: Dennis R. Prange

LIST CORNERS TO BE INDEXED

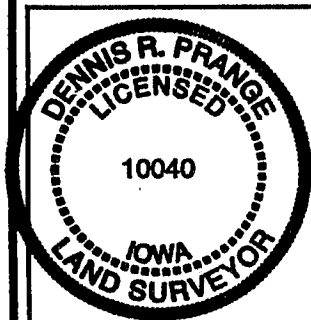

I hereby certify that this land surveying document was prepared and the related survey work was performed by me or under my direct personal supervision and that I am a duly licensed Land Surveyor under the laws of the State of Iowa.

Dennis B. Prange NOV. 12, 1999
(date)

License Number 10040

My license renewal date is December 31, 2000

Pages or sheets covered by this seal:

This Land Corner Certificate Only.

<u>Corner</u>	<u>Section</u>	<u>- Township</u>	<u>- Range</u>
CENTER	3	T89N	R14W