

ENV PRANGE SURVEYING 3304 PANTHER LANE CEDAR FALLS, IC 50613

Prepared by Dennis R. Prange, L.S., Prange Surveying, 3304 Panther Lane, Cedar Falls, Iowa 50613, (319) 277-4935

UNITED STATES PUBLIC LAND SURVEY CORNER CERTIFICATE OF

Land Survey Monuments situated in Section No. 12 , Township No. 89 North, Range
No. 13 West, of the Fifth Principal Meridian, Black Hawk County, Iowa.
Previously recorded in Book N/A on Page N/A in the office of the County Recorder.
(book, page, document number, etc.)

(Show reason for preparing this certificate, the evidence and detailed procedures used in establishing the corner positions and monumentation found or placed.)

Monument Description and Remarks: Found 3/4"Ø pinched pipe 3" below asphalt surface.
This point matches property pins found along the North line of Donald Street and the
West line of Moline Road

PLAN - VIEW

(Show a minimum of three reference ties to durable physical objects, relevant monuments and physical conditions that will enable recovery of the corner.)

NOT TO SCALE

SOUTHEAST CORNER SECTION 12

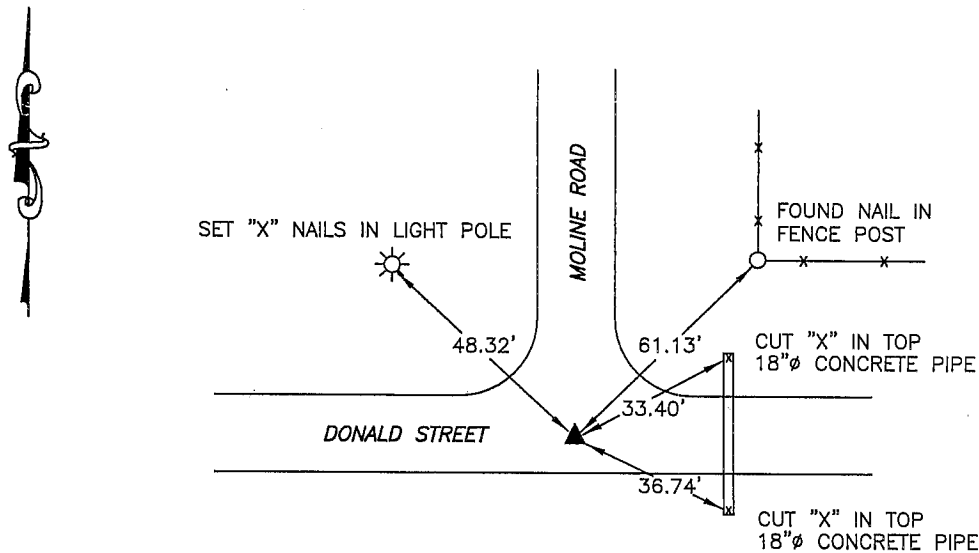
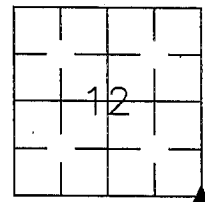

I hereby certify that this land surveying document was prepared by me or under my direct personal supervision and that I am a duly licensed Professional Land Surveyor under the laws of the State of Iowa.

Signed: Dennis R. Prange
Dennis R. Prange, L.S. Iowa License No. 10040

Date: August 31 , 2004

SEAL

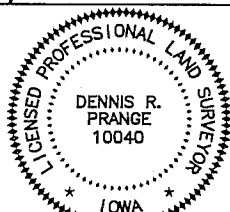

My License renewal date is December 31, 2004.
Pages or sheets covered by this seal : this page only

Corners	List Corners to be Indexed Section	Twp	Range
SOUTHEAST	12	89N	13W

Drawn by: DRP

Checked by: