

SC
Misc
INDEX
MARGIN
RECEIVED
COMPLETE

BLACK HAWK COUNTY IOWA:SS
Filed for record Dec 8, 1996
at 4:00 PM, and recorded in
Misc Book 328
Page 385

11.772
County Assessor

Patricia S. Lass

RECORDER
DEPUTY

FEE 1-5.00/

WAYNE CLAASSEN ENGINEERING

WAYNE CLAASSEN ENGINEERING AND SURVEYING, INC.
P.O. BOX 898 WATERLOO, IOWA 50704-0898

PHONE: (VOICE) 319-235-6294
(FAX) 319-235-0028

UNITED STATES PUBLIC LAND SURVEY CORNER CERTIFICATE

Land Survey Monuments situated in Section 3, Township 89N, Range 13W, of the Fifth Principal Meridian, BLACK HAWK County, Iowa.
Previously recorded in N/A in County Recorder's Office.
(book, page, document number, etc.)

(Show reason for preparing this certificate, the evidence and detailed procedures used in establishing the corner positions and monumentation found or placed.)

Monument Description and Remarks WEST 1/4 COR. FOUND 3" ALUMINUM DISK IN
CITY PARKING. CES LOCATED STD CONC. MONUMENT AT THIS LOCATION PRIOR
TO CITY PARKING PROJECT 1X-6589(1)--79-07 IN 1983.

PLAN - VIEW

(Show a minimum of three reference ties to durable physical objects, relevant monuments and physical conditions that will enable recovery of the corner.)

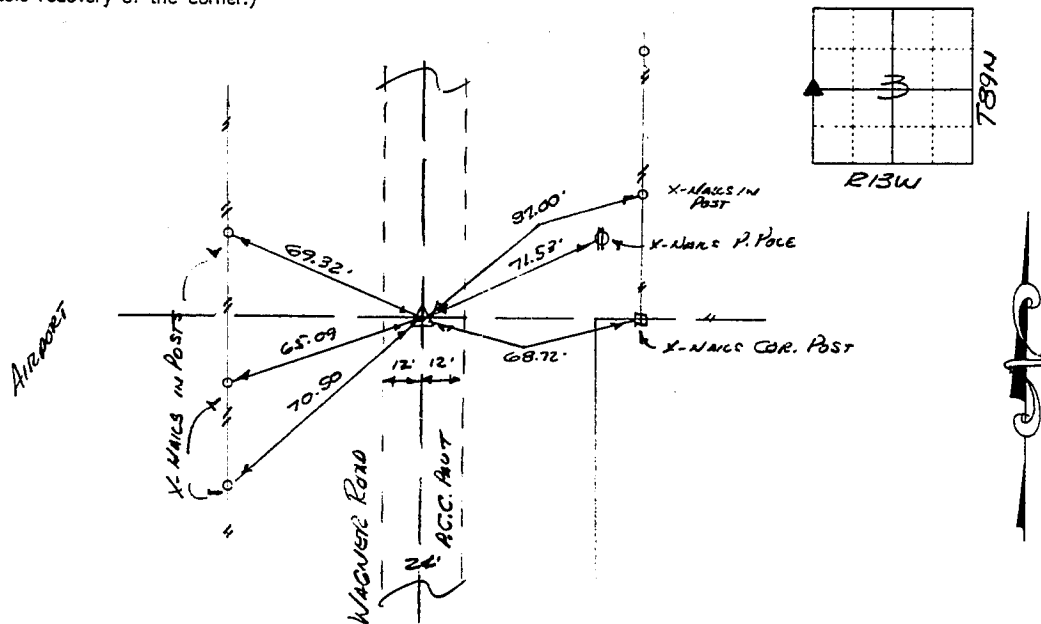

412-66

I hereby certify that the survey work was completed and this certificate was prepared by me or under my direct personal supervision and that I am a duly licensed land surveyor under the laws of the state of Iowa.

Signature: F. Williams
(Name typed or printed: F. Williams)

Date: 12-5-1997 Lic. No. 8033

SEAL

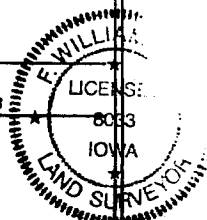

List Corners to be Indexed

Corners	Section	Twp	Range
K1/4	3	89N	13W

BOOK 328 PAGE 385