

SC  
MISC  
INDEX  
MARGIN  
PROOF  
COMPARE

BLACK HAWK COUNTY IOWA:SS  
Filed for record Jun 24, 19 98 at  
2:00 P .M. and recorded in Book 330  
of MISC Page 589  
Catherine J. Sess Recorder  
FEE 1-5.00/  
WAYNE CLAASSEN ENGINEERING AND SURVEYING INC

WAYNE CLAASSEN ENGINEERING AND SURVEYING, INC.  
P.O. BOX 898 WATERLOO, IOWA 50704-0898

PHONE: (VOICE) 319-235-6294  
(FAX) 319-235-0028

## UNITED STATES PUBLIC LAND SURVEY CORNER CERTIFICATE

Land Survey Monuments situated in Section 2, Township 89N, Range 13W, of the Fifth Principal Meridian, BLACK HAWK County, Iowa.  
Previously recorded in N/A BK 328 p. 294 M.T. in County Recorder's Office.  
(book, page, document number, etc.)

(Show reason for preparing this certificate, the evidence and detailed procedures used in establishing the corner positions and monumentation found or placed.)

Monument Description and Remarks FOUND 5/8" P REBAR IN P.C.C. PAVING @ S 1/4 COR. AS  
RESET BY CITY OF WATERLOO AFTER 1997 PAVING PROJECT. THE CONCRETE MONUMENT  
REFERENCE POINTS ARE THOSE SET BY IOWA HIGHWAY COMMISSION FOR IOWA HIGHWAY NO. 57.  
THIS POINT WAS VERIFIED DURING PLATTING OF AEROSTAT HEIGHTS SUBDIVISION BY  
CLAASSEN ENGINEERING IN 1978.

### PLAN - VIEW

(Show a minimum of three reference ties to durable physical objects, relevant monuments and physical conditions that will enable recovery of the corner.)

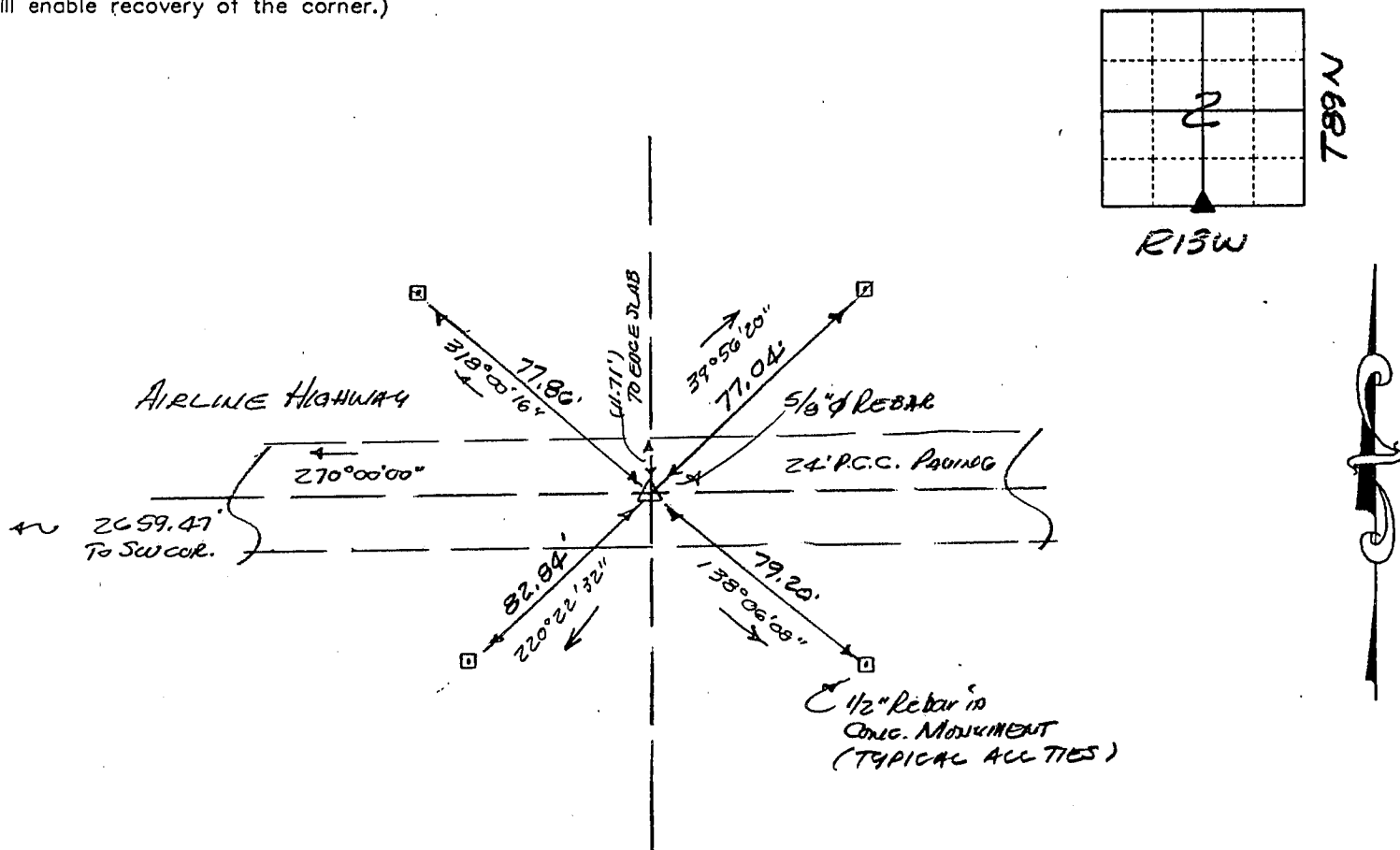

416-56

I hereby certify that the survey work was completed and this certificate was prepared by me or under my direct personal supervision and that I am a duly licensed land surveyor under the laws of the state of Iowa.

Signature: F. William King

(Name typed or printed:) F. WILLIAM KING

Date: 6-24-1998 Lic. No. 8033

SEAL

#### List Corners to be Indexed

Corners	Section	Twp	Range
<u>S 1/4</u>	<u>2</u>	<u>89N</u>	<u>13W</u>

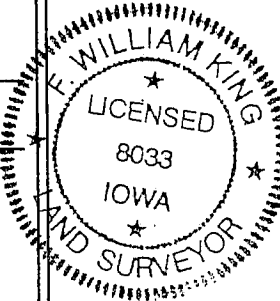

BOOK 330 PAGE 589