



Doc ID: 004573210001 Type: GEN
Kind: CORNER
Recorded: 09/12/2011 at 01:02:30 PM
Fee Amt: \$7.00 Page 1 of 1
Black Hawk County Iowa
JUDITH A MCCARTHY RECORDER
File **2012-00004491**

Recorded By: Michael R. Fagle, P.L.S.

* AECOM, 501 Sycamore St., Suite 222, Waterloo, Iowa 50703

I-319-232-6531

UNITED STATES PUBLIC LAND SURVEY CORNER CERTIFICATE OF

Land Survey Monuments situated in Section 34, Township 89 North,
Range 12 West, of the Fifth Principal Meridian, Black Hawk
County, Iowa. Previously recorded in Miscellaneous Book 342 Page 701
in County Engineer's Office. (Book, Page, Document Number, etc.)

(Show reason for preparing this certificate, the evidence and detailed procedures used in establishing the corner positions and monumentation found or placed.)

Monument Description and Remarks: Found 1/2" rebar at the North 1/4
corner Section 34, Township 89 North, Range 12 West of the 5th P.M.,
after the Black Hawk County Osage Road Improvements Project
(L-0913--73-07) was completed, which required 19" of granular and hot
mix asphalt, a 1/2" x 24" rebar was set with a yellow plastic cap no. 8508.

PLAN - VIEW

(Show a minimum of three reference ties to durable physical objects, relevant monuments and physical conditions that will enable recovery of the corner.)

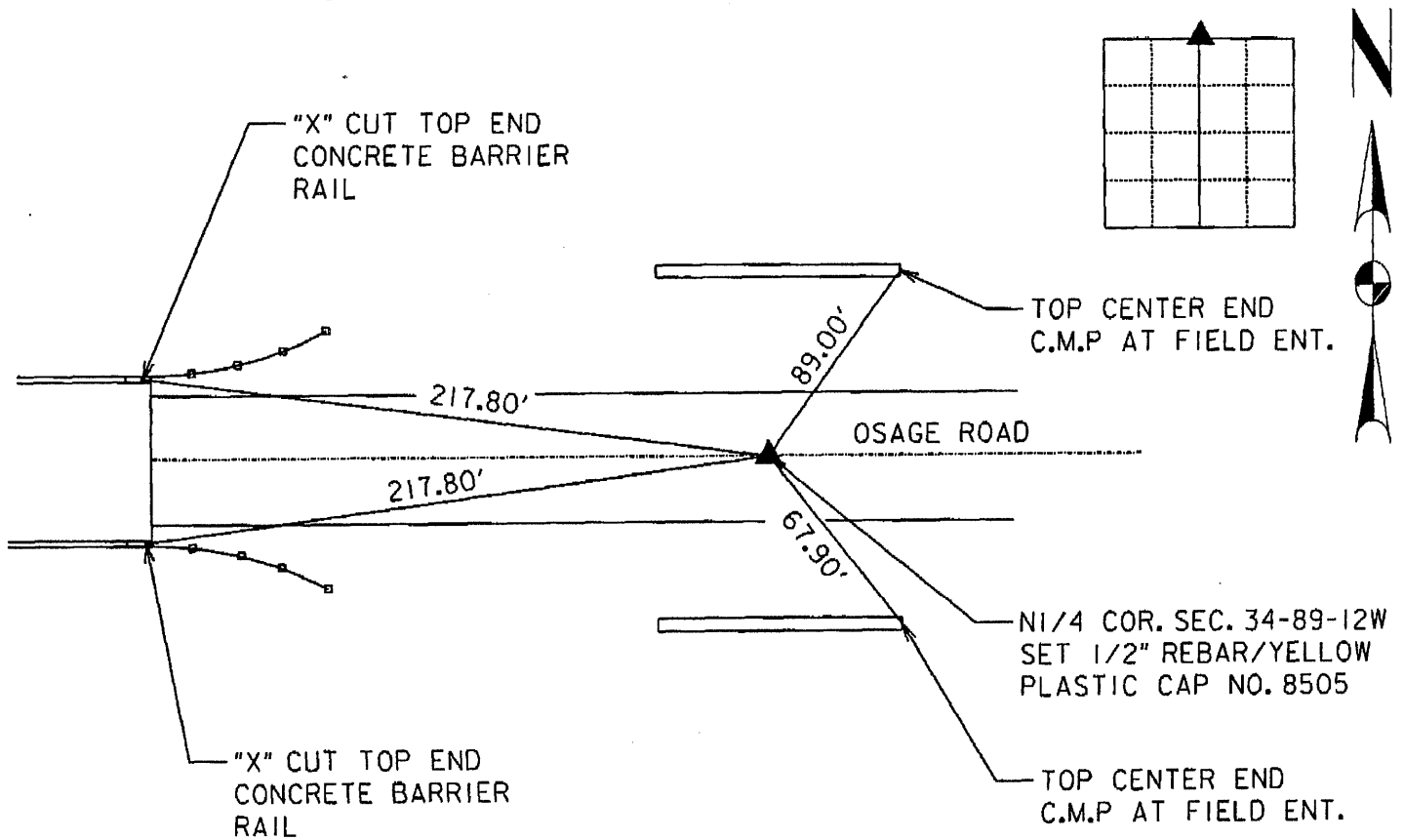

	<p>I hereby certify that this Land Surveying document was prepared by me or under my direct personal supervision and that I am a duly Licensed Land Surveyor under the laws of the State of Iowa.</p> <p><u>Michael R. Fagle</u> 9-06-2011 MICHAEL R. FAGLE Date</p> <p>License number 8505</p> <p>My license renewal date is December 31, 2012</p> <p>Pages or sheets covered by this seal:</p> <p>THIS SHEET</p>	<p>List Corners to be Indexed</p> <table border="1"><thead><tr><th>Corners</th><th>Section</th><th>Twp</th><th>Range</th></tr></thead><tbody><tr><td>North 1/4 Corner</td><td>34</td><td>T 89 N</td><td>R 12 W</td></tr></tbody></table>				Corners	Section	Twp	Range	North 1/4 Corner	34	T 89 N	R 12 W
	Corners	Section	Twp	Range									
North 1/4 Corner	34	T 89 N	R 12 W										