

Prepared By: Matthew A. Kofta, P.L.S., VJ Engineering, 1501 Technology Parkway, Suite 100, Cedar Falls, Iowa, 50613, (319) 266-5829  
Return To: Matthew A. Kofta, P.L.S., VJ Engineering, 1501 Technology Parkway, Suite 100, Cedar Falls, Iowa, 50613, (319) 266-5829

## United States Public Land Survey Corner Certificate of

Land Survey Monuments situated in Section No. 33, Township No. 89 North,  
Range No. 12 West, of the Fifth Principal Meridian, Black Hawk County, Iowa  
Previously recorded in File No. 2012-4489.

Show reason for preparing this certificate, the evidence and detailed procedures used in establishing the corner positions and monumentation found or placed.

Monument Description and Remarks: North 1/4 Corner -- Section 33 - T89N - R12W

Previous corner certificate indicates that the corner is monumented with a 1/2"Ø x 24" rebar with a Yellow plastic cap PLS #8505.

Searched area and found 1/2"Ø rebar with a damaged yellow cap, accepted and used found rebar as the corner.

This corner certificate is being prepared to update the reference ties.

### PLAN - VIEW

(Show a minimum of three reference ties to durable physical objects, relevant monuments and physical conditions that will enable recovery of the corner.)

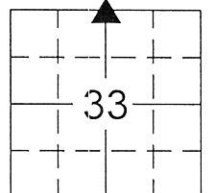
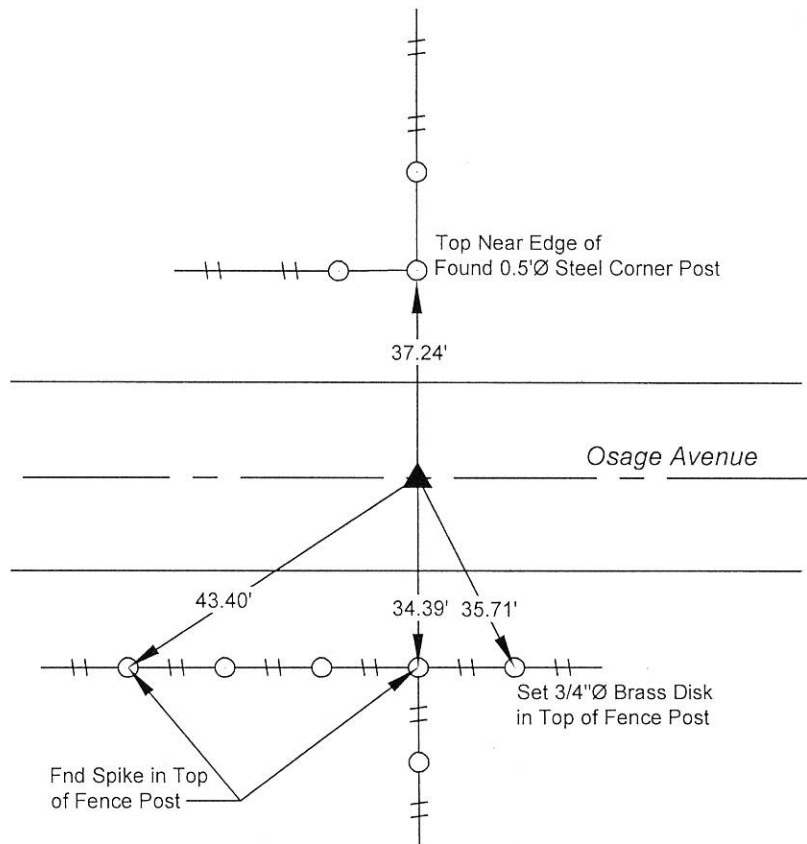

#### LEGEND

- Found Section Corner
- Set Section Corner
- Set 5/8"Ø x 24" Rebar w/ Orange Cap Iowa P.L.S. #22561
- Power Pole
- Fence Line
- Fence Corner
- Fence Post
- Light Pole
- Trees Decid. / Conif.
- Telephone Pedestal
- Concrete Reference Monument

I hereby certify that this land surveying document was prepared and the related survey work was performed by me or under my direct personal supervision and that I am a duly licensed Land Surveyor under the laws of the State of Iowa.



Matthew A. Kofta  
Matthew A. Kofta, P.L.S.  
License Number 22561  
My license renewal date is December 31, 2020  
Pages or sheets covered by this seal: 1

#### List Corner to be Indexed

Corner	Section	Twp	Range
North 1/4	33	89 N	12 W



VJ Engineering  
1501 Technology Parkway  
Cedar Falls, Iowa - 319-266-5829

Section Corner  
Reference Ties

file no.  
198025  
drawn by  
RAW  
date  
8/27/19