

# UNITED STATES PUBLIC LAND SURVEY CORNER CERTIFICATE

OF

Land Survey Monuments situated in Section 21, Township 89 N, Range 12 W, of the Fifth Principal Meridian, BLACK HAWK County, Iowa.  
Previously recorded in \_\_\_\_\_ in County Recorder's Office.

(book, page, document number, etc.)

(Show reason for preparing this certificate, the evidence and detailed procedures used in establishing the corner positions and monumentation found or placed.)

Monument Description and Remarks: ALUMINUM CAP ATTACHED TO 5/8" X 30"

IRON BAR EPOXIED IN CONCRETE AT CENTERLINE ELK RUN ROAD

## PLAN - VIEW

(Show a minimum of three reference ties to durable physical objects, relevant monuments and physical conditions that will enable recovery of the corner.)

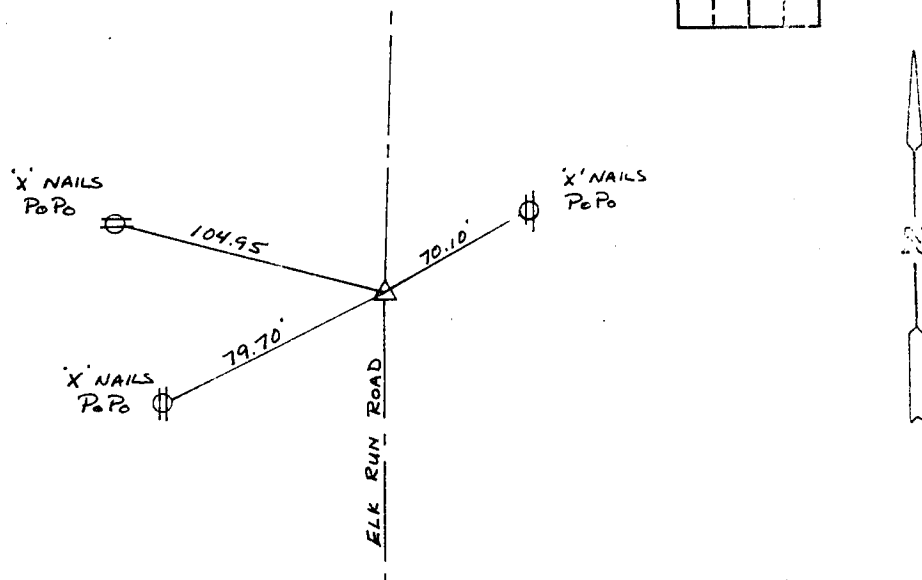

I hereby certify that the survey work was completed and this certificate was prepared by me or under my direct personal supervision and that I am a duly registered land surveyor under the laws of the state of Iowa.

Signature: Michael R. Eagle

Name typed or printed: MICHAEL R. EAGLE

Date: 5-4-97 Reg. No. 8505

SEAL



Corners	List Corners to be Indexed Section	Twp	Range
E. 1/4 COR	21	89 N	12 W