

UNITED STATES PUBLIC LAND SURVEY CORNER CERTIFICATE

OF

Land Survey Monuments situated in Section 36, Township 89 N, Range 11 W, of the Fifth Principal Meridian, BLACK HAWK County, Iowa. Previously recorded in N/A in County Recorder's Office.

(book, page, document number, etc.)

(Show reason for preparing this certificate, the evidence and detailed procedures used in establishing the corner positions and monumentation found or placed.)

Monument Description and Remarks: FOUND CHISELED "X" IN CONC. SLAB
UNDER 6" OF ASPHALT. SET P-K NAIL IN SURFACE OF
ASPHALT.

PLAN - VIEW

(Show a minimum of three reference ties to durable physical objects, relevant monuments and physical conditions that will enable recovery of the corner.)

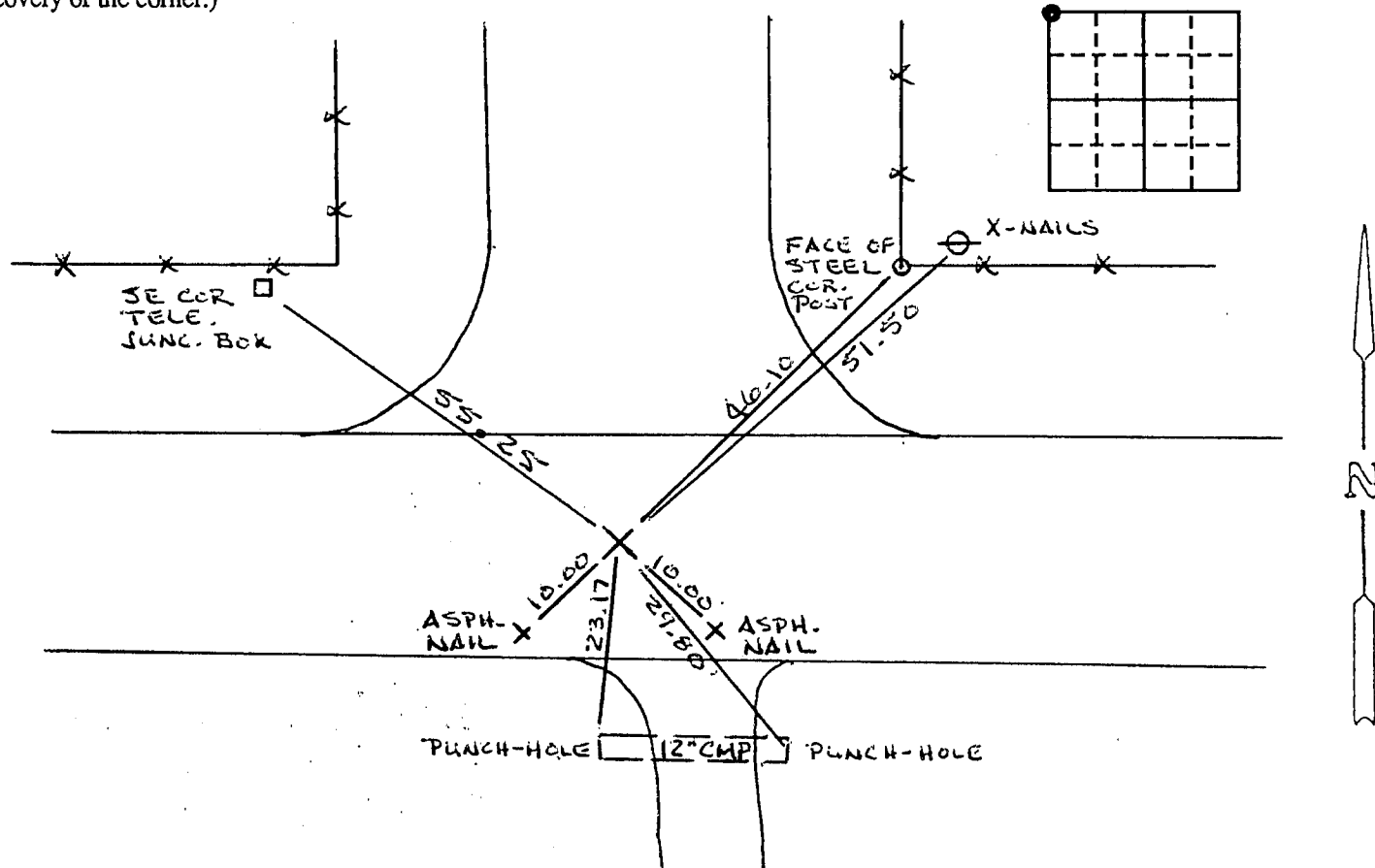

I hereby certify that the survey work was completed and this certificate was prepared by me or under my direct personal supervision and that I am a duly registered land surveyor under the laws of the state of Iowa.

Signature: Wm H Robinson
Name typed or printed: WM. H. ROBINSON

Date: March 27, 1991 Reg. No. 2697

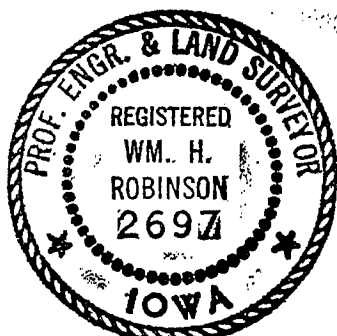

SEAL

Corners	List Corners to be Indexed		
	Section	Twp	Range
NW	36	89N	11W

MISC. BK 295 p. 230