

PREPARED BY & RETURN TO ERIC MILLER, SNYDER & ASSOCIATES, INC. 2727 SW SNYDER BLVD, ANKENY, IOWA 50023 (515) 964-2020

Land Survey Monuments situated in Section 22, Township 89, Range 11 W, of the Fifth Principal Meridian, BLACK HAWK, County, Iowa. Previously recorded in N/A in County Recorder's Office.  
(book, page, document number, ect.)

(Show reason for preparing this certificate, the evidence and detailed procedures used in establishing the corner positions and monumentation found or placed.)

## Monument Description and Remarks:

NO PREVIOUS RECORDED CERTIFICATE WAS FOUND. SEARCHED AREA USING METAL DETECTOR AND VISUAL SEARCH OF THE AREA AND FOUND NOTHING. VERIFIED MONUMENT WITH SURROUNDING FIELD EVIDENCE AND ESTABLISHED MONUMENT AT THEORETICAL POSITION USING SINGEL PROPORTIONATE MEASUREMENT BETWEEN THE SOUTHWEST AND SOUTH 1/4 CORNERS. SET MAG NAIL AS SECTION CORNER. THIS CERTIFICATE IS BEING FILED BECAUSE THERE IS NO CERTIFICATE FOR THE CORNER ON FILE.

### Plan-View

(Show a minimum of three reference ties to durable physical objects, relevant monuments and physical conditions that will enable recovery of the corner.)

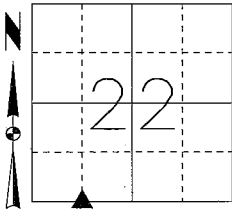

SE CORNER SW1/4-SW1/4  
SET MAG NAIL AT SURFACE

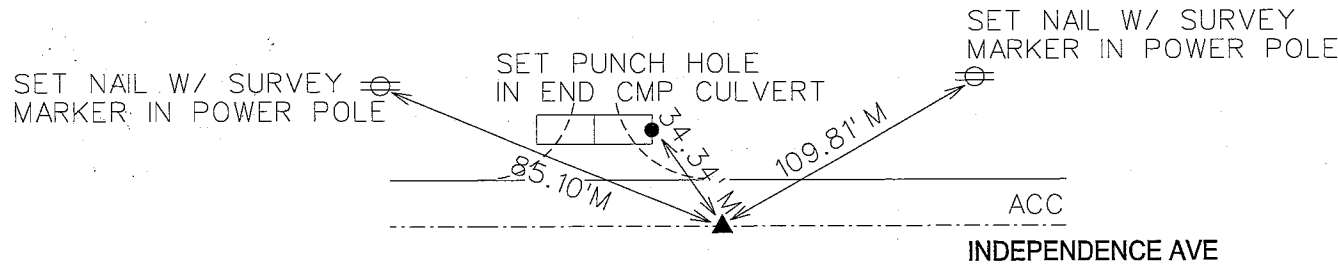

NOTE: ALL DISTANCES MEASURED HORIZONTAL UNLESS OTHERWISE NOTED.

S&A SET C1

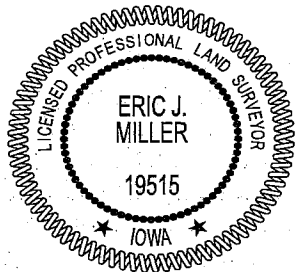

I hereby certify that this land surveying document was prepared and the related survey work was performed by me or under my direct personal supervision and that I am a duly licensed Professional Land Surveyor under the laws of the State of Iowa.

State of Iowa.  
Eric J. Miller, PLS  
Date

License Number 19515  
My License Renewal Date is December 31, 2022

Pages or sheets covered by this seal:  
SHEET 1 OF 1

## List Corners to be Indexed

Corners	Section	Twp	Range
SE COR SW1/4-SW1/4	22	89	11
NE COR NW1/4-NW1/4	27	89	11

TECH: SRM/EJM PN: 89-22-11-SWSWSW 121.1108 DATE: 12/21/21