



Doc ID: 011927570001 Type: GEN  
Recorded: 04/13/2023 at 11:09:21 AM  
Fee Amt: \$7.00 Page 1 of 1  
Black Hawk County Iowa  
SANDIE L. SMITH RECORDER

File **2023-00013804**

\* WAYNE CLAASSEN ENGINEERING AND SURVEYING, INC.  
P.O. BOX 898 WATERLOO, IOWA 50704-0898

PHONE: (VOICE) 319-235-6294  
(FAX) 319-235-0028

## UNITED STATES PUBLIC LAND SURVEY CORNER CERTIFICATE

Land Survey Monuments situated in Section 19, Township 89 North, Range 11 West, of the Fifth Principal Meridian, Black Hawk County, Iowa.

Previously recorded in Misc. Book 292, Page 31 in County Recorder's Office.  
(book, page, document number, etc.)

### Monument Description and Remarks

Went to location of corner and found concrete nail at intersection of Independence Avenue and Pilot Grove Road. (Please note that on corner certificate in Misc. Book 292, Page 31, shows both the S 1/4 Corner and the SW Corner. The labels should be reversed.)

### Reason for filing certificate:

- ☐ There is no certificate on file with the Recorder's Office.  
☐ Accepts corner position which differs from the one shown in above document.  
☐ The corner monument was replaced or modified.  
☒ The reference ties in above document were incorrect or missing.

### PLAN - VIEW

000.00 DENOTES RECORD DIMENSION FROM  
DOC. No. 2015-07804

(000.00) DENOTES FIELD DIMENSION

S 1/4 CORNER  
SEC. 19-T89N-R11W  
(FOUND IDOT NAIL)  
DOC. No. 2016-00193

FOUND  
R.R. RAIL

E 1/4 CORNER  
SEC. 19-T89N-R11W  
(FOUND PIN & ALUM.  
CAP #19957)  
DOC. No. 2012-01172

SE CORNER  
SEC. 19-T89N-R11W  
(FOUND CONC. NAIL)

SET MAG NAIL &  
WASHER #16775  
IN WOOD POWER POLE

15" ASH TREE

S 1/4 CORNER  
SEC. 20-T89N-R11W  
(FOUND NAIL)  
MISC. 292-31

2655.05'  
(2655.06')

Independence Ave.

(12') (260.00')  
260.04'

2655.05'  
(2654.91')

FOUND  
MAG NAIL

Pilot Grove Rd

SET MAG NAIL &  
WASHER #16775  
IN WOOD POWER POLE

Iowa State Plane Coordinate System  
(North Zone, 2011 Adj.)  
N= 3647201.2  
E= 5277199.7  
(for location purposes only)

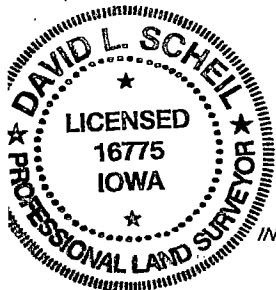

SET MAG NAIL &  
WASHER #16775  
IN WOOD POWER POLE

I hereby certify that this land surveying document was prepared and the related survey work was performed by me or under my direct personal supervision and that I am a duly Licensed Land Surveyor under the laws of the State of Iowa.

Signature: David L. Scheil  
David L. Scheil, L.S.

Date: APRIL 10, 2023 Lic. No. 16775

Pages or Sheets Covered by this Seal: THIS SHEET ONLY.

My license renewal date is December 31, 2024

SEAL

### List Corners to be Indexed

| Corners    | Section | Twp  | Range |
|------------|---------|------|-------|
| SE Corner, | 19      | 89 N | 11 W  |
| SW Corner, | 20      | 89 N | 11 W  |
| NE Corner, | 30      | 89 N | 11 W  |
| NW Corner, | 29      | 89 N | 11 W  |

700V JM

(7)