

SC  
INDEX  
MARGIN  
PROOF  
COMPARE

BLACK HAWK COUNTY IOWA:SS 8214  
Filed for record OCT 7, 1999 at  
3:00 PM. and recorded in Book 335  
of MISC Page 958.  
*Christine J. Jess* Recorder  
FEE 1-5.00/  
S & S LAND SURVEYING INC  
PO BOX 148  
WAVERLY IA 50677

RECEIVED - BLACK HAWK COUNTY

PREPARED BY - S & S LAND SURVEYING, INC., 118 W BREMER AVE., PO BOX 148, WAVERLY, IOWA 50677 - PHONE 319-352-9444

## UNITED STATES PUBLIC LAND SURVEY CORNER CERTIFICATE

OF

Land Survey Monuments situated in Section 28, Township 88 NORTH, Range 14 WEST, of the Fifth Principal Meridian, BLACK HAWK County, Iowa.  
Previously recorded in Book \_\_\_\_\_, Page \_\_\_\_\_.

CORNER WAS LOCATED FOR LAND SURVEY IN AUDITOR SEARS' PLAT OF HUDSON HEIGHTS. CORNER WAS LOCATED USING DIMENSIONS ON PLAT.

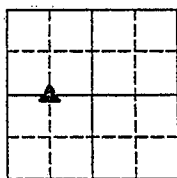

### PLAN-VIEW

NO SCALE

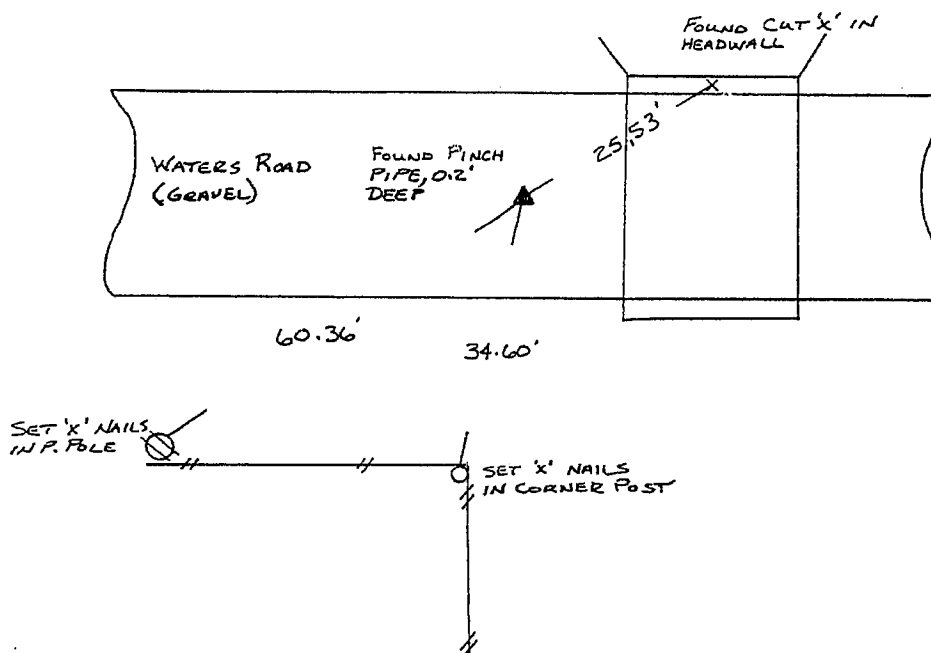

I hereby certify that this land surveying document was prepared and the related survey work was performed by me or under my direct personal supervision and that I am a duly Licensed Professional Land Surveyor under the laws of the State of Iowa.

*Scott A. Steinfadt*

Scott A. Steinfadt, P.L.S.

Iowa License No. 14577

My License Renewal Date is Dec. 31, 2000.

10/7/99  
date

#### List Corners to be Indexed

Corners	Section	Twp	Range
SW, SE 1/4, NW 1/4	28	88N	14W

S & S  
LAND SURVEYING, INC.

118 W. BREMER AVE., PO BOX 148  
WAVERLY, IOWA 50677  
(319) 352-9444

