



Doc ID: 005284380001 Type: GEN
Kind: CORNER
Recorded: 09/19/2013 at 08:50:10 AM
Fee Amt: \$7.00 Page 1 of 1
Black Hawk County Iowa
JUDITH A MCCARTHY RECORDER

File 2014-00006384

WAYNE CLAASSEN ENGINEERING AND SURVEYING, INC.
P.O. BOX 898 WATERLOO, IOWA 50704-0898

PHONE: (VOICE) 319-235-6294
(FAX) 319-235-0028

UNITED STATES PUBLIC LAND SURVEY CORNER CERTIFICATE

Land Survey Monuments situated in Section 02, Township 88 North, Range 14 West, of the Fifth Principal Meridian, Black Hawk County, Iowa.

Previously recorded in _____ (book, page, document number, etc.) in County Recorder's Office.

Monument Description and Remarks

From field notes from Black Hawk County Engineer's Office: "Dug found nothing. Est. corner by chaining. Set C.M. 12" deep using Old Chaining dist. betwn double corners of John Ball 1865. His record show 208.56." The IDOT Land Corner Survey, Project No. F-U-UG-520-6(2)--27-07 (Dated march-April 1971) shows a found valve. Found 2" diameter lead plug with 'x' that reasonably matches ties to SE Corner 36-89-14. This certificate was filed because there is no certificate on file.

000.00 DENOTES RECORD DIMENSION
(000.00) DENOTES FIELD DIMENSION

PLAN - VIEW

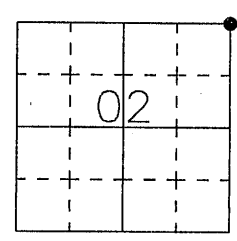

SET 'X' CUT
IN NW. CORNER OF
CONC. ON INLET

NE CORNER
SEC. 02-T88N-R14W
(FOUND 2" LEAD PLUG WITH 'X')

W. RIDGEWAY AVE.

(208.37')
208.56' WPA
208.44' IDOT

(52')

(51.62')

(104.51')

SET 'X' CUT
IN NE. CORNER OF
LIGHT POLE

SW CORNER
SEC. 31-T89N-R13W
(FOUND 1.5" LEAD PLUG)
MISC. BOOK 297-183

WEST ENTRANCE
JOHN DEERE
ENGINE WORKS

674-69

I hereby certify that this land surveying document was prepared and the related survey work was performed by me or under my direct personal supervision and that I am a duly Licensed Land Surveyor under the laws of the State of Iowa.

Signature: David L. Scheil
David L. Scheil, L.S.

Date: SEPT. 18, 2013 Lic. No. 16775

Pages or Sheets Covered by this Seal: THIS SHEET ONLY.

My license renewal date is December 31, 2014

SEAL

List Corners to be Indexed

Corners	Section	Twp	Range
NE CORNER,	02	88 N	14 W

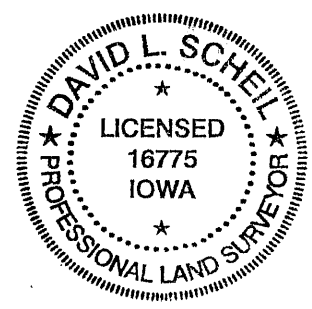

(7.00)

1