

UNITED STATES PUBLIC LAND SURVEY CORNER CERTIFICATE OF

Land Survey Monuments situated in Section 33, Township 88N, Range 13W, of the Fifth Principal Meridian, BLACK HAWK County, Iowa.
Previously recorded in _____ in County Recorder's Office.

(book, page, document number, etc.)

(Show reason for preparing this certificate, the evidence and detailed procedures used in establishing the corner positions and non-umentation found or placed.)

Monument Description and Remarks: FOUND 1" DIA. STEEL PIN GROUND LEVEL

PLAN - VIEW

(Show a minimum of three reference ties to durable physical objects, relevant monuments and physical conditions that will enable recovery of the corner.)

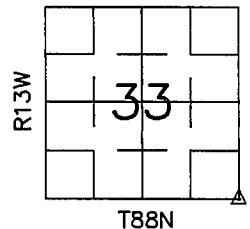
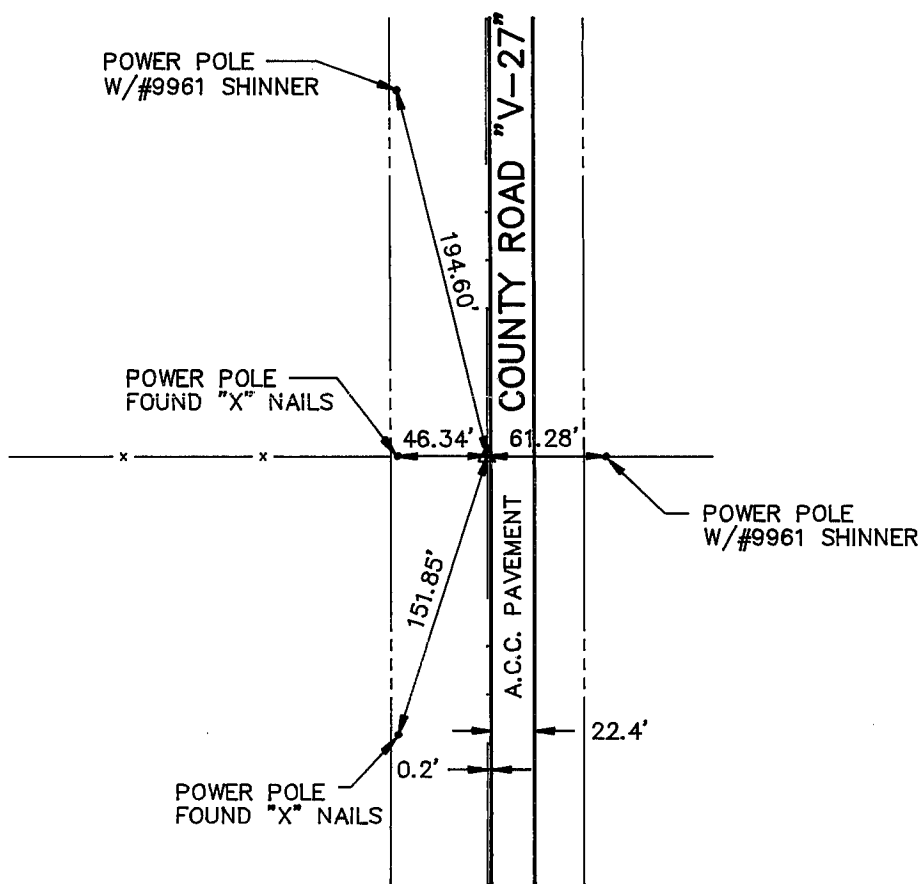

SCALE : 1" = 100'

I hereby certify that the survey work was completed and this certificate was prepared by me or under my direct personal supervision and that I am a duly registered land surveyor under the laws of the state of Iowa.

Signature: Kirk D. Eschliman
Name typed or printed: Kirk D. Eschliman

Date: 08/17/92 Reg. No. 1a, RLS. 9961
My Registration Expires: December 31, 1993

SEAL

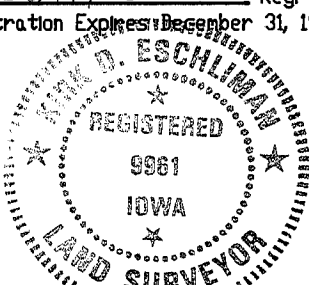

WAYNE CLAASSEN, ENGINEERING AND SURVEYING, INC.
WATERLOO, IOWA
FIELD BOOK N.N.G. 12 PROJECT NO. W.O. S42181

Corners	List Corners to be Indexed Section	Indexed Twp	Range
SE	33	T88N	R13W

(See 1997 update, per PLS#8033, BK. 323 p. 568 for NE. COR. Sect. 4-87-13)

MISC. BK. 302 p. 513