

eng
WAYNE CLAASSEN ENGINEERING AND SURVEYING, INC.
P.O. BOX 898 WATERLOO, IOWA 50704-0898

PHONE: (VOICE) 319-235-6294
(FAX) 319-235-0028

UNITED STATES PUBLIC LAND SURVEY CORNER CERTIFICATE

Land Survey Monuments situated in Section 09, Township 88 North, Range 13 West, of the Fifth Principal Meridian, Black Hawk County, Iowa.

Previously recorded in Doc. No. 2012-01314 in County Recorder's Office.
(book, page, document number, etc.)

Monument Description and Remarks

Went to location of Section Corner and did not find PK nail from above certificate. Set mag nail and washer #16775 using ties from above certificate.

PLAN - VIEW

Reason for filing certificate:

- ☐ There is no certificate on file with the Recorder's Office.
- ☐ Accepts corner position which differs from the one shown in above document.
- ☒ The corner monument was replaced or modified.
- ☐ The reference ties in above document were incorrect or missing.

000.00 DENOTES RECORD DIMENSION FROM
COR. CERT. 2012-01314

(000.00) DENOTES FIELD DIMENSION

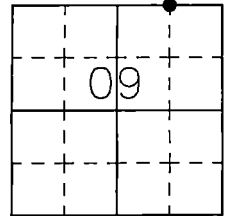

NE CORNER, NW 1/4, NE 1/4
SEC. 09-T88N-R13W
(SET MAG NAIL &
WASHER #16775)

San Marnan Drive

'X' CUT IN CONC.
IN LIGHT POLE BASE

'X' CUT IN CONC.
IN LIGHT POLE BASE

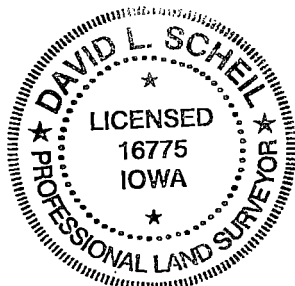

16.38'
(16.38')

'X' CUT IN CONC. MEDIAN

JOHNATHAN St.

Iowa State Plane Coordinate System
(North Zone, 2011 Adj.)
N= 3631850.7
E= 5228464.5
(for location purposes only)

I hereby certify that this land surveying document was prepared and the related survey work was performed by me or under my direct personal supervision and that I am a duly Licensed Land Surveyor under the laws of the State of Iowa.

Signature: *David L. Scheil*
David L. Scheil, L.S.

Date: DEC. 01, 2020 Lic. No. 16775

Pages or Sheets Covered by this Seal: THIS SHEET ONLY.

My license renewal date is December 31, 2020

SEAL

List Corners to be Indexed

Corners	Section	Twp	Range
NE CORNER, NW 1/4, NE 1/4,	09	88 N	13 W
SW CORNER, SE 1/4, SE 1/4,	04	88 N	13 W