

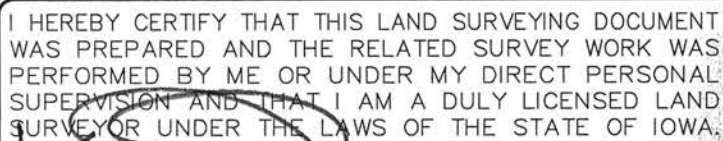



File 2013-00025977

UNITED STATES PUBLIC LAND SURVEY CORNER CERTIFICATE OF  
LAND SURVEY MONUMENTS SITUATED IN SECTION 25, TOWNSHIP 88 NORTH, RANGE 12 WEST, OF THE FIFTH PRINCIPAL  
MERIDIAN, BLACK HAWK COUNTY, IOWA.

NO CURRENT TIES IN BLACK HAWK COUNTY ENGINEERS OFFICE. FOUND 3X3 CONCRETE MONUMENT WITH BRASS CAP. MONUMENT IN 0.3 FEET ABOVE GROUND.



 DATE: 06/03/2013  
KIRK D. ESCHLIMAN, P.L.S. IOWA LIC. NO. 9961  
MY LICENSE RENEWAL DATE IS DECEMBER 31, 2013  
PAGES OR SHEETS COVERED BY THIS SIGNATURE & SEAL: SHEET 1 OF 1



CORNER	SEC.	TWP	RANGE
W 1/4 COR.	25	88	12

**KESS & ASSOCIATES, INC.**  
819 SYCAMORE ST., WATERLOO, IOWA 50703-4729 PHONE: (319) 234-0509

DATE OF FIELD WORK: 12/03/2012  
DWG. DATE: 12/03/2012 DRAWN BY: CJP  
CADD FILE: 12A51.SCTIESDWG PROJECT NO.: 12A51