

12/05/2012 (G.T.)

NOTE that BOTH the S.1/4 Corner "and" S.E. Corner were of current record at time of this Cert., per ref. in SECTION 29 and must not have researched adjoining Section(s).



Doc ID: 004953290001 Type: GEN  
Kind: CORNER  
Recorded: 10/29/2012 at 03:16:20 PM  
Fee Amt: \$7.00 Page 1 of 1  
Black Hawk County Iowa  
JUDITH A MCCARTHY RECORDER

File 2013-00008702

PREPARED BY - CLAPSADDLE-GARBER ASSOCIATES, INC, 16 EAST MAIN STREET, P.O. BOX 754, MARSHALLTOWN, IOWA 50158 - PHONE 641-752-6701

UNITED STATES PUBLIC LAND SURVEY CORNER CERTIFICATE  
OF

Land Survey Monuments situated in Section 20, Township 88 NORTH, Range 12 WEST, of the Fifth Principal Meridian, BLACKHAWK County, Iowa.  
Previously recorded in Book, Page, Instrument #

THIS CERTIFICATE WAS PREPARED BECAUSE THESE CORNERS WERE USED DURING A PLAT OF SURVEY IN SE QUARTER

SECTION 20-82-12, CORNERS WERE FOUND OR SET USING METHODS DESCRIBED BELOW.

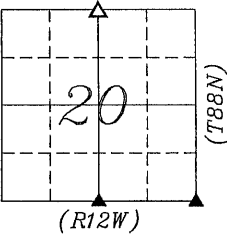

PLAN-VIEW  
NO SCALE

- LEGEND:
- ▲ GOVERNMENT CORNER MONUMENT FOUND
  - △ GOVERNMENT CORNER MONUMENT SET  
1/2" x 30" REBAR w/YELLOW PLASTIC ID CAP #15270
  - EXISTING FENCE
  - NAIL w/SM NAIL WITH SURVEY MARKER

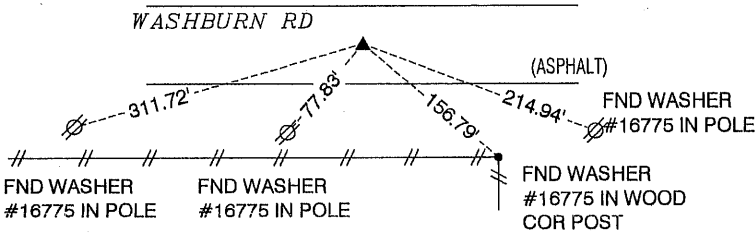

SE CORNER  
SECTION 20-88-12

FOUND ALUMINUM MONUMENT MARKED:  
BLACKHAWK COUNTY LAND CORNER.  
TIES RECOVERED FROM PREVIOUSLY  
RECORDED TIE BOOK 2005 PAGE 23274

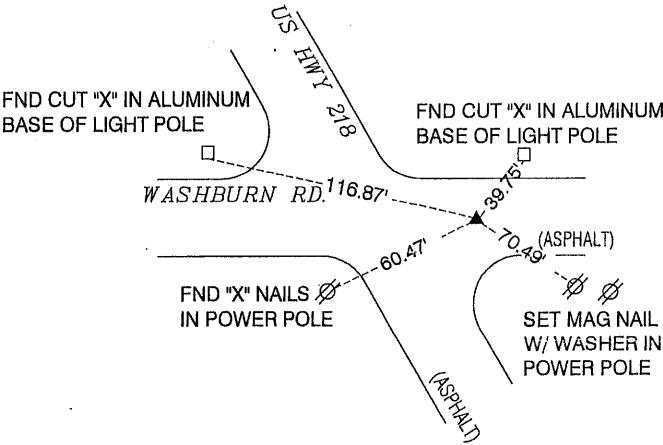

S 1/4 CORNER  
SECTION 20-88-12

FND ALUMINUM MONUMENT MARKED:  
BLACK HAWK COUNTY LAND CORNER

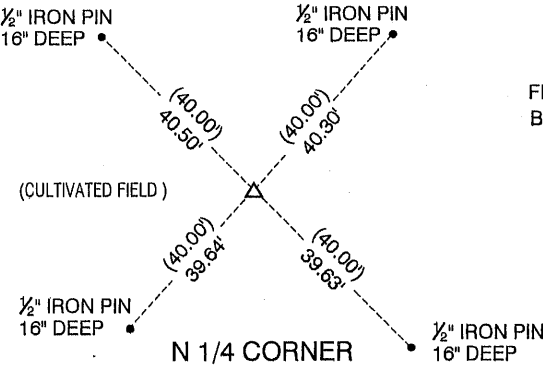

N 1/4 CORNER  
SECTION 20-88-12

SET 1/2"x30" REBAR WITH YELLOW PLASTIC CAP #15270 17" DEE P ABOVE MONUMENT  
- FOUND BOTTOM PORTION OF CONCRETE MONUMENT 5 FEET DEEP WITH 4" ABS ON TOP OF MONUMENT  
- RESET CORNER BY CROSSING FOUND TIES. DID NOT MATCH DISTANCES BUT CORNER LANDED ON BROKEN CONCRETE MONUMENT. PREVIOUSLY RECORDED BOOK 332 PAGE 549



Clapsaddle-Garber Associates, Inc  
16 East Main Street  
Marshalltown, Iowa 50158  
Ph 641 752-6701  
www.cgaconsultants.com

DRAWN  
EEA  
DATE  
10-25-12

SHEET NO.  
1  
PROJECT NO.  
76012

List Corners to be Indexed

Corners	Section	Township	Range
N 1/4 COR	20	88N	12W
S 1/4 COR	20	88N	12W
SE COR	20	88N	12W

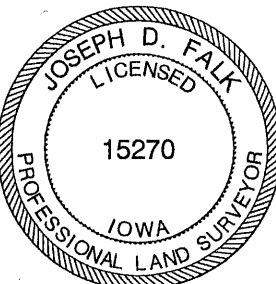

I hereby certify that this land surveying document was prepared and the related survey work was performed by me or under my direct personal supervision and that I am a duly Licensed Professional Land Surveyor under the laws of the State of Iowa.  
*Joseph D. Falk* 10-25-12  
Joseph D. Falk, PLS date  
Iowa License Number 15270  
My License Renewal Date is December 31, 2013  
Pages or sheets covered by this seal: THIS SHEET