

BLACK HAWK COUNTY ENGINEERS OFFICE

PREPARED BY: BLACK HAWK COUNTY ENGINEERS OFFICE PH.# (319) 833-3008 SLSI 9-94
316 E. FIFTH STREET, ROOM 211 WATERLOO, IOWA 50703 FAX.# (319) 833-3139 CERT 12-96

UNITED STATES PUBLIC LAND SURVEY CORNER CERTIFICATE OF
Land Survey Monuments situated in Section 18, Township 88 N,
Range 11 W, of the Fifth Principal Meridian, BLACK HAWK County, Iowa.
Previously recorded in Misc. Book 295, Page 391, in County Recorder's Office.

(Show reason for preparing this certificate, the evidence and detailed procedures used in establishing the corner positions and monumentation found or placed.)

Monument Description and Remarks: E. 1/4 SECTION 18-88-11
FOUND EXIST. CUT "X" IN C.L. PCC BRIDGE DECK (43'x30' I-BEAM), UNDER
ACC PVM'T. OVERLAY, PER RECORD PLS #7474 TIES.
OLD BRIDGE REMOVED & "NO" CORNER FOUND IN CREEK BOTTOM.
RE-EST. CUT "+" @ C.L. OF NEW 125'x30' CONTINUOUS CONC. SLAB (PCC).

PLAN - VIEW

(Show a minimum of three reference ties to durable physical objects, relevant monuments and physical conditions that will enable recovery of the corner.)

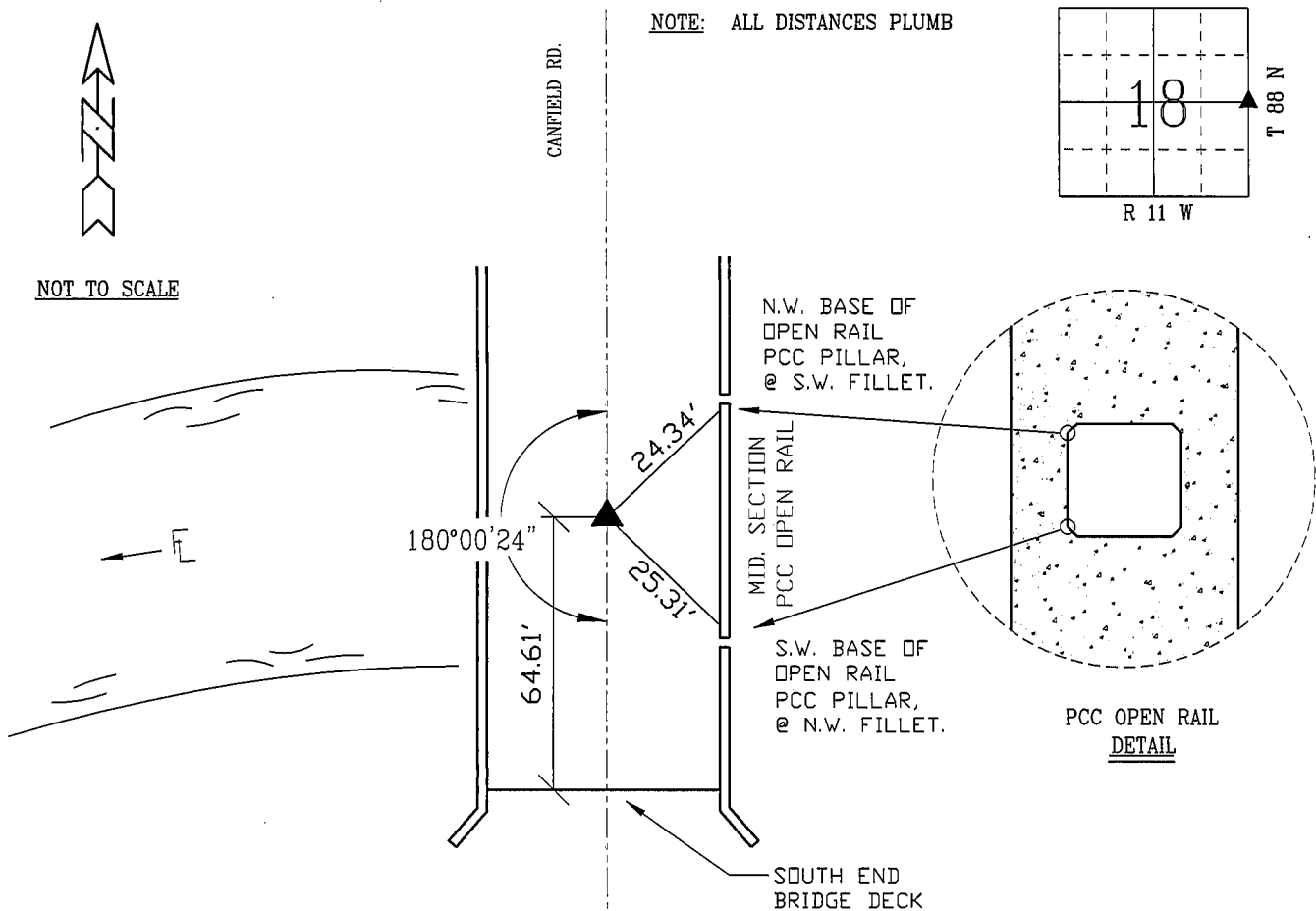

FIELD SURVEY: G.T. & M.S. 08/28/03
PREPARED BY: G.T. 09/09/03

CERTIFICATION

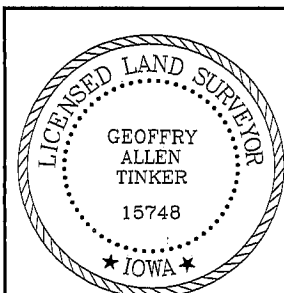

I hereby certify that this land surveying document was prepared and the related survey work was performed by me or under my direct personal supervision and that I am a duly licensed Land Surveyor under the laws of the State of Iowa.

Geoffrey C. Tinker 9/9/03
Geoffrey Allen Tinker (date)

License Number 15748

My license renewal date is December 31, 2004

Pages or sheets covered by this seal:

This Land Corner Certificate Only.

LIST CORNERS TO BE INDEXED

| Corner | Section | Township | Range |
|--------|---------|----------|-------|
| E. 1/4 | 18 | 88 N | 11 W |
| W. 1/4 | 17 | 88 N | 11 W |