

RYKEN ENGINEERING  
711 PARK AVE  
ACKLEY, IA 50601

Document Number: 2009000375  
Date: Jul 07, 2008 11:43:29 am  
Aud Fee: 0.00 Rec Fee: 10.00  
Trans Tax: 0.00 Rec Management Fee: 1.00  
E-Com Fee: 1.00 Non-Standard Page Fee: 0.00  
Filed for record in Black Hawk County, Iowa  
Judith A. McCarthy, County Recorder

Lee O. Gallentine LS, Ryken Engineering, 711 Park Avenue, Ackley, Iowa 50601 - Ph. 641-847-3273 - Fax 641-847-2303

## UNITED STATES PUBLIC LAND SURVEY CORNER CERTIFICATE OF

Land Survey Monuments situated in Section 32, Township 87 North,  
Range 14 West, of the Fifth Principal Meridian, Black Hawk County, Iowa,  
Previously recorded in Not Applicable in County Recorder's Office

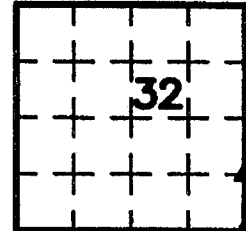

These corners were used for a survey in this section for Peggy Lee Danielsen Palma and Douglas E., Danielsen. Basis of bearing for this corner cert. can be found on the associated plat of survey filed in Co. Rec's Office for this section.

### Legend

BC = Nail with Bottle Cap	ID = Inside Diameter	R/W = Iron ROW Rail
BP = Brace Post	OD = Outside Diameter	SFP = Steel T Post
CP = Corner Post	PP = Power Pole	SW = Nail with Square Metal Washer
CMP = Corrugated Metal Pipe	PW = Nail with Plastic Washer	TP = Telephone Pedestal
CM = 4" Sq Concrete Monument with	RCP = Reinforced Concrete Pipe	TW = Nail with Round Metal Washer
1/2" Iron rod in center (tie to rered)	RH = Red Head (Nail in wire)	WFP = Wood Fence Post
CX = Cut 'X'	ROW = Right of Way	X = X Nails
GP = Gate Post	RW = Nail with Reflective Round Washer	

### SE Cor.

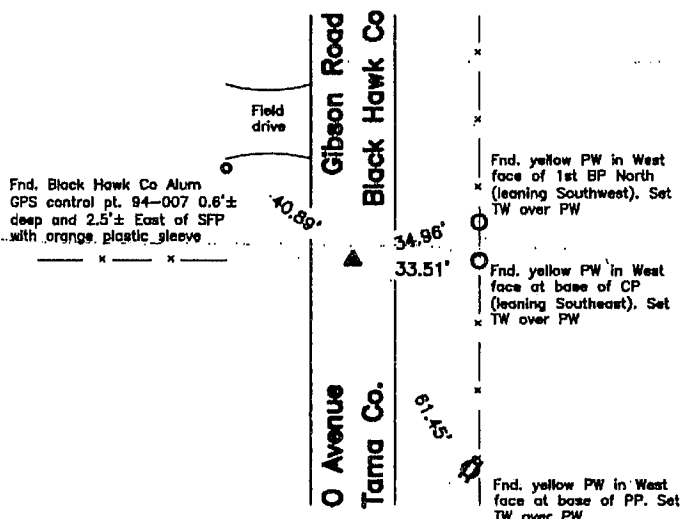

### Monument Description, Remarks, and Plan View:

SE Cor. - Partial History of Corner =

1884, Apr. 11 - "Stone & Stake" by John Ball Co Surveyor per Black Hawk Co Aud's Survey Record Bk 1 Pg 615.  
1938, Sep. 20 - "found (stone) 6" x 8" x 9" and oak hub 2" x 1 1/2" x 17" also iron bar 1/2" x 34" lowered evidence and set C.M. on top 12" under ground" per Black Hawk County Engr's WPA record Bk Pg 51.  
Previous and current Black Hawk Co Engr's ties indicate that corner is monumented with "Stone & I.B. on S. side" on Apr. 21, 1937 and "Found (stone) 6" x 9" x 8" and oak hub 2" x 1 1/2" x 17" also iron bar 1/2" x 34". Set C.M. on top 12" deep"

Corner Recovery =

Searched area with metal detector and found 6" long iron bridge spike 0.7'± deep over iron railroad spike 1.3'± deep over 4" x 4" concrete monument with a brass cap stamped '32', '33', '4', and '5' 1.8' deep with 1/2"Ø iron pin on South side (for locating purposes only). Monuments found are in apparent centerline of traveled surface of gravel road North-South and in-line with fenceline West. Concrete monument found matches that of record. Therefore, removed spikes, left pin on south side of monument for locating purposes only, placed a pink plastic cased magnet on East side of monument below top for locating purposes only, set 3/4"Ø x 1.5' alum capped iron rered (#15745) stamped '32', '33', '5', and '4', on brass cap to raise up monumentation and used it as the correct corner. All ties are plumb distance unless indicated otherwise.

This certificate is being prepared because there are no certificates on file for this corner.



I hereby certify that this land surveying document was prepared and the related survey work was performed by me or under my direct personal supervision and that I am a duly licensed Land Surveyor under the laws of the State of Iowa.

LEE O. GALLENTINE, LS  
Date: June 9, 2008 License number: 15745  
My license renewal date is December 31, 2008

Pages or sheets covered by this seal: 1 & 2

### List Corners to be Indexed

Corners	Section	Twp	Range
SE Cor.	32	T87N	R14W
SE Cor. NE 1/4 SE 1/4	32	T87N	R14W

## SE Cor. NE¼ SE¼

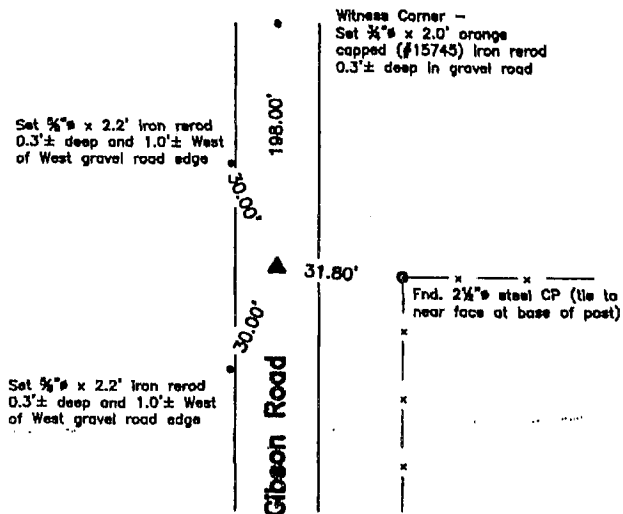

### Monument Description, Remarks, and Plan View:

SE Cor. NE¼ SE¼ - History of Corner =  
1884, Apr. 11 - "Stone & Stake" by John Ball Co Surveyor per Co Aud's Survey Record Bk 1 Pg 615.  
Previous and current Co Engr's ties do not indicate that corner is monumented.

Corner Recovery =  
Excavated 4.0' (North-South) x 2.0' (East-West) x 2.5'± deep around point equidistance between the E¼ Cor. and the SE Cor. and found 6" (East-West) x 10" (North-South) x 15" tall yellow limestone (upright and well nested) 2.2'± deep. Monument found is in apparent centerline of traveled surface of gravel road North-South and 2.5'± North of fence line East. Monument found matches that of record. Therefore, placed a pink plastic cased magnet on West side of stone below high point of stone for locating purposes only, set a 3/8" x 2.0' alum capped iron rod (#15745) stamped '32', '33', and '¼-¼ Cor', on center of limestone to raise up monumentation, and used it as the correct corner. All ties are plumb distance unless indicated otherwise.

This certificate is being prepared because there are no certificates on file for this corner.

### Legend

BC = Nail with Bottle Cap	ID = Inside Diameter	R/W = Iron ROW Rail
BP = Brace Post	OD = Outside Diameter	SFP = Steel 'T' Post
CP = Corner Post	PP = Power Pole	SW = Nail with Square Metal Washer
CMP = Corrugated Metal Pipe	PW = Nail with Plastic Washer	TP = Telephone Pedestal
CM = 4" Sq Concrete Monument with	RCP = Reinforced Concrete Pipe	TW = Nail with Round Metal Washer
1/2" iron rod in center (tie to rod)	RH = Red Head (Nail in wire)	WFP = Wood Fence Post
CX = Cut 'X'	ROW = Right of Way	X = X Nails
GP = Gate Post	RW = Nail with Reflective Round Washer	

