



PREPARED BY  
AND RETURN THIS ORIGINAL DOCUMENT TO:  
ANTHONY F. HILDRETH  
IOWA DEPARTMENT OF TRANSPORTATION  
DISTRICT ONE OFFICE  
1020 SOUTH 4TH STREET  
AMES, IOWA 50010  
PHONE 515-239-1593

RESERVED FOR COUNTY RECORDER'S USE

Doc ID: 008265590001 Type: GEN  
Recorded: 11/01/2017 at 08:26:07 AM  
Fee Amt: \$7.00 Page 1 of 1  
Black Hawk County Iowa  
SANDIE L. SMITH RECORDER  
File **2018-00007691**

### UNITED STATES PUBLIC LAND SURVEY CORNER CERTIFICATE

Land Survey Monument(s) situated in Section 30, Township 87 North, Range 14 West, of the Fifth Principal Meridian, BLACK HAWK County, Iowa.

Previously recorded in BOOK 318 PAGE 815 in the County Recorder's Office.

Monument Description and Remarks: SEARCHED A 5' +/- DIAMETER AREA ON THE ASPHALT SURFACE OF IA175 AT THE DISTANCE INTERSECTION OF FOUND REFERENCE TIE MONUMENTS OF RECORD FROM A UNITED STATES PUBLIC LAND SURVEY CORNER CERTIFICATE PREPARED BY LEON H. CORNELIS (BOOK 318 PAGE 815). NOTHING WAS FOUND BUT A 4" HOLE IN THE ASPHALT AT THE SAID INTERSECTION OF THE REFERENCE TIE MONUMENTS. DUG A 1'Wx1'Lx1'D HOLE, AT SAID INTERSECTION OF REFERENCE TIE MONUMENTS, THROUGH THE ASPHALT, DOWN TO RUBBILIZED CONCRETE, AND FOUND A 1/2" IRON PIN. SAID IRON PIN MATCHES DISTANCES OF RECORD TO ALL, BUT ONE, REFERENCE TIE MONUMENTS OF RECORD WITHIN REASON. THEREFORE, ACCEPTED SAID IRON PIN AS THE SECTION CORNER MONUMENT FOR THE NW CORNER OF SECTION 30-87N-14W. SET A "MAG" NAIL DIRECTLY ABOVE SAID IRON PIN IN THE ASPHALT PATCH TO PERPETUATE THE POSITION OF THE IRON PIN. THIS CORNER CERTIFICATE WAS PREPARED BECAUSE THE SECTION CORNER MONUMENT OF RECORD HAS CHANGED.

#### PLAN - VIEW

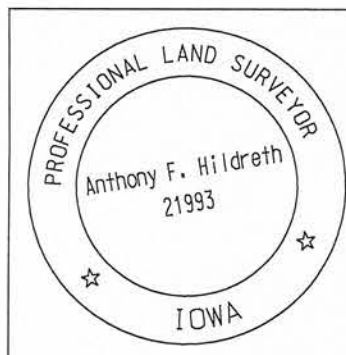
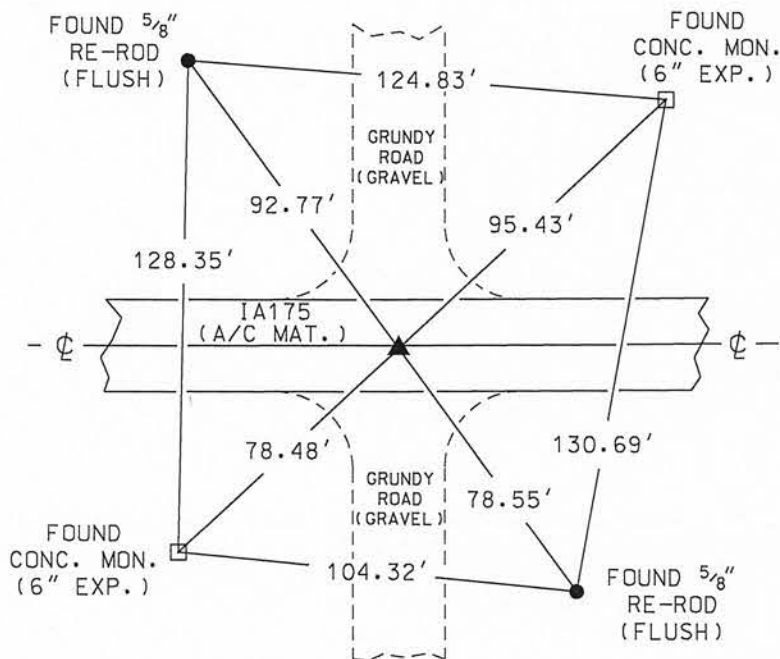

I hereby certify that this Land Surveying document was prepared by me or under my direct personal supervision and that I am a duly licensed Professional Land Surveyor under the laws of the State of Iowa.

Signature: Anthony F. Hildreth

Date: October 23, 2017 Lic. No. 21993

My license renewal date is December 31, 2017.

Pages or sheets covered by this seal. 1 OF 1

Corner to be Indexed

Corner

NW CORNER

Sec. Twp. Range

30 87 14

Drawn by: A.F.H.