

SC
Misc
INDEX
MARGIN
PROOF
COMPARE

BLACK HAWK COUNTY IOWA:SS
FILED FOR RECORD JUNE 9, 1998 AT
4:00 P.M. AND RECORDED IN BOOK 330
OF Misc PAGE 337
FEE 1-5.00/
HAROLD MICHELS
410 BRENTWOOD AVE
WATERLOO, IA 50701

25881

Harold F. Michels 410 Brentwood Ave., Waterloo, Iowa 50701 319-235-7770

UNITED STATES PUBLIC LAND SURVEY CORNER CERTIFICATE

Land Survey Monuments situated in Section 20, Township 87 North, Range 13 West, of the Fifth Principal Meridian, BLACK HAWK County, Iowa.
Previously recorded in W 1/4 "306-942" & N.W. COR. "304-604" in County Recorder's Office.
MISC. (book, page, document number, etc.) J.T. 06/11/98

(Show reason for preparing this certificate, the evidence and detailed procedures used in establishing the corner positions and monumentation found or placed.)

Monument Description and Remarks FD. IRON MONUMENTS AS PER
COUNTY ENGINEER'S RECORDS. SET NEW TIES.

PLAN - VIEW

(Show a minimum of three reference ties to durable physical objects, relevant monuments and physical conditions that will enable recovery of the corner.)

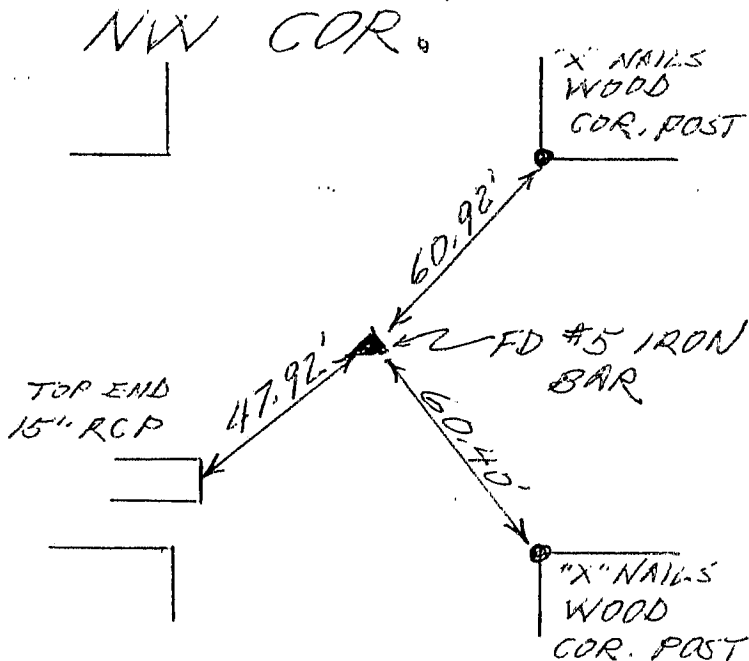

SET "X" NAILS

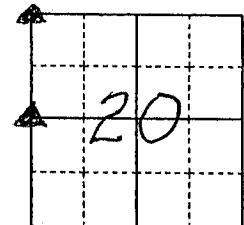

N

W 1/4 COR.

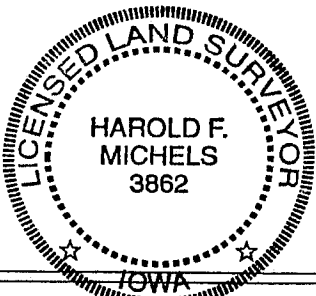
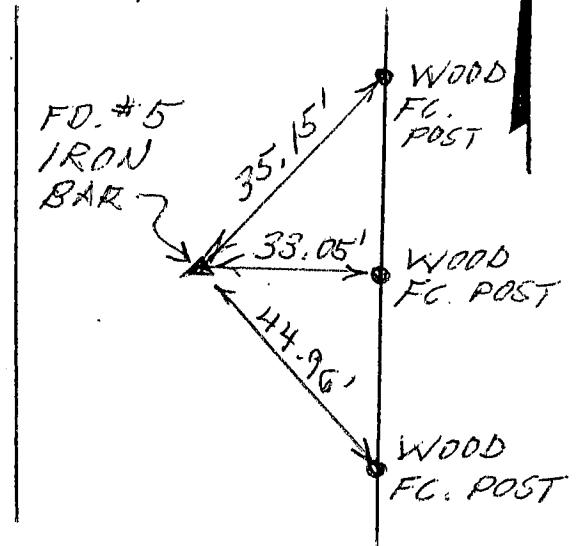

I hereby certify that the survey work was completed and this certificate was prepared by me or under my direct personal supervision and that I am a duly registered land surveyor under the laws of the state of Iowa.

Signature: Harold F. Michels

Date: 2-14-98 Harold F. Michels Reg. No. 3862

My registration renewal date is Dec. 31, 99.

SEAL

List Corners to be Indexed

Corners	Section	Twp	Range
NW	20	87	13
W 1/4	20	87	13

BOOK 330 PAGE 337