

Doc ID: 004736070002 Type: GEN
Kind: CORNER
Recorded: 03/18/2012 at 01:28:45 PM
Fee Amt: \$12.00 Page 1 of 2
Black Hawk County Iowa
JUDITH A MCCARTHY RECORDER
File 2012-00017025

Scott A. Steinfadt PLS, Ryken Engineering, 711 Park Avenue, Ackley, Iowa 50801 - Ph. 641-847-3273 - Fax 641-847-2303

UNITED STATES PUBLIC LAND SURVEY CORNER CERTIFICATE
OF

Land Survey Monuments situated in Section 9, Township 87 North, Range 13 West, of the Fifth Principal Meridian, Black Hawk County, Iowa, Previously recorded in (see below) in County Recorder's Office
NW Corner - Book 328 Page 512 NW Corner NE 1/4 NW 1/4 - Not Applicable

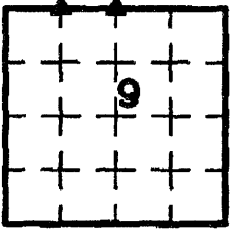

These corners were used for a survey in this section for Russell Reiter. Basis of bearing for this corner certificate can be found on the associated plot of survey filed in the County Recorder's Office for this section.

Legend

- | | | |
|--|--|------------------------------------|
| BC = Nail with Bottle Cap | ID = Inside Diameter | R/W = Iron ROW Roll |
| BP = Brace Post | OD = Outside Diameter | SFP = Steel 'T' Post |
| CP = Corner Post | PP = Power Pole | SW = Nail with Square Metal Washer |
| CMP = Corrugated Metal Pipe | PW = Nail with Plastic Washer | TP = Telephone Pedestal |
| CM = 4" Sq Concrete Monument with | RCP = Reinforced Concrete Pipe | TW = Nail with Round Metal Washer |
| 1/2" Iron rerod in center (tie to rerod) | RH = Red Head (Nail in fence wire) | WFP = Wood Fence Post |
| CX = Cut 'X' | ROW = Right of Way | X = X Nails |
| GP = Gate Post | RW = Nail with Reflective Round Washer | |



NW Corner NE 1/4 NW 1/4

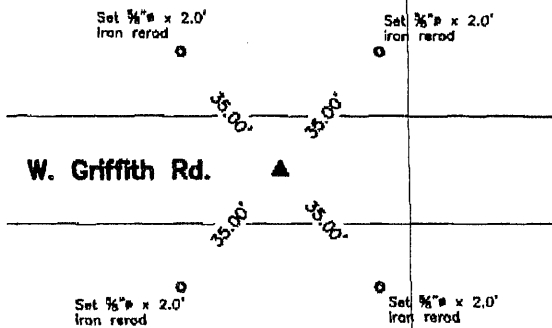

Monument Description, Remarks, and Plan View:

NW Corner NE 1/4 NW 1/4 History of Corner =
1985, Sep. 21 - "SET PIN W/REG. CAP" per County Recorder's Book 264 Page 10.
1997, Dec. 15 - "FOUND BENT NO. 4 REBAR" per County Recorder's Book 328 Page 511.
Previous and current County Engineer's ties do not indicate that corner is monumented.

Corner Recovery =
Searched area with a magnetic locator, excavated a 0.5' x 0.3' deep hole at magnetic reading. Found a 1/2" Iron rerod with red cap remnants, flush in apparent centerline of traveled surface of gravel road East-West. Location of monument found matches that of record, monument found matches that of record. Therefore, drove rerod to 0.4' deep to preserve monumentation and used it as the correct corner. All ties are plumb distance.

This certificate is being prepared because there are no certificates on file for this corner.



I hereby certify that this land surveying document was prepared and the related survey work was performed by me or under my direct personal supervision and that I am a duly licensed Land Surveyor under the laws of the State of Iowa.

Scott A. Steinfadt PLS
SCOTT A. STEINFADT, PLS
Date: 09/29/2011 License number: 14677
My license renewal date is December 31, 2012

Pages or sheets covered by this seal: 1 & 2

List Corners to be Indexed

Corners	Section	Twp	Range
NW Cor. NE 1/4 NW 1/4	9	T87N	R13W
N 1/4 Corner	9	T87N	R13W

(12-00)

2

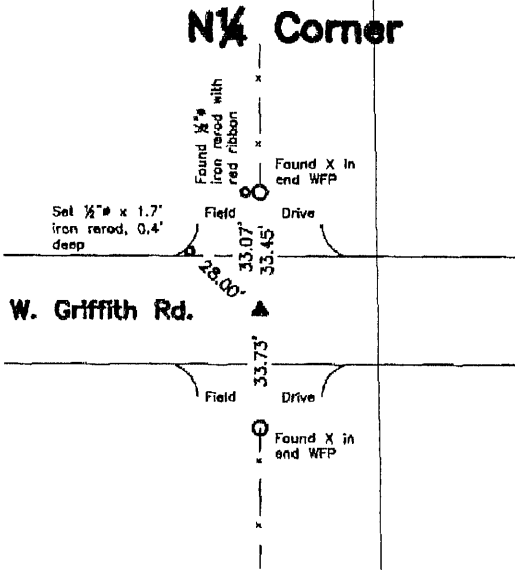

Monument Description, Remarks, and Plan View:

N1/4 Corner - History of Corner =
1900, Oct. 19 - "Stone" per County Auditor's George Miller County Surveyor's Record Book Page 103.
1931, Feb. 26 - "Found n*****head 27" x 14" x 5" iron bar 1/2" x 25" old oak hub very rotten 2" x 2" x 12" Stone set at side of C.M." per County Engineer's W.P.A. tie card.
No date - "Found n*****head 27" x 14" x 5" iron bar 1/2" x 25" old oak hub very rotten 2" x 2" x 12" Stone set at side of C.M." per County Engineer's Field Book 1038 Page 16.
1981, Apr. 29 - "Standard Concrete Monument" per County Recorder's Book 541 Page 810.
1985, Sep. 21 - "FO. CONC. MON." per County Recorder's Book 264 Page 10.
1997, Dec. 15 - "FOUND CONCRETE MONUMENT" per County Recorder's Book 328 Page 511.
1997, Dec. 15 - "FOUND 4" X 4" CONCRETE MONUMENT W/BRASS CAP, 0.4' DEEP" per County Recorder's Book 328 Page 512.
Previous County Engineer's ties indicate that corner is monumented with "Found n*****head 27" x 14" x 5" iron bar 1/2" x 25" old oak hub very rotten 2" x 2" x 12" Stone set at side of C.M. Lowered all evidence in place and set C.M. on top with cap".
Current County Engineer's ties are the same as Corner Certificate recorded in County Recorder's Book 328 Page 512.

Corner Recovery =
Searched area with a magnetic locator, excavated a 1.0' x 0.7' deep hole at magnetic reading. Found a 4" x 4" brass capped concrete monument, 0.4' deep in apparent centerline of traveled surface of gravel road East-West and in-line with fence lines North and South. Location of monument found matches that of record, monument found matches that of record and record ties are within reason. Therefore, used brass capped concrete monument as the correct corner. All ties are plumb distance.

This certificate is being prepared to clarify tie distances and add reference tie.

Legend

- | | | |
|--------------------------------------|--|------------------------------------|
| BC = Nail with Bottle Cap | ID = Inside Diameter | R/W = Iron ROW Rail |
| BP = Brace Post | OD = Outside Diameter | SFP = Steel 'T' Post |
| CP = Corner Post | PP = Power Pole | SW = Nail with Square Metal Washer |
| CMP = Corrugated Metal Pipe | PW = Nail with Plastic Washer | TP = Telephone Pedestal |
| CM = 4" Sq Concrete Monument with | RCP = Reinforced Concrete Pipe | TW = Nail with Round Metal Washer |
| 1/2" Iron rod in center (tie to rod) | RH = Red Head (Nail in fence wire) | WFP = Wood Fence Post |
| CX = Cut 'X' | ROW = Right of Way | X = X Nails |
| GP = Gate Post | RW = Nail with Reflective Round Washer | |