

Scott A. Steinfadt PLS, Ryken Engineering, 711 Park Avenue, Ackley, Iowa 50601 - Ph. 641-847-3273 - Fax 641-847-2303

## UNITED STATES PUBLIC LAND SURVEY CORNER CERTIFICATE OF

Land Survey Monuments situated in Section **8**, Township **87** North,  
Range **13** West, of the Fifth Principal Meridian, **Black Hawk County, Iowa**,  
Previously recorded in **Not Applicable** in County Recorder's Office

These corners were used for a survey in this section for Steimel Farms L.L.C. Basis of bearing for this corner certificate can be found on the associated plat of survey filed in the County Recorder's Office for this section.

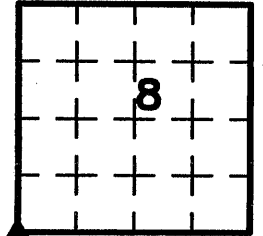

### Legend

BC = Nail with Bottle Cap  
BP = Brace Post  
CP = Corner Post  
CMP = Corrugated Metal Pipe  
CM = 4" Sq Concrete Monument with  
1/2"Ø iron rerod in center (tie to rerod)  
CX = Cut 'X'  
GP = Gate Post  
ID = Inside Diameter  
OD = Outside Diameter  
PP = Power Pole  
PW = Nail with Plastic Washer  
RCP = Reinforced Concrete Pipe  
RH = Red Head (Nail in fence wire)  
ROW = Right of Way  
RW = Nail with Reflective Round Washer  
R/W = Iron ROW Rail  
SFP = Steel 'T' Post  
SW = Nail with Square Metal Washer  
TP = Telephone Pedestal  
TW = Nail with Round Metal Washer  
WFP = Wood Fence Post  
X = X Nails



### SW Corner

Set 5/8"Ø x 2.4' iron  
rerod 0.1' exposed 3.0'±  
East of Northwestern Bell  
underground telephone  
sign

Set 5/8"Ø x 2.4' iron  
rerod 0.1' exposed 1.0'±  
South of street sign

W. Quarry Road

Set TW in  
Northeast  
face of PP

Top West broken  
off edge of RCP

Beck Road

Top East edge  
of RCP

Set TW in  
Northwest  
face of PP  
Note: Found X in CP,  
did not use due to PP  
blocking measurement

### CO ENGR'S RECORD TIES

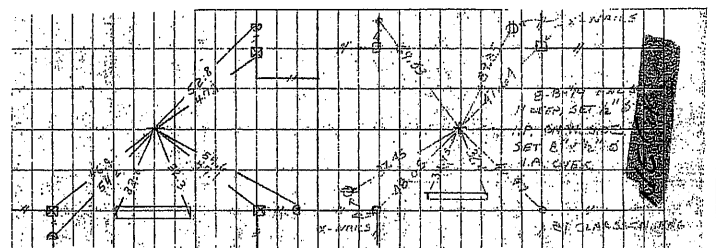

### Monument Description, Remarks, and Plan View:

#### SW Corner - History of Corner =

- 1867, Nov. 27 - "stone & stake" per County Auditor's Survey Record Book 1 Page 243.
- 1868, Nov. 27 - "Mound" per County Auditor's Survey Record Book 1 Page 345.
- 1871, May 19 - "Stone stake" per County Auditor's Survey Record Book 1 Page 489.
- 1910, May 6 - "F" per County Auditor's Surveyor's Record Book 1 Page 18.
- 1912, Oct. 13 - "N\*\*\*\*\*head" per County Auditor's Surveyor's Record Book 1 Page 49.
- No date - "Found N\*\*\*\*\*head & set Iron Bar over stone" per County Engineer's Field Book 139 Page 47.
- 1939, May 12 - "Found N\*\*\*\*\*head stone 16" x 12" x 8" also wood stake 1" x 3" x 17" and Iron bar 1/2" x 24" long Lowered all evidence in place and set C.M. with cap" per County Engineer's WPA Field Book Page 49 and WPA Tie Card.
- 1941, July 30 - County Engineer's Field Book 1038 Pages 19, 29, 30 indicate usage of corner but not type of monumentation.
- 1941, July 30 - "found n\*\*\*\*\*head 16" x 12" x 8" wood stake 1" x 3" x 17" iron bar 1/2" x 24" per County Engineer's Field Book 1038 Page 31.

Previous County Engineer's ties indicate that corner is monumented with "FND. scm 1' DEEP SET 1/2"Ø I.P. ON W. SIDE. SET 8" 1/2"Ø I.P. OVER."

Current County Engineer's ties indicate that corner is monumented with "FND SCM 1' DEEP. SET 1/2"Ø I.P. ON W. SIDE. SET 8" X 1/2"Ø I.P. OVER" with ties as shown above.

#### Corner Recovery =

Searched area with a magnetic locator, excavated a 1.0'Ø x 0.6' deep hole at magnetic reading. Found a 1/2"Ø x 1.0' iron rerod, 0.4' deep, tied out and removed rerod. Probed down rerod hole with a tile probe and hit concrete monument, 1.5' deep. Reset rerod in original location and drove to 0.5' deep. Monuments found are 1.0'± West of apparent centerline of traveled surface of gravel road North-South and 0.5'± North of apparent centerline of traveled surface of gravel road East-West. Monuments found match that of record and record ties are within reason. Therefore, used rerod as the correct corner. All ties are plumb distance.

This certificate is being prepared because there are no certificates on file for this corner.

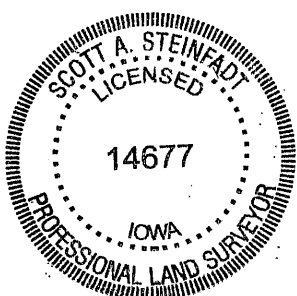

I hereby certify that this land surveying document was prepared and the related survey work was performed by me or under my direct personal supervision and that I am a duly licensed Land Surveyor under the laws of the State of Iowa.

*Scott A. Steinfadt, PLS.*  
SCOTT A. STEINFADT, PLS

Date: 11/01/2011 License number: 14677

My license renewal date is December 31, 2012

Pages or sheets covered by this seal: 1

### List Corners to be Indexed

Corners	Section	Twp	Range
SW Corner	8	T87N	R13W