



Doc ID: 004617720003 Type: GEN
Kind: CORNER
Recorded: 10/31/2011 at 12:39:28 PM
Fee Amt: \$17.00 Page 1 of 3
Black Hawk County Iowa
JUDITH A MCCARTHY RECORDER

File 2012-00007772

Lee O. Gallentine PLS, Ryken Engineering, 711 Park Avenue, Ackley, Iowa 50601 - Ph. 641-847-3273 - Fax 641-847-2303

UNITED STATES PUBLIC LAND SURVEY CORNER CERTIFICATE OF

Land Survey Monuments situated in Section 8, Township 87 North,
Range 13 West, of the Fifth Principal Meridian, Black Hawk County, Iowa,
Previously recorded in (see below) in County Recorder's Office
E $\frac{1}{4}$ Cor. - Doc. No. 2007026198 All others - Not Applicable

These corners were used for a survey in this section for Ronald D. and Vicky L. Droppert. Basis of bearing for this corner cert. can be found on the associated plat of survey filed in the Co. Rec's Office for this section.

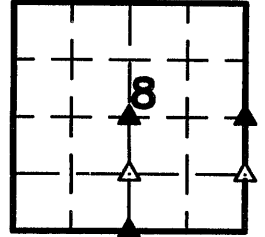

Legend

BC = Nail with Bottle Cap	ID = Inside Diameter	R/W = Iron ROW Rail
BP = Brace Post	OD = Outside Diameter	SFP = Steel 'T' Post
CP = Corner Post	PP = Power Pole	SW = Nail with Square Metal Washer
CMP = Corrugated Metal Pipe	PW = Nail with Plastic Washer	TP = Telephone Pedestal
CM = 4" Sq Concrete Monument with	RCP = Reinforced Concrete Pipe	TW = Nail with Round Metal Washer
1/2"Ø Iron rerod in center (tie to rerod)	RH = Red Head (Nail in wire)	WFP = Wood Fence Post
CX = Cut 'X'	ROW = Right of Way	X = X Nails
GP = Gate Post	RW = Nail with Reflective Round Washer	



Center

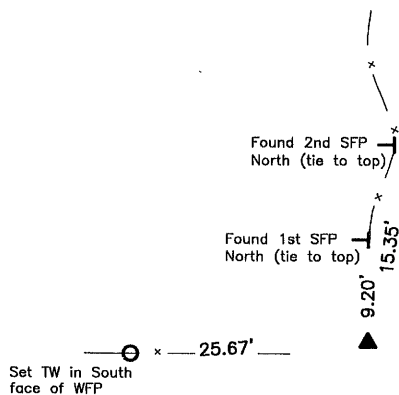

Monument Description, Remarks, and Plan View:

Center - History of Corner =

1871, May 19 - "stone" by J. Ball per Co. Aud's Survey Record Bk 1 Pg 489.
1910, May 6 - Co. Aud's Surveyors Record Bk 1 Pg 18 indicates corner was found.
Previous and current Co Engr's ties do not indicate that corner is monumented.

Corner Recovery =

Excavated 2'Ø x 1' deep hole around corner post and found 12" x 14" gray granite stone 0.6' deep in-line with wandering fence North and 0.5'± North of fenceline West. Monument found matches that of record and location of stone matches fenceline evidence well. Therefore, placed pink plastic cased magnet on north side of stone below high point for locating purposes only, drilled 1/4"Ø hole in high point of stone, and used it as the correct corner. All ties are plumb distance unless indicated otherwise.

This certificate is being prepared because there are no certificates on file for this corner.

List Corners to be Indexed

Corners	Section	Twp	Range
Center	8	T87N	R13W
SW Cor. N $\frac{1}{2}$ SE $\frac{1}{4}$	8	T87N	R13W
S $\frac{1}{4}$ Cor.	8	T87N	R13W
E $\frac{1}{4}$ Cor.	8	T87N	R13W
SE Cor. N $\frac{1}{2}$ SE $\frac{1}{4}$	8	T87N	R13W



I hereby certify that this land surveying document was prepared and the related survey work was performed by me or under my direct personal supervision and that I am a duly licensed Land Surveyor under the laws of the State of Iowa.

LEE O. GALLENTINE, PLS

Date: 04/20/11 License number: 15745

My license renewal date is December 31, 2012

Pages or sheets covered by this seal: 1, 2, & 3

Pg 1 of 3

P:\P1108-5599\CADD\SURVEY\5599CORCERT.DWG

E $\frac{1}{4}$ Cor.

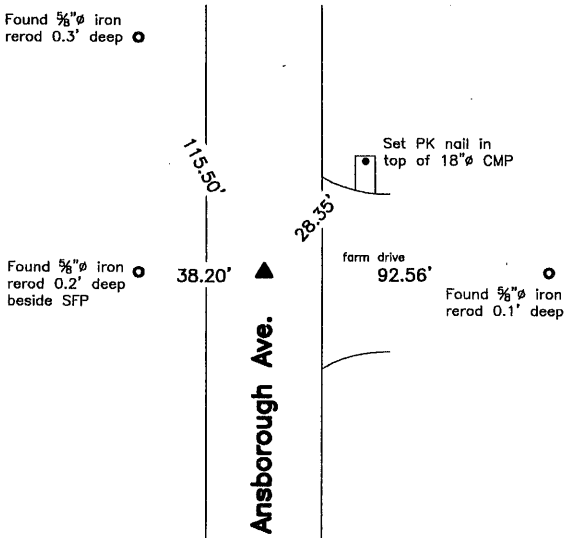

Monument Description, Remarks, and Plan View:

E $\frac{1}{4}$ Cor. – Partial History of Corner =
1871, May 19 – "stone" by J. Ball per Co. Aud's Survey Record Bk 1 Pg 489.
1910, May 6 – Co. Aud's Surveyors Record Bk 1 Pg 18 indicates corner was found.
2007, Jun. 6 – 'FND. STD. WPA C.M. LOC. 10" DEEP w/ TOP BROKE....SET #5 RBR. x 0.8' L. w/ 2" ALUM. CAP' per Geoffry Allen Tinker per Co. Rec's Doc. No. 2007026198.
2008, Mar. 5 – 'FND 5/8" ALUM CAPPED IRON REROD' by Lee O. Gallentine per Co. Rec's Doc. No. 2008019295.
2011, Jun. 10 – 'FOUND 5/8" REBAR' by David L. Scheil per Co. Rec's File 2011-00023680.
Current Co Engr's ties indicate that corner is monumented the same as Co. Rec's Doc. No. 2007026198 with the same ties.

Corner Recovery =
Searched area with metal detector, excavated 1' x 0.7' deep hole and found concrete monument (broken) 0.6' deep with 5/8" x 2.8' iron rerod 0.6' deep on north side (for locating purposes only) at 1'± West of apparent centerline of traveled surface of gravel road North-South. Location of monument found matches that of record, monument found matches that of record, and record ties are within reason. Therefore, set 'Survey Mark' in center of concrete monument to perpetuate monumentation, drove rerod to 0.9' deep for locating purposes only, and used nail as the correct corner. All ties are plumb distance unless indicated otherwise.

This certificate is being prepared because there is a change to monumentation and ties of record.

SE Cor. N $\frac{1}{2}$ SE $\frac{1}{4}$

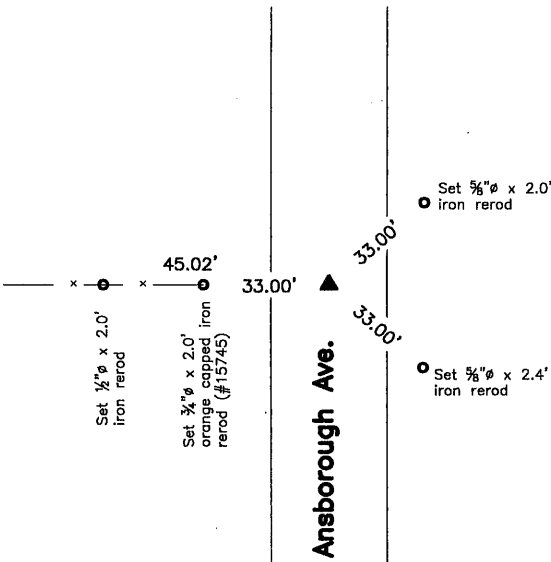

Monument Description, Remarks, and Plan View:

SE Cor. N $\frac{1}{2}$ SE $\frac{1}{4}$ – History of Corner =
1910, May 6 – Co. Aud's Surveyors Record Bk 1 Pg 18 indicates usage of corner equidistance between the SE Corner and the E $\frac{1}{4}$ Corner but not type of monumentation at corner.
2008, Mar. 5 – "A 2.0' X 3.5' DEEP HOLE WAS EXCAVATED AROUND A POINT EQUIDISTANCE BETWEEN SAID E $\frac{1}{4}$ COR AND SAID SE COR AND NOTHING WAS FOUND. SAID HOLE WAS SEARCHED TO 4.5' DEEP WITH A TILE PROBE AND NOTHING WAS FOUND." by Lee O. Gallentine per Co. Rec's Doc. No. 2008019295.
Previous and current Co Engr's ties do not indicate that corner is monumented.

Corner Recovery =
Since there is no record of permanent monumentation at corner and since no monumentation could be found in 2008, set 3/4" x 4.0' aluminum capped iron rerod (#15745) at point equidistance between the E $\frac{1}{4}$ Corner and the SE Corner in accordance with 1910 survey, and used it as the correct corner. Rerod is 0.1' deep at 1.5'± West of apparent centerline of traveled surface of gravel road North-South and in-line with fenceline West. All ties are plumb distance unless indicated otherwise.

This certificate is being prepared because there are no certificates on file for this corner.

Legend

BC = Nail with Bottle Cap	ID = Inside Diameter	R/W = Iron ROW Rail
BP = Brace Post	OD = Outside Diameter	SFP = Steel 'T' Post
CP = Corner Post	PP = Power Pole	SW = Nail with Square Metal Washer
CMP = Corrugated Metal Pipe	PW = Nail with Plastic Washer	TP = Telephone Pedestal
CM = 4" Sq Concrete Monument with	RCP = Reinforced Concrete Pipe	TW = Nail with Round Metal Washer
1/2" Iron rerod in center (tie to rerod)	RH = Red Head (Nail in wire)	WFP = Wood Fence Post
CX = Cut 'X'	ROW = Right of Way	X = X Nails
GP = Gate Post	RW = Nail with Reflective Round Washer	

