

EARTH TECH

Michael R. Fagle, L.S.

Earth Tech, 501 Sycamore St., Suite 222, Waterloo, Iowa 50703

I-319-232-6531

UNITED STATES PUBLIC LAND SURVEY CORNER CERTIFICATE
OF

Land Survey Monuments situated in Section 18, Township 87 North,
Range 12 West, of the Fifth Principal Meridian, Black Hawk
County, Iowa. Previously recorded in Chaining Notes Field Books
in County Engineer's Office. (Book, Page, Document Number, etc.)

(Show reason for preparing this certificate, the evidence and detailed procedures
used in establishing the corner positions and monumentation found or placed.)

Monument Description and Remarks: _____

SOUTHWEST CORNER SEC. 18-87-12 FOUND 5/8" IRON PIN.

WEST 1/4 CORNER SEC. 18-87-12 FOUND 5/8" IRON PIN.

PLAN - VIEW

(Show a minimum of three reference ties to durable physical objects, relevant
monuments and physical conditions that will enable recovery of the corner.)

ALL MEASUREMENTS ARE PLUMBED

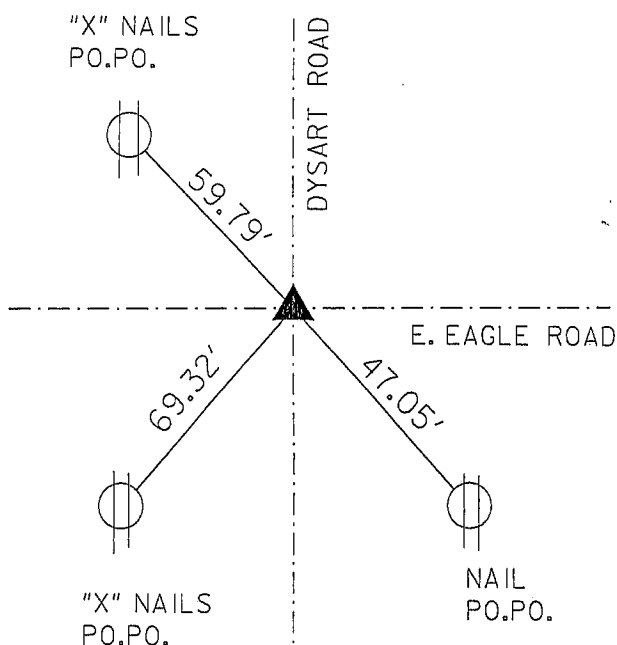

SOUTHWEST CORNER
FOUND 5/8" IRON PIN

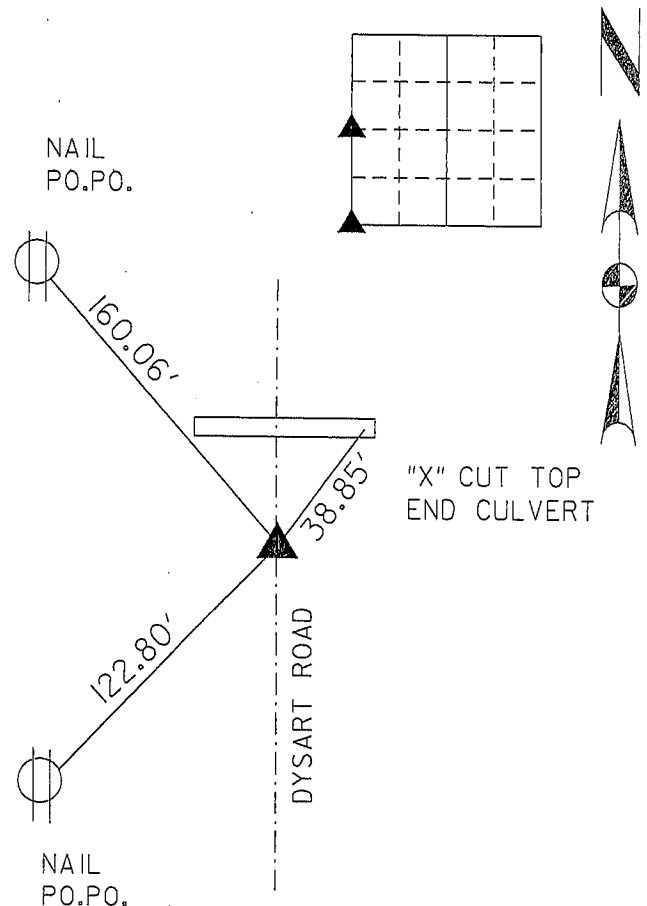

WEST 1/4 CORNER
FOUND 5/8" IRON PIN

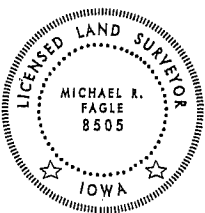

I hereby certify that this Land Surveying
document was prepared by me or under
my direct personal supervision and
that I am a duly Licensed Land Surveyor
under the laws of the State of Iowa.

Michael R. Fagle 5-15-06
MICHAEL R. FAGLE Date

License number 8505

My license renewal date is December 31, 2006

Pages or sheets covered by this seal:

THIS SHEET

List Corners to be Indexed

| Corners | Section | Twp | Range |
|------------------|---------|--------|--------|
| SOUTHWEST CORNER | 18 | T 87 N | R 12 W |
| WEST 1/4 CORNER | 18 | T 87 N | R 12 W |