

UNITED STATES PUBLIC LAND SURVEY CORNER CERTIFICATE
OF

Land Survey Monuments situated in Section 29 , Township 87N , Range 11W of the Fifth Principal Meridian, BLACK HAWK County, Iowa, previously recorded in N/A (Book, Page, Document Number, etc.)

Monument Description and Remarks:

NW COR. NE1/4 SW1/4: FOUND NO CORNER CERTIFICATE ON FILE W/ THE BH COUNTY RECORDER. SEARCHED INTERSECTION OF ANCIENT NORTH TO SOUTH FENCELINE AND LINE BETWEEN MONUMENTED W1/4 CORNER AND NE CORNER OF NW1/4 SE1/4 W/ PROBE AND METAL DETECTOR, FOUND NO EVIDENCE OF MONUMENT; HELD INTERSECTION AS BEST EVIDENCE OF LOCATION. SET 1/2" REBAR W/ YELLOW CAP #17929. SET TIES AND TIED OUT.

SW COR. NE1/4 SW1/4: FOUND NO CORNER CERTIFICATES ON FILE W/ THE BH COUNTY RECORDER. SEARCHED AROUND RAILROAD TIE CORNER POST AT INTERSECTION OF OLD FENCES TO SOUTH AND WEST WITH PROBE AND METAL DETECTOR, FOUND NO EVIDENCE OF MONUMENT; HELD CORNER POST AS BEST EVIDENCE OF SECTION CORNER. SET MAG NAIL W/ WASHER #17929 IN TOP OF SAID POST. SET TIES AND TIED OUT.

LIST CORNERS TO BE INDEXED			
CORNER	SECTION	TOWNSHIP	RANGE
NW COR. NE1/4 SW1/4	29	87N	11W
SW COR. NE1/4 SW1/4	29	87N	11W

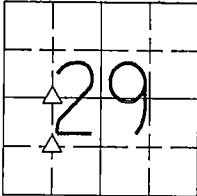

SW COR. NE1/4 SW1/4
SEC. 29, T87N-R11W

SET MAG NAIL W/ BRASS WASHER #17929
IN TOP OF RAILROAD TIE CORNER POST

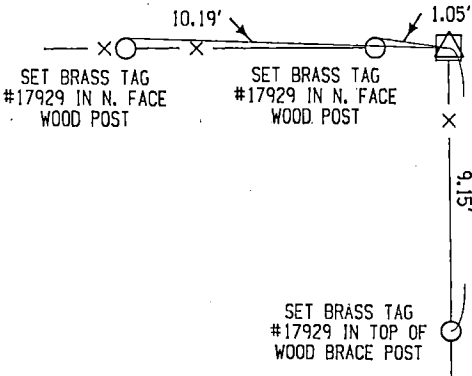

NW COR. NE1/4 SW1/4
SEC. 29, T87N-R11W

SET 1/2" REBAR W/ YELLOW CAP #17929

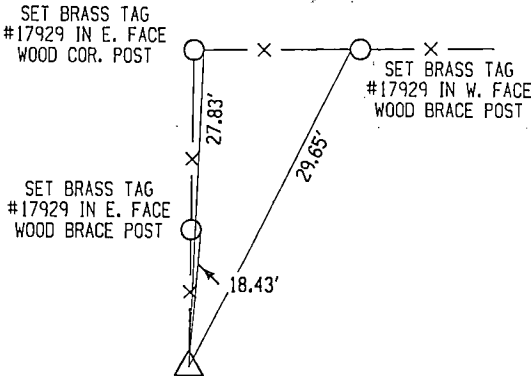

I hereby certify that this land surveying document was prepared and the related survey work was performed by me or under my direct personal supervision and that I am a duly licensed Land Surveyor under the laws of the State of Iowa.

Jeffrey R. Hutton 5 Nov 21
JEFFREY R. HUTTON LICENSE NO. 17929 DATE

My license is subject to renewal on December 31, 2021.
This certification applies only to the page upon which it appears.

- REASON FOR PREPARING CERTIFICATE:
- ☒ A) THERE IS NO CERTIFICATE FOR THE CORNER ON FILE WITH THE RECORDER OF THE COUNTY IN WHICH THE CORNER IS LOCATED.
 - ☐ B) CORNER POSITION DIFFERS FROM THAT SHOWN IN THE PUBLIC RECORDS OF THE COUNTY IN WHICH THE CORNER IS LOCATED.
 - ☐ C) THE CORNER MONUMENT HAS BEEN REPLACED OR MODIFIED.
 - ☐ D) THE REFERENCE TIES REFERRED TO IN AN EXISTING PUBLIC RECORD ARE INCORRECT.

LEGEND	SHEET NAME	U.S. LAND SURVEY CORNER CERT.				GPS Great Plains Survey, Inc.	407 SYCAMORE ST. LA PORTE CITY, IA 50651 (319)342-4774
	PROJECT NAME	HARTING PLAT OF SURVEY					
DATE	DRAWN BY	CHECKED BY	APPROVED BY	SCALE	PROJECT No.		
10/22/2021	MJWH	JRH	JRH	NTS	211086		