

SC  
Misc

4:00 P  
Misc

Nov 14 1997  
Recorded in Book 328  
Page 95

9726

Recorder

1-5.00/

CLAASSEN ENGINEERING

WAYNE CLAASSEN ENGINEERING AND SURVEYING, INC.  
P.O. BOX 898 WATERLOO, IOWA 50704-0898

PHONE: (VOICE) 319-235-6294  
(FAX) 319-235-0028

# UNITED STATES PUBLIC LAND SURVEY CORNER CERTIFICATE

Land Survey Monuments situated in Section 17, Township 87N, Range 11W, of the Fifth Principal Meridian, BLACK HAWK County, Iowa.  
Previously recorded in N/A in County Recorder's Office.  
(book, page, document number, etc.)

(Show reason for preparing this certificate, the evidence and detailed procedures used in establishing the corner positions and monumentation found or placed.)

Monument Description and Remarks 1 1/4" COR. FOUND 5/8" PIPER FLUSH WITH SURFACE  
ASPHALT PAVING PER E.H. CO. TIES.

## PLAN - VIEW

(Show a minimum of three reference ties to durable physical objects, relevant monuments and physical conditions that will enable recovery of the corner.)

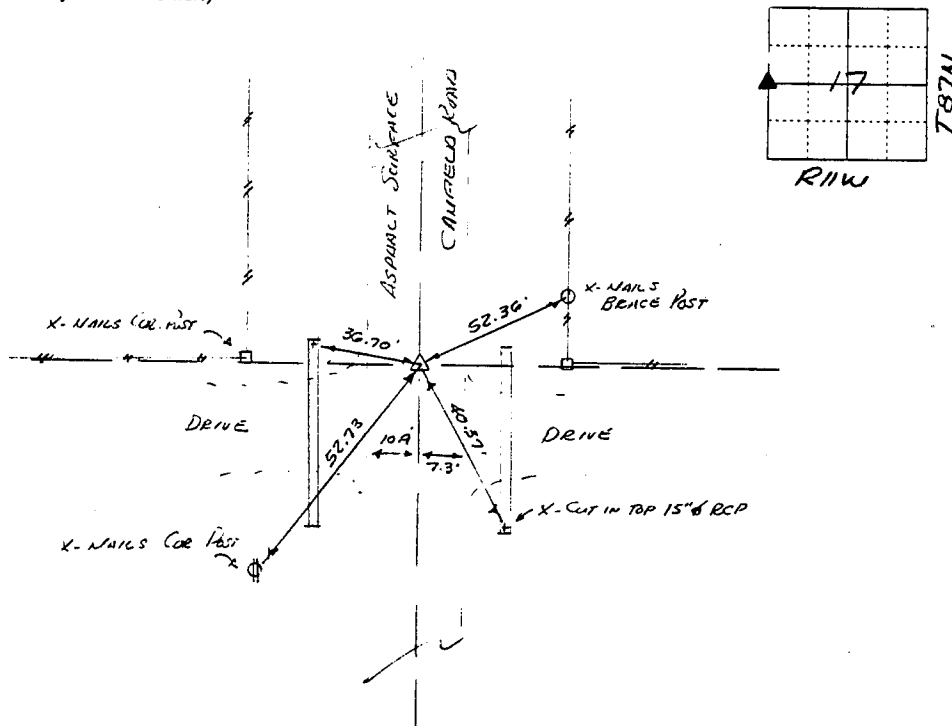

475-42

I hereby certify that the survey work was completed and this certificate was prepared by me or under my direct personal supervision and that I am a duly licensed land surveyor under the laws of the state of Iowa.

### List Corners to be Indexed

Corners	Section	Twp	Range
W 1/4	17	87N	11W

Signature: F. William King  
(Name typed or printed) F. WILLIAM KING

Date: Nov. 14, 1997 Lic. No. 18033

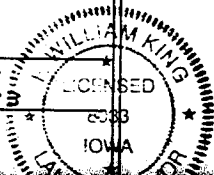

SEAL