

Black Hawk County, Iowa**12/01/2020**

Units: US Survey Feet

Point ID: **7305**Stamping on Disk: **Clark 1934**

Type of Monument: *CGS triangulation station w/brass disk set in standard concrete monument stamped "CLARK 1934".*

Physical Details: *Station is flush with ground surface, beyond R.O.W. in tall grass. Field edge is diverted around the station.*

NAD 83(NA2011) Latitude: **N42°21'28.42696"** Longitude: **W92°03'54.01053"**
NAVD 88 Ortho Height: **923.636sft** Ellip. Ht: **822.272sft** **Geoid18(Conus)**

Horizontal Datum: NAD 83(NA2011) - Vertical Datum: NAVD 1988

Iowa North Zone (1401) Northing: **3596761.266sft** Easting: **5309082.733sft**Mapping Angle: **0°58'21"**Combination Scale Factor: **0.9999205987**

Iowa Regional Coordinate System, Zone 5, Waterloo LCC

IaRCS Zone 5 Northing: **8793595.106sft** Easting: **15550005.266sft**Mapping Angle: **0°07'31"**Combination Scale Factor: **1.0000056209****MONUMENT TIES:**

PLAN - VIEW

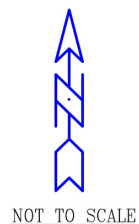

* Yellow Metal Sign
Located W. of Station.

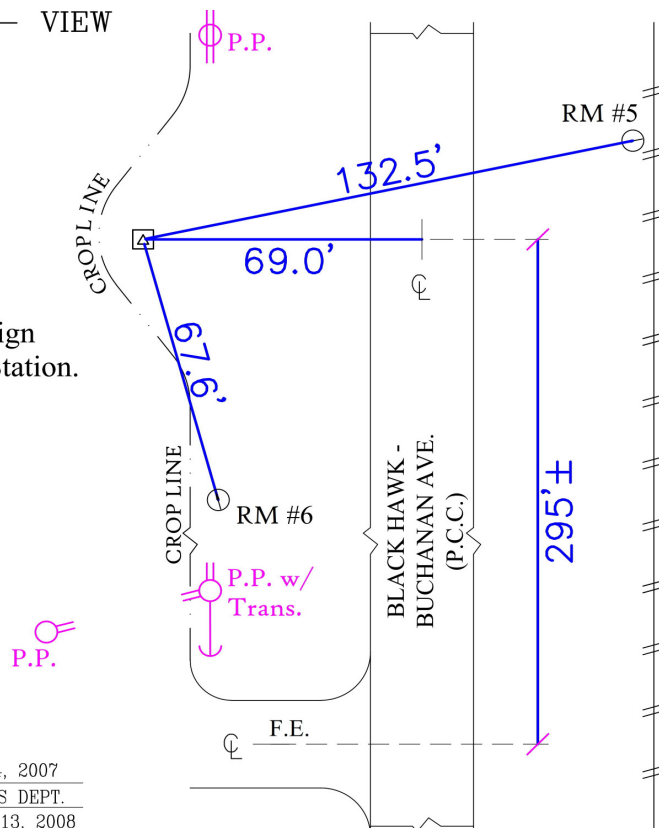

BH Co. Updated TIES: C.W. & G.T. April 24, 2007
TIE SOURCE: BLACK HAWK COUNTY ENGINEER'S DEPT.
FORM PREPARED BY: C.W. & G.T. February 13, 2008

This document was prepared by Dan Corbin, Inc. for Black Hawk County, Iowa.

7305



Facing West

