

**Black Hawk County, Iowa**

Units: US Survey Feet

12/01/2020

Point ID: **7175**Stamping on Disk: **2003-009**

Type of Monument: *Berntsen 3/4" fluted "Top Security" rod, 6ft long with 2.5" dia. aluminum survey cap, NGS style access cover.*

Physical Details: *Sta. is Benton Co. GPS Point #9 = Black Hawk Co. #175. Station is flush with ground surface at TBKS.*

NAD 83(NA2011) Latitude: **N42°15'16.08798"** Longitude: **W92°17'56.81381"**  
NAVD 88 Ortho Height: **844.690sft** Ellip. Ht: **742.061sft** **Geoid18(Conus)**

Horizontal Datum: NAD 83(NA2011) - Vertical Datum: NAVD 1988

**Iowa North Zone (1401)** Northing: **3558087.627sft** Easting: **5246349.976sft**Mapping Angle: **0°48'50"**Combination Scale Factor: **0.9999357449**

Iowa Regional Coordinate System, Zone 5, Waterloo LCC

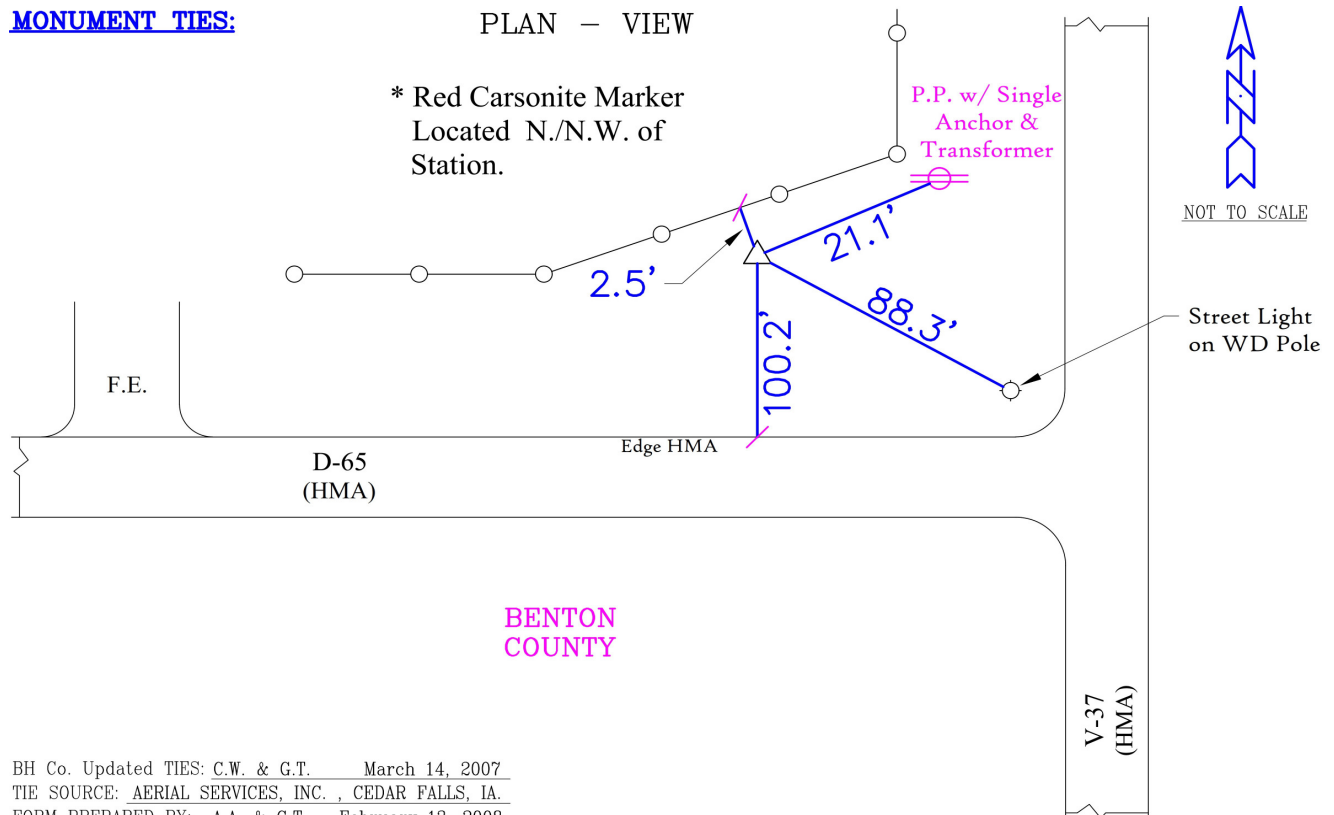
**IaRCS Zone 5** Northing: **8755850.051sft** Easting: **15486702.180sft**Mapping Angle: **-0°02'00"**Combination Scale Factor: **1.0000202176****MONUMENT TIES:**

BH Co. Updated TIES: C.W. & G.T. March 14, 2007  
TIE SOURCE: AERIAL SERVICES, INC., CEDAR FALLS, IA.  
FORM PREPARED BY: A.A. & G.T. February 13, 2008

*This document was prepared by Dan Corbin, Inc. for Black Hawk County, Iowa.*

7175



Facing Northwest

