

**Black Hawk County, Iowa**

Units: US Survey Feet

12/01/2020

Point ID: **7163**Stamping on Disk: **2006-163**

Type of Monument: *Berntsen 3/4" fluted "Top Security" rod, 6ft long with 2.5" dia. aluminum survey cap, NGS style access cover.*

Physical Details: *Station is flush with ground surface located north of the 1st storm intake east of intersection in mowed R.O.W lawn.*

NAD 83(NA2011) Latitude: **N42°32'50.00979"** Longitude: **W92°23'37.51028"**  
NAVD 88 Ortho Height: **862.104sft** Ellip. Ht: **758.966sft** **Geoid18(Conus)**

Horizontal Datum: NAD 83(NA2011) - Vertical Datum: NAVD 1988

**Iowa North Zone (1401)** Northing: **3664415.908sft** Easting: **5219335.382sft**  
Mapping Angle: **0°44'59"** Combination Scale Factor: **0.9999112898**

Iowa Regional Coordinate System, Zone 5, Waterloo LCC

**IaRCS Zone 5** Northing: **8862575.223sft** Easting: **15461260.453sft**  
Mapping Angle: **-0°05'51"** Combination Scale Factor: **0.9999973219**

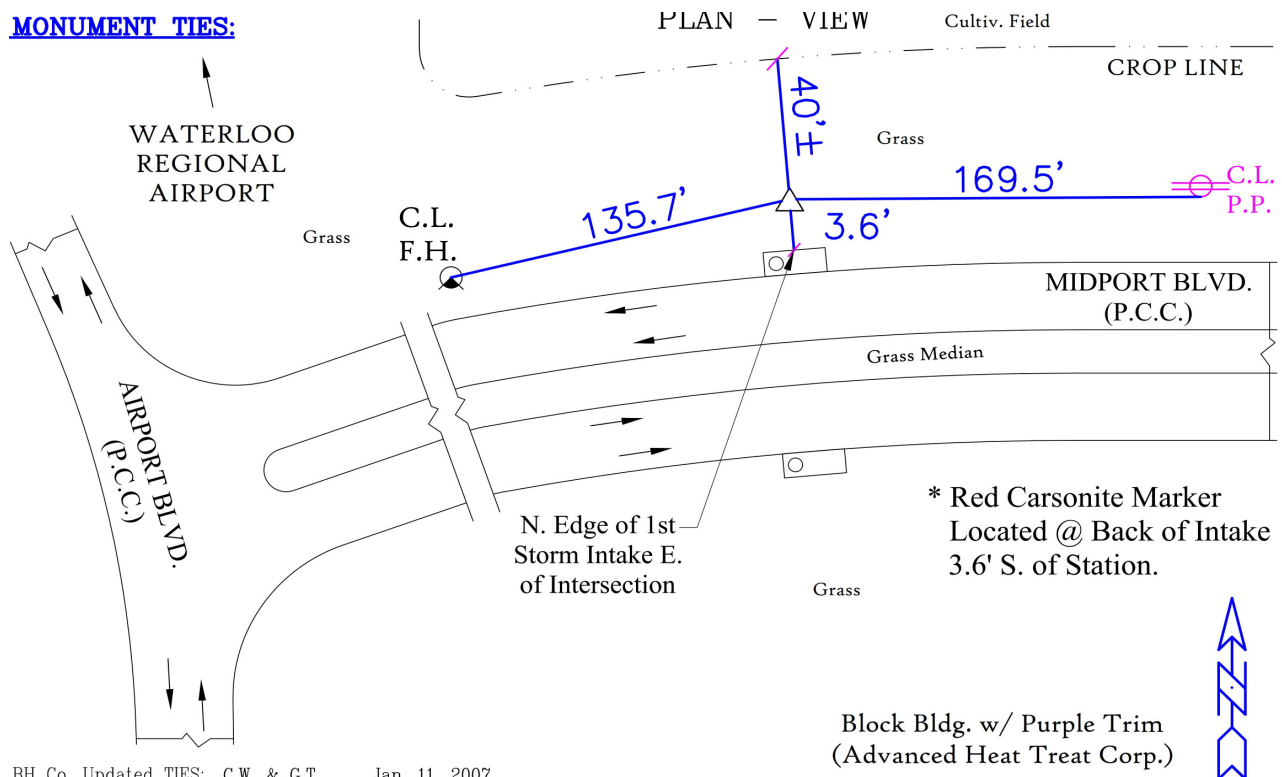
**MONUMENT TIES:**

BH Co. Updated TIES: C.W. & G.T. Jan. 11, 2007  
TIE SOURCE: BLACK HAWK COUNTY ENGINEER'S DEPT.  
FORM PREPARED BY: C.W. & G.T. February 14, 2008

*This document was prepared by Dan Corbin, Inc. for Black Hawk County, Iowa.*

7163



Facing North

