

Black Hawk County, Iowa**12/01/2020**

Units: US Survey Feet

Point ID: **7102**Stamping on Disk: **94-102**

Type of Monument: *Berntsen 5/8" fluted "Top Security" rod, 6ft long with 2.5" dia. aluminum survey cap, NGS style access cover.*

Physical Details: *Station is 6" +/- above ground surface between misc. utility boxes.*

NAD 83(NA2011) Latitude: **N42°34'13.52437"** Longitude: **W92°27'20.67184"**
NAVD 88 Ortho Height: **875.973sft** Ellip. Ht: **772.459sft** **Geoid18(Conus)**

Horizontal Datum: NAD 83(NA2011) - Vertical Datum: NAVD 1988
Iowa North Zone (1401) Northing: **3672657.023sft** Easting: **5202528.410sft**
Mapping Angle: **0°42'28"** Combination Scale Factor: **0.9999098795**

Iowa Regional Coordinate System, Zone 5, Waterloo LCC
IaRCS Zone 5 Northing: **8871064.657sft** Easting: **15444575.725sft**
Mapping Angle: **-0°08'22"** Combination Scale Factor: **0.9999960355**

MONUMENT TIES:

PLAN - VIEW

DETAIL

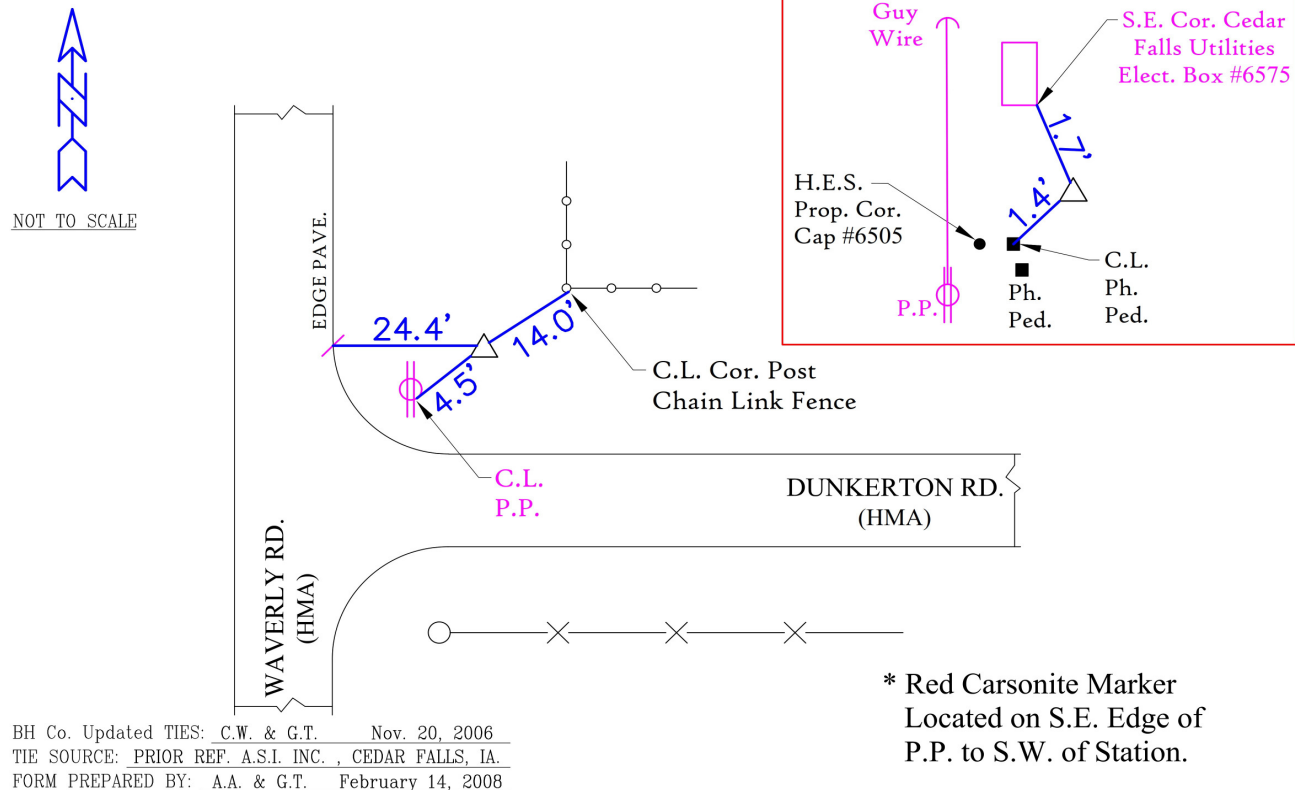

This document was prepared by Dan Corbin, Inc. for Black Hawk County, Iowa.

7102



Facing East

