

Black Hawk County, Iowa

Units: US Survey Feet

12/01/2020Point ID: **7043**Stamping on Disk: **94-043**

Type of Monument: *Berntsen 5/8" fluted "Top Security" rod, 6ft long with 2.5" dia. aluminum survey cap, NGS style access cover.*

Physical Details: *Station is flush with ground surface located at centerline of ditch.*

NAD 83(NA2011) Latitude: **N42°20'27.60794"** Longitude: **W92°17'54.18241"**
NAVD 88 Ortho Height: **902.150sft** Ellip. Ht: **799.725sft** **Geoid18(Conus)**

Horizontal Datum: NAD 83(NA2011) - Vertical Datum: NAVD 1988
Iowa North Zone (1401) Northing: **3589621.691sft** Easting: **5246099.634sft**
Mapping Angle: **0°48'52"** Combination Scale Factor: **0.9999233036**

Iowa Regional Coordinate System, Zone 5, Waterloo LCC
IaRCS Zone 5 Northing: **8787387.041sft** Easting: **15486918.126sft**
Mapping Angle: **-0°01'58"** Combination Scale Factor: **1.0000082360**

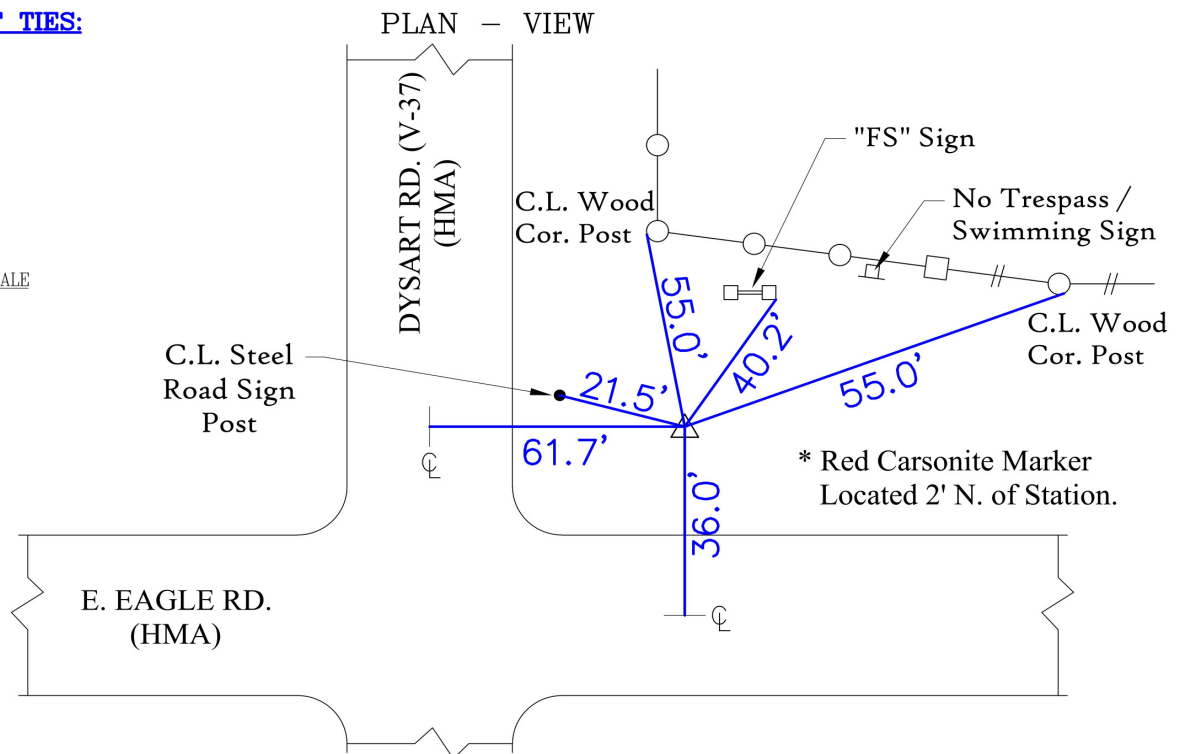
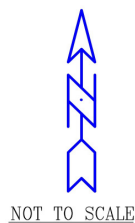
MONUMENT TIES:

BH Co. Updated TIES: C.W. & G.T. Dec. 12, 2006
TIE SOURCE: PRIOR REF. A.S.I. INC., CEDAR FALLS, IA.
FORM PREPARED BY: A.A. & G.T. February 17, 2008

This document was prepared by Dan Corbin, Inc. for Black Hawk County, Iowa.

7043



Facing North

