

Black Hawk County, Iowa**12/01/2020**

Units: US Survey Feet

Point ID: **7036**Stamping on Disk: **94-036**

Type of Monument: *Berntsen 5/8" fluted "Top Security" rod, 6ft long with 2.5" dia. aluminum survey cap, NGS style access cover.*

Physical Details: *Station is flush with ground surface located between TBKS and fence line.*

NAD 83(NA2011) Latitude: **N42°25'43.00823"** Longitude: **W92°20'28.11873"**
NAVD 88 Ortho Height: **933.870sft** Ellip. Ht: **831.411sft** **Geoid18(Conus)**

Horizontal Datum: NAD 83(NA2011) - Vertical Datum: NAVD 1988

Iowa North Zone (1401) Northing: **3621384.751sft** Easting: **5234102.792sft**Mapping Angle: **0°47'07"**Combination Scale Factor: **0.9999142865**

Iowa Regional Coordinate System, Zone 5, Waterloo LCC

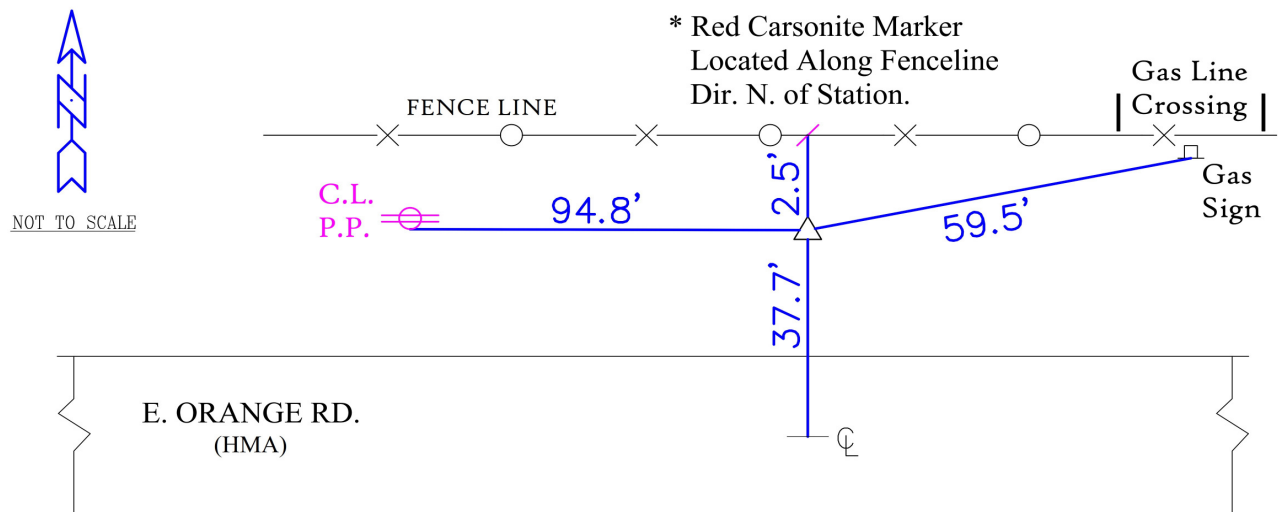
IaRCS Zone 5 Northing: **8819326.725sft** Easting: **15475391.240sft**Mapping Angle: **-0°03'42"**Combination Scale Factor: **0.9999996852****MONUMENT TIES:****PLAN - VIEW**

BH Co. Updated TIES: C.W. & G.T. Dec. 12, 2006
TIE SOURCE: PRIOR REF. A.S.I. INC., CEDAR FALLS, IA.
FORM PREPARED BY: A.A. & G.T. February 15, 2008

This document was prepared by Dan Corbin, Inc. for Black Hawk County, Iowa.

7036



Facing North

