

Black Hawk County, Iowa**12/01/2020**

Units: US Survey Feet

Point ID: **7028**Stamping on Disk: **94-028**

Type of Monument: *Berntsen 5/8" fluted "Top Security" rod, 6ft long with 2.5" dia. aluminum survey cap, NGS style access cover.*

Physical Details: *Station is flush with ground surface located on south edge of grass F.E.*

NAD 83(NA2011) Latitude: **N42°25'42.67380"** Longitude: **W92°22'35.77087"**
NAVD 88 Ortho Height: **948.202sft** Ellip. Ht: **845.525sft** Geoid18(Conus)

Horizontal Datum: NAD 83(NA2011) - Vertical Datum: NAVD 1988

Iowa North Zone (1401) Northing: **3621221.685sft** Easting: **5224531.076sft**
Mapping Angle: **0°45'41"** Combination Scale Factor: **0.9999136186**

Iowa Regional Coordinate System, Zone 5, Waterloo LCC

IaRCS Zone 5 Northing: **8819305.194sft** Easting: **15465817.342sft**
Mapping Angle: **-0°05'09"** Combination Scale Factor: **0.9999990168**

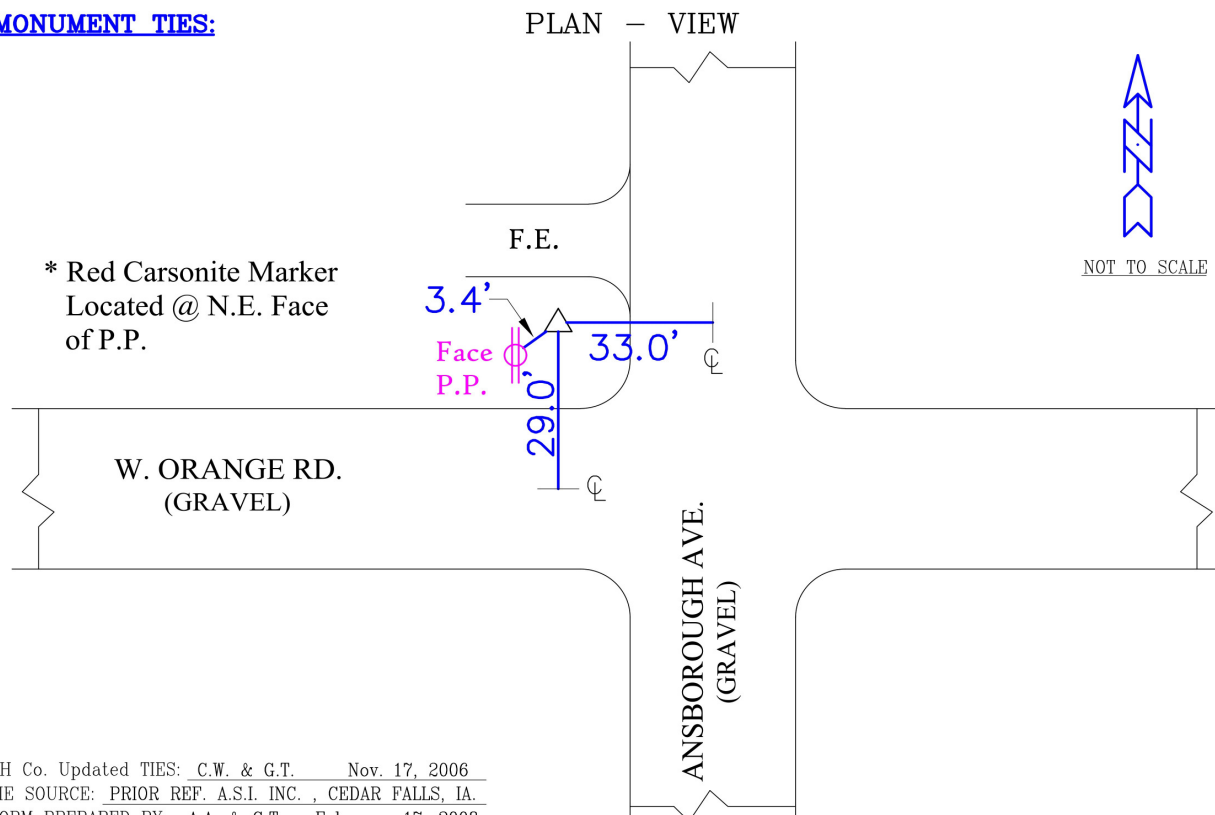
MONUMENT TIES:

This document was prepared by Dan Corbin, Inc. for Black Hawk County, Iowa.

7028



Facing West

