

Black Hawk County, Iowa

Units: US Survey Feet

12/01/2020

Point ID: **7025**Stamping on Disk: **94-025**

Type of Monument: *Berntsen 5/8" fluted "Top Security" rod, 6ft long with 2.5" dia. aluminum survey cap, NGS style access cover.*

Physical Details: *Station is flush with ground surface located in mowed grass between sidewalk and back of curb.*

NAD 83(NA2011) Latitude: **N42°26'36.20093"** Longitude: **W92°23'45.97468"**
NAVD 88 Ortho Height: **914.603sft** Ellip. Ht: **811.771sft** **Geoid18(Conus)**

Horizontal Datum: NAD 83(NA2011) - Vertical Datum: NAVD 1988

Iowa North Zone (1401) Northing: **3626570.358sft** Easting: **5219195.967sft**
Mapping Angle: **0°44'53"** Combination Scale Factor: **0.9999141885**

Iowa Regional Coordinate System, Zone 5, Waterloo LCC

IaRCS Zone 5 Northing: **8824732.626sft** Easting: **15460561.447sft**
Mapping Angle: **-0°05'56"** Combination Scale Factor: **0.9999996661**

MONUMENT TIES:

- * Red Carsonite Marker
Located N.W. of Station
@ P.P. Guy Wire Base.

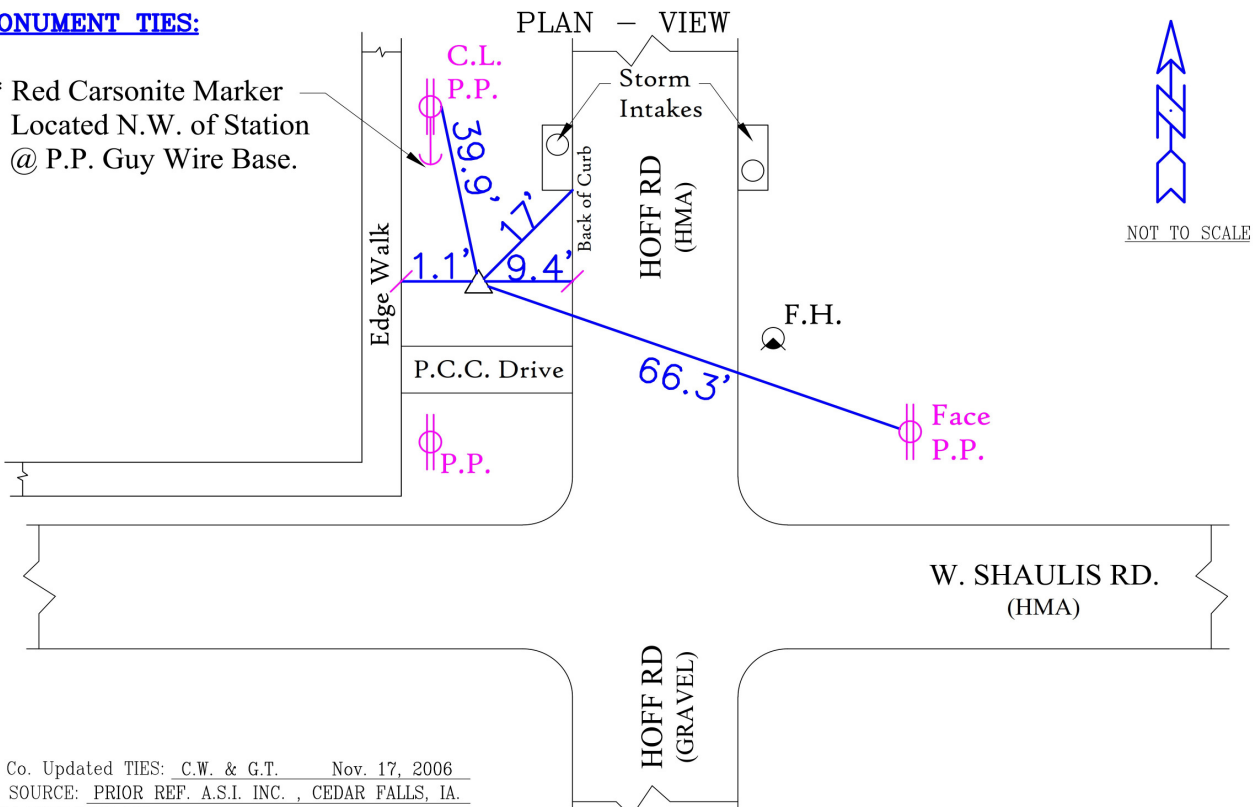

BH Co. Updated TIES: C.W. & G.T. Nov. 17, 2006
TIE SOURCE: PRIOR REF. A.S.I. INC., CEDAR FALLS, IA.
FORM PREPARED BY: A.A. & G.T. February 17, 2008

This document was prepared by Dan Corbin, Inc. for Black Hawk County, Iowa.

7025



Facing South

